



Models- **35000-3A & 35000-303A Dust Collector**
 35000-402A Primary Separator

| | |
|-----------|-------------------------------|
| Page 2 | Product Information |
| Page 3 | Specifications |
| Page 4 | Important Safety Instructions |
| Page 5 | Product Dimensions |
| Page 6-7 | Installation |
| Page 8 | Maintenance |
| Page 9-11 | Parts List |



PRODUCT INFORMATION

Please take a moment to fill out the information below in order to aid us with any future sales or service inquiries. Model number and serial number information can be found on the serial tag located inside the control box and/or on the lower exterior of the can. Key number can be found on the tag that comes attached to the keys. There may be more than one key number depending on unit.

Please keep this information with your records.

MODEL#:_____

SERIAL#:_____

KEY NUMBER(S):_____

DATE PURCHASED:_____

DISTRIBUTOR:_____

**J.E. Adams Industries
1025 63rd Ave. S.W.
Cedar Rapids, IA 52404
1-800-553-8861
www.jeadams.com**

Specifications

Unit features:

- Stainless steel construction.
- 6" inlet model (30" diameter)supports up to 16 vacuum drops.
- 8" inlet model (36" diameter) supports up to 24 vacuum drops.
- Primary separator model (30" diameter) available in 6" inlet only.
- High quality filter bags (99% @ 3 micron), dust collector models only.
- Adjustable door latches to insure good seal.
- 20 gallon removable dust can in 16 hose model.
- 28 gallon removable dust can in 24 hose model.



IMPORTANT SAFETY INSTRUCTIONS

READ ALL INSTRUCTIONS BEFORE USING (THIS APPLIANCE)

WARNING – To reduce the risk of fire, electric shock, or injury:



- Do not use on wet surfaces.
- Use only as described in manual. Use only manufactures recommended attachments.
- Do not allow to be used as a toy. Close attention is necessary when used by or near children.
- Do not put any object into openings. Do not use with any opening blocked; keep free of dust, lint, hair and anything that may reduce air flow.
- Keep hair, loose clothing, fingers, and all parts of body away from openings and moving parts.
- **Do not use to pick up flammable or combustible liquids, such as gasoline, or use in areas where they may be present.**
- **Do not pick up anything that is burning or smoking, such as cigarettes, matches, or hot ashes.**
- **Do not use without dust bag and/or filters in place.**

SAVE THESE INSTRUCTIONS

- **Installation Instructions:**
- Determine location to mount unit (“**DANGER**” “**THIS EQUIPMENT INCORPORATES PARTS SUCH AS SWITCHES, MOTORS, OR THE LIKE THAT TEND TO PRODUCE ARCS OR SPARKS THAT CAN CAUSE AN EXPLOSION. WHEN LOCATED IN GASOLINE-DISPENSING AND SERVICE STATIONS INSTALL AND USE AT LEAST 20 FEET (6 M) HORIZONTALLY FROM THE EXTERIOR ENCLOSURE OF ANY DISPENSING PUMP AND AT LEAST 18 INCHES (450 MM) ABOVE A DRIVEWAY OR GROUND LEVEL.**”
- **Grounding Instructions:** This appliance must be connected to a grounded metal, permanent wiring system; or an equipment-grounding conductor must be run with the circuit conductors and connected to the equipment-grounding terminal or lead on the appliance.
- All local and national electric codes must be followed for installation and use.

Dimensions

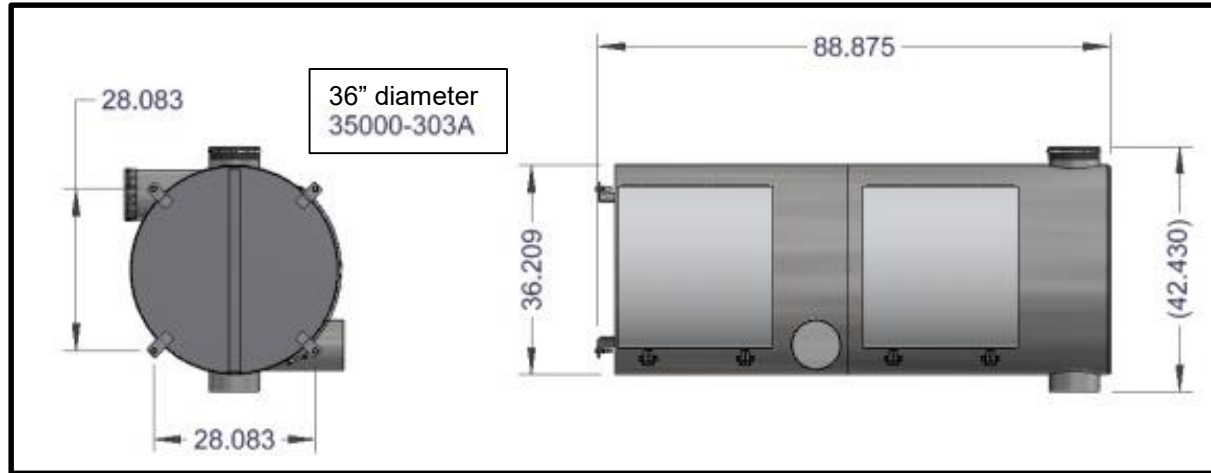

Mounting patterns -- Use minimum 1/2" diameter concrete studs for mount.

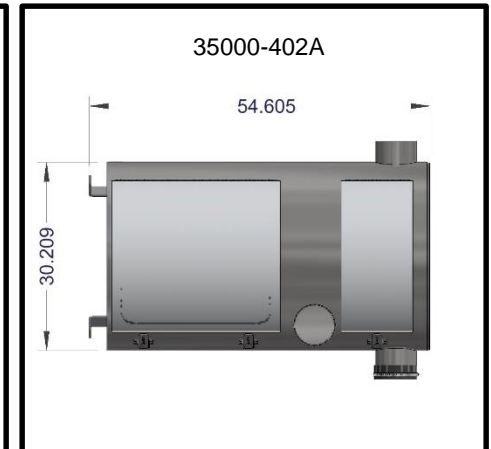
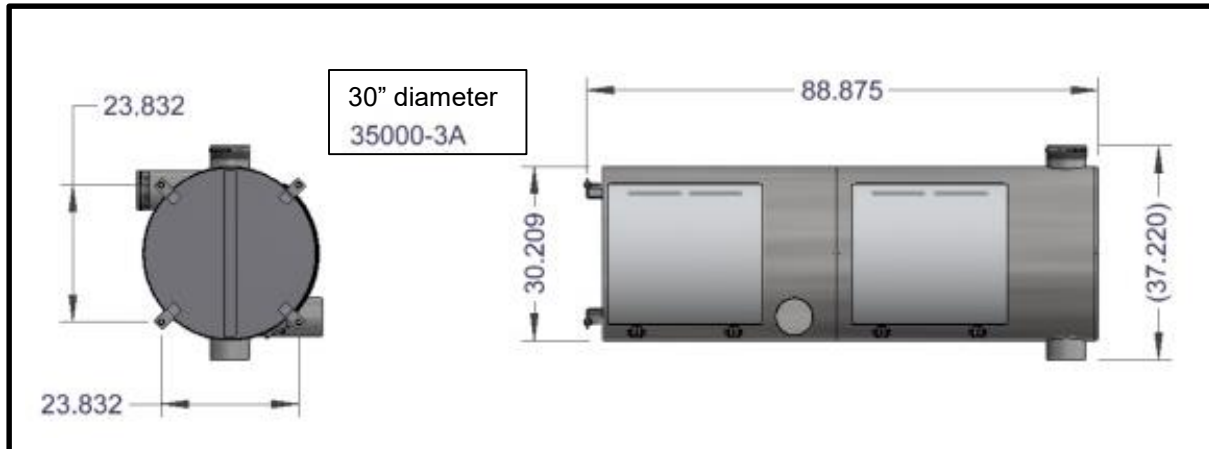

Installation

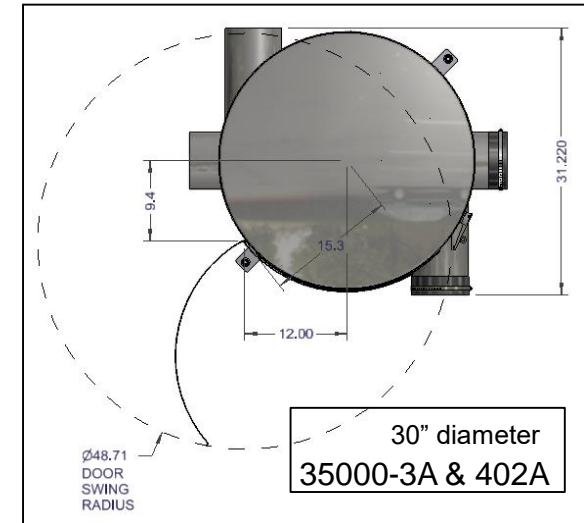
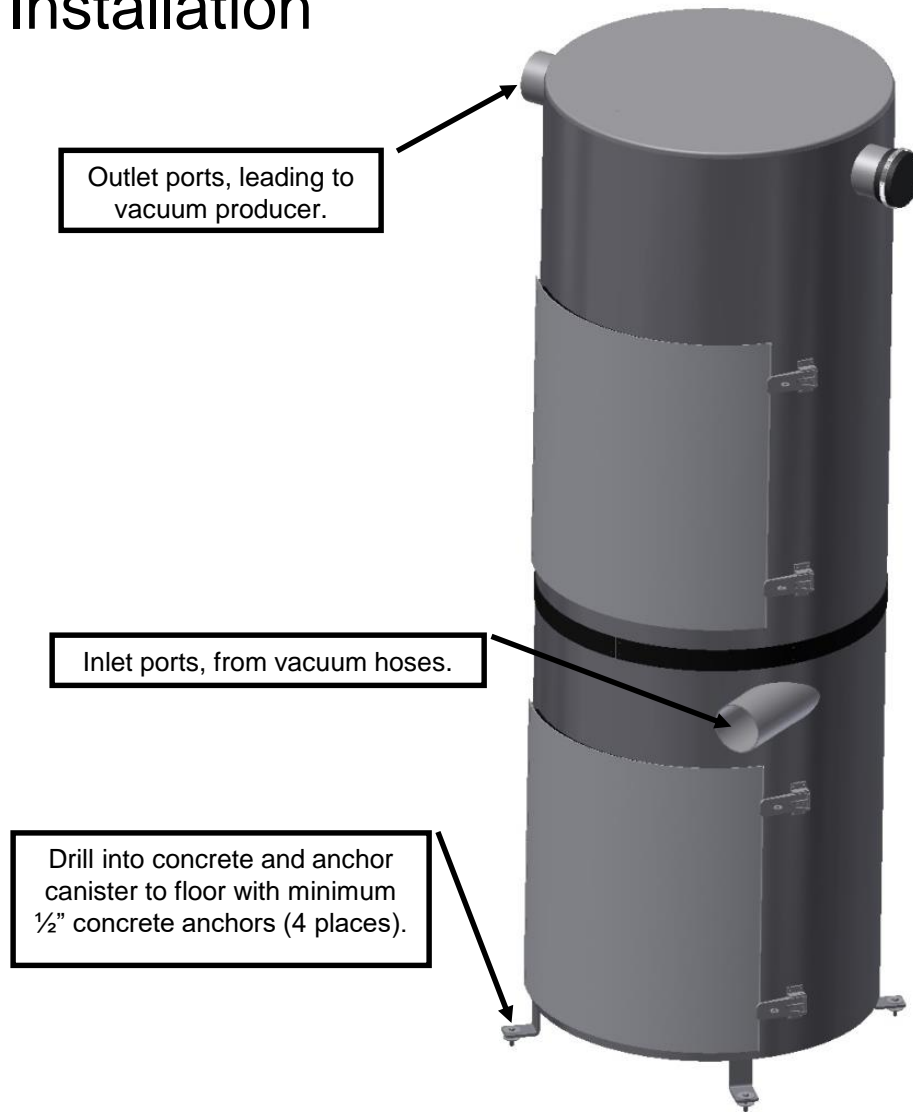

TOP VIEW SHOWING DOOR SWING AND NEEDED CLEARANCE FROM OTHER OBJECTS.

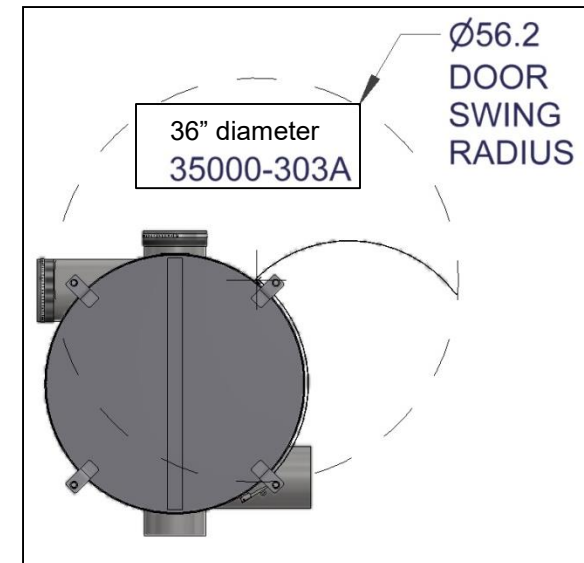

Installation (typical example):

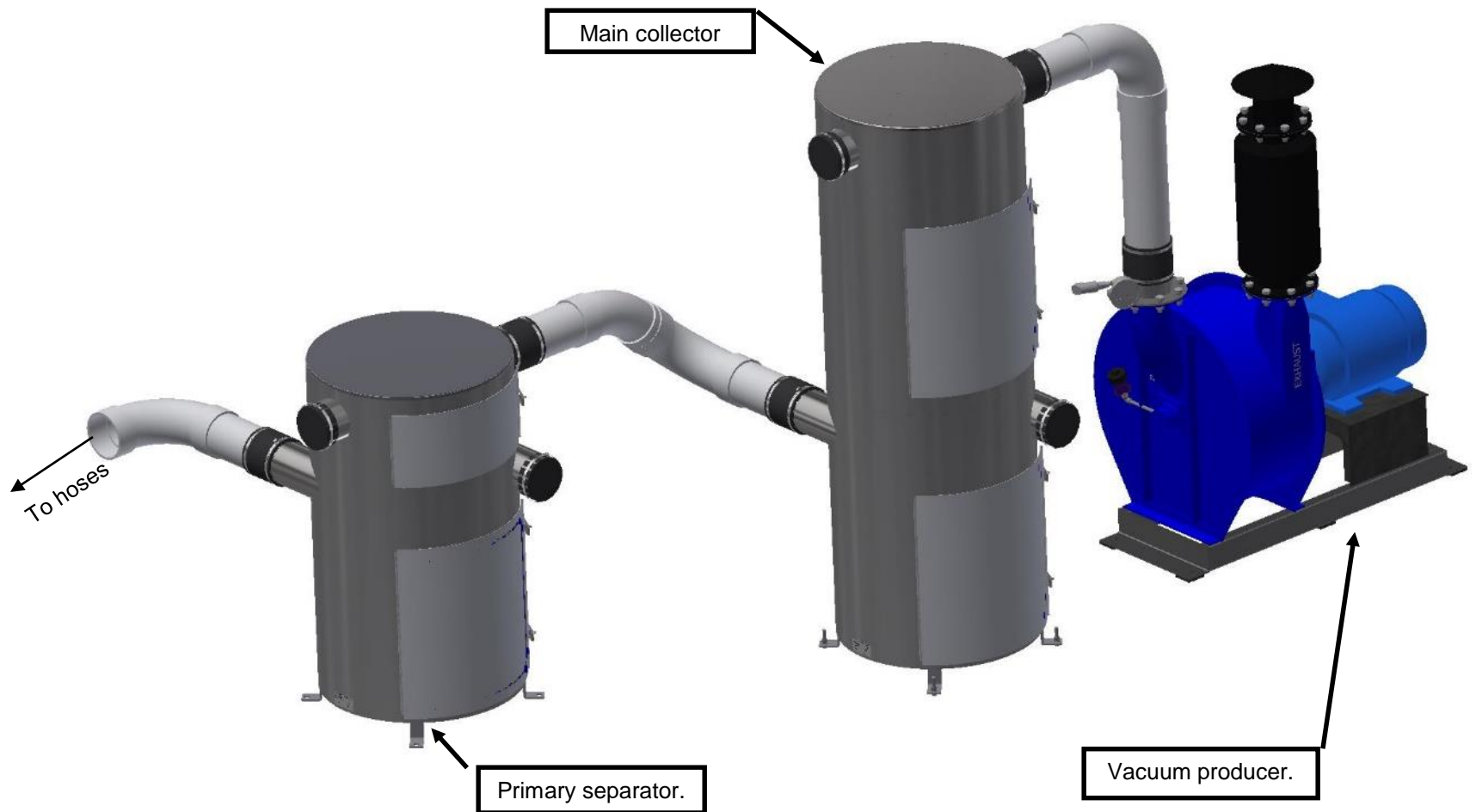

Maintenance

- From the lower chamber of the collector, empty trash bin as needed. Never let the dirt become backed up into the filter bags.
- Every time the trash bin is emptied, open upper chamber of collector and shake dust from ALL vacuum bags allowing dirt to fall into lower chamber. (Tip: use a shortened broom handle).
- Replace vacuum bags immediately if they become torn or tattered.
- Inspect door gaskets in upper and lower chamber. Replace if damaged or worn. Failure to keep a tight door seal can result in damage to vacuum producer.
- Adjust tension on door hinges when necessary.
- Once a month wipe down outside of stainless steel with polish or cleaner.

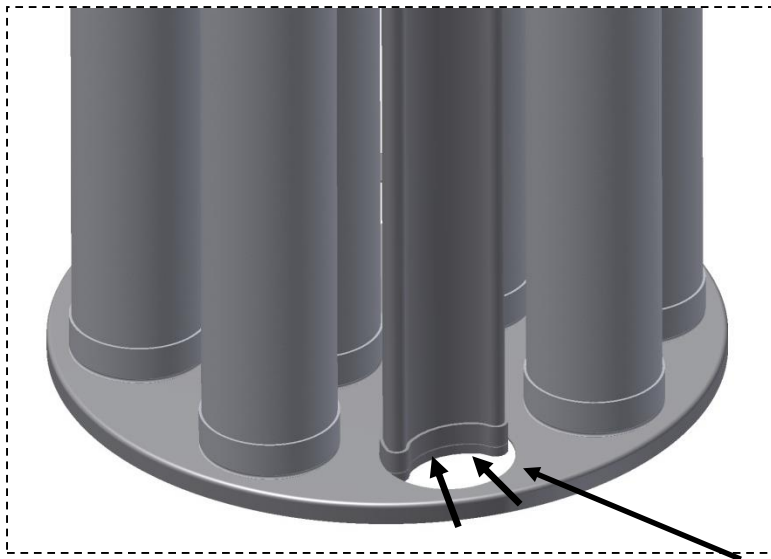

To remove bag(s), firmly depress bag ring with both thumbs and lift up and out. Be very careful not to let ring snap back on fingers!!

PART NO.
35000-3A

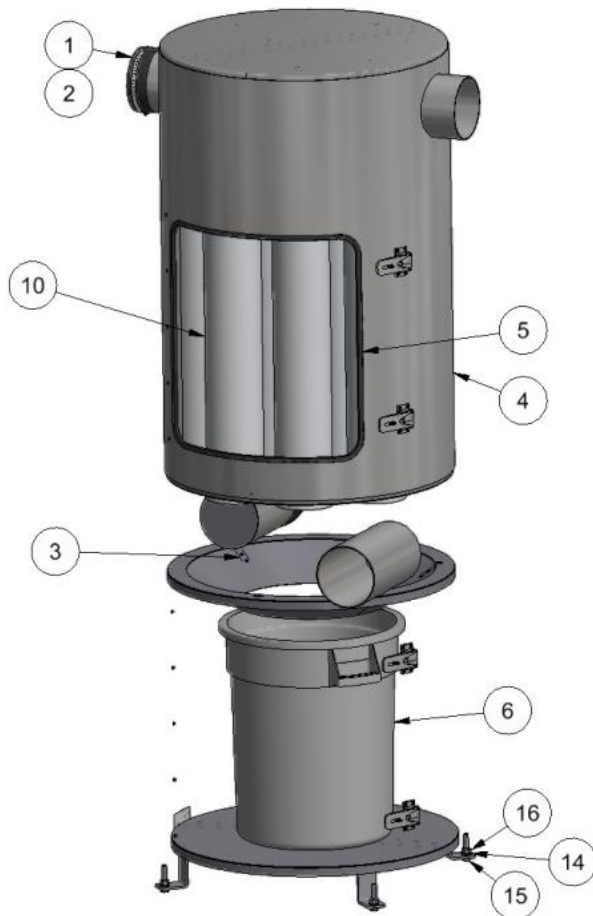

6" inlet can

BILL OF MATERIALS

| ITEM | PART NUMBER | DESCRIPTION | QTY |
|------|-------------|--------------------------------|------|
| 1 | 35000-108 | PIPE CAP, RUBBER 6" | 2 |
| 2 | 35000-109 | 6" PIPE END PLATE, SS | 2 |
| 3 | 35000-26W | DIRT FUNNEL WELDMENT | 1 |
| 4 | 35000-3W | MAIN COLLECTOR WELDMENT 6" | 1 |
| 5 | 35000-68 | DOOR GASKET, CENTRAL VAC | 182" |
| 6 | 35000-90 | TRASH CAN, 20 GAL, 19.5 X 22.5 | 1 |
| 7 | 5603D1 | #10 NYLOCK NUT | 1 |
| 8 | 5647D8 | RIVET SS 3/16" | 26 |
| 9 | 5720D1 | #10-24 X .75 PHIL PAN SS | 1 |
| 10 | 8077 | FILTER BAG, CENTRAL VAC | 10 |
| 11 | 8732 | NAMEPLATE SERIAL TAG, UL | 1 |
| 12 | 32010-E | 55 X 48 PALLET | 1 |
| 13 | 35000-191 | OSB, 48 X 48 X 3/4 | 1 |
| 14 | 5606D10 | WASHER, FLAT 1/2 SAE | 8 |
| 15 | 5646D4 | BOLT, 1/2-13 X 2.5",HH, HD, SS | 4 |
| 16 | 5603D11 | 1/2 Std NF Nylock Nut | 4 |

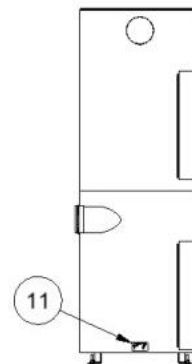

NOTES:
SCREW OSB BOARD
TO PALLET TOP, DRILL
OSB TO MATCH
COLLECTOR FOOT-
PRINT AND FASTEN.

| REV | NO. | DESCRIPTION | DATE | BY |
|-----|------|---------------------------------|---------|-----|
| B | 7383 | ADD PALLET/PACKAGING INFO | 012615 | JF |
| A | 7325 | MOVED DOORS/LATCHES TO SUB ASSY | 9/18/14 | MWS |
| REV | NO. | DESCRIPTION | DATE | BY |

THIS DOCUMENT SHALL NOT BE REPRODUCED NOR SHALL THE INFORMATION THEREIN BE USED BY OR DISCLOSED TO OTHERS EXCEPT AS AUTHORIZED BY J.E. ADAMS INDUSTRIES

| CENTRAL VAC COLLECTOR/SEPARATOR 6" | | | |
|------------------------------------|----------|--------------------|------------|
| UNSPECIFIED TOLERANCES | DATE | Cedar Rapids, Iowa | |
| 1 PL ± .030 | DRAWN BY | JOHN F | |
| 2 PL ± .020 | DATE | 11/20/2013 | |
| 3 PL ± .003 | SCALE | SHEET | REV |
| ANGLE ± 1° | | 1 / 2 | 35000-3A B |

PART NO.
35000-303A

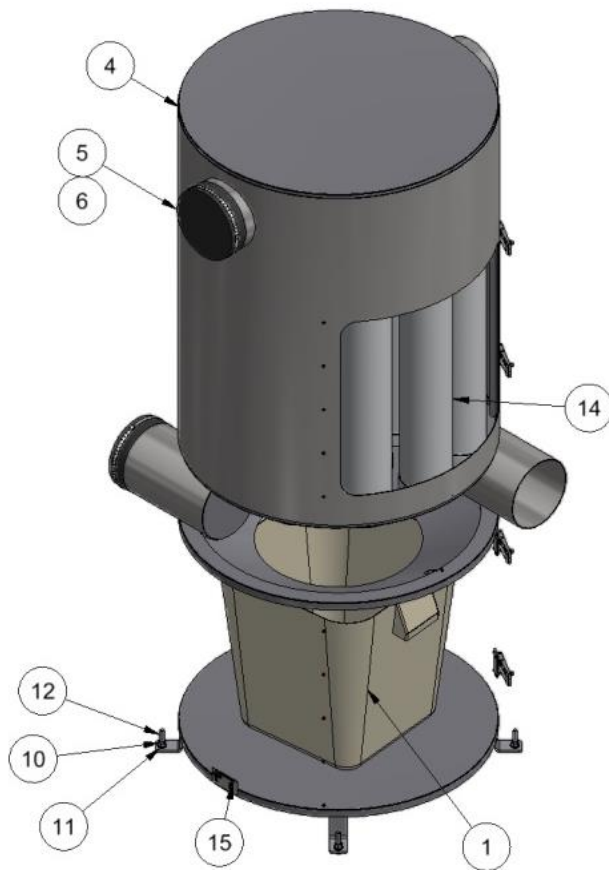

8" inlet can

BILL OF MATERIALS

| ITEM | PART NUMBER | DESCRIPTION | QTY |
|------|-------------|--|------|
| 1 | 32000-50 | TRASHCAN, 28 GAL RUBBERMAID | 1 |
| 2 | 32010-E | 55 X 48 PALLET | 1 |
| 3 | 35000-191 | OSB, 48 X 48 X 3/4 | 1 |
| 4 | 35000-303W | 36" MAIN COLLECTOR WELDMENT 8" INLETS | 1 |
| 5 | 35000-308 | PIPE CAP, RUBBER 8" | 2 |
| 6 | 35000-309 | 8" PIPE END PLATE, SS | 2 |
| 7 | 35000-326W | 36" DIRT FUNNEL WELDMENT | 1 |
| 8 | 35000-68 | DOOR GASKET, CENTRAL VAC | 202" |
| 9 | 5603D1 | 10-24 Std NC Nylock Nut | 1 |
| 10 | 5603D11 | 1/2 Std NF Nylock Nut | 4 |
| 11 | 5606D10 | WASHER, FLAT 1/2 SAE | 8 |
| 12 | 5646D4 | BOLT, 1/2-13 X 2.5",HH, HD, SS | 4 |
| 13 | 5720D1 | #10-24 x .75 PHIL PAN SS | 1 |
| 14 | 8077 | FILTER BAG, CENTRAL VAC | 15 |
| 15 | 8732 | NAMEPLATE SERIAL TAG, UL | 1 |
| 21 | 35000-366W | DOOR WELDMENT, 36" COLLECTOR CENTRAL VAC | 1 |

NOTES:
SCREW OSB BOARD TO PALLET TOP,
DRILL OSB TO MATCH COLLECTOR FOOT-
PRINT AND FASTEN.
LIMIT: 24 DROP MAXIMUM

| TITLE | | | |
|-------------------------------------|----------|--------------------|------------|
| CENTRAL VAC 36" COLLECTOR, 8" INLET | | | |
| UNSPECIFIED TOLERANCES | MATERIAL | CEDAR RAPIDS, IOWA | |
| 1 PL ±.030 | DRAWN BY | JOHN F | |
| 2 PL ±.020 | DATE | 6/28/2018 | |
| 3 PL ±.003 | SCALE | SHEET | PART NO. |
| ANGLE ±1° | | 1 / 2 | 35000-303A |

| | | | | |
|-----|------|-------------|----------|-----|
| - | 8304 | RELEASED | 08/02/18 | JRF |
| REV | NO. | DESCRIPTION | DATE | BY |

THIS DOCUMENT SHALL NOT BE REPRODUCED NOR SHALL THE INFORMATION THEREIN BE USED BY OR DISCLOSED TO OTHERS EXCEPT AS AUTHORIZED BY J.E. ADAMS INDUSTRIES

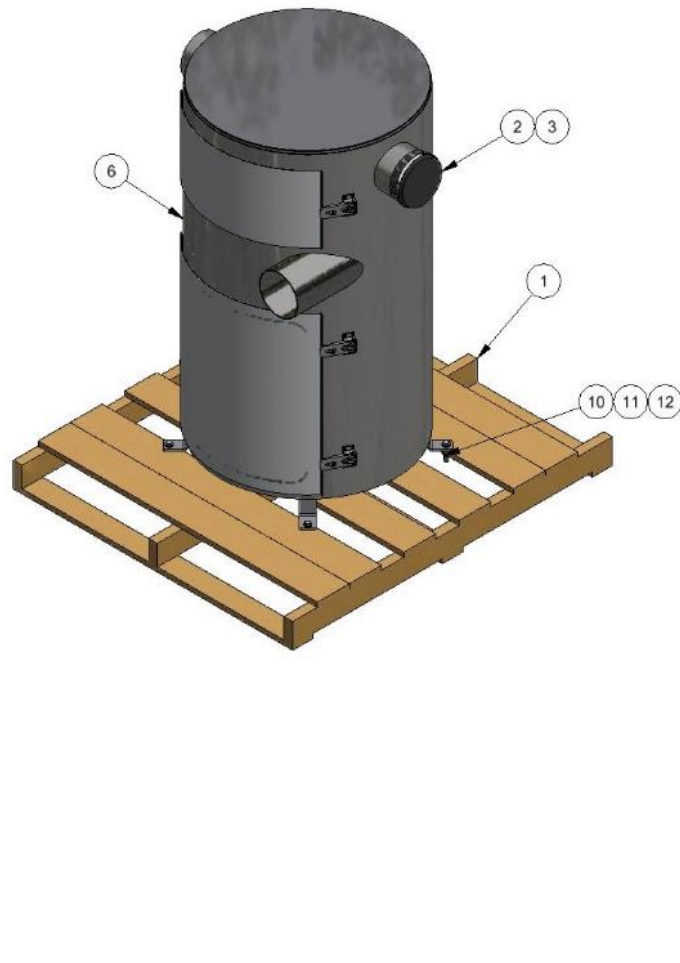

| BILL OF MATERIALS | | | |
|-------------------|-------------|--------------------------------|------|
| ITEM | PART NUMBER | DESCRIPTION | QTY |
| 1 | 32010-E | PALLET- VAC ISLAND MODULE | 1 |
| 2 | 35000-108 | PIPE CAP, RUBBER 6" | 2 |
| 3 | 35000-109 | 6" PIPE END PLATE, SS | 2 |
| 4 | 35000-191 | OSB, 48 X 48 X 3/4 | 1 |
| 5 | 35000-26W | DIRT FUNNEL WELDMENT | 1 |
| 6 | 35000-402W | PRIMARY SEPARATOR WELDMENT | 1 |
| 7 | 35000-68 | DOOR GASKET, CENTRAL VAC | 151" |
| 8 | 35000-90 | TRASH CAN, 20 GAL, 19.5 X 22.5 | 1 |
| 9 | 5603D1 | NUT #10-24, NYLOCK, SS | 1 |
| 10 | 5603D11 | 1/2 Std NF Nylock Nut | 4 |
| 11 | 5606D10 | WASHER, FLAT 1/2 SAE | 8 |
| 12 | 5646D4 | BOLT, 1/2-13 X 2.5",HH, HD, SS | 4 |
| 13 | 5720D1 | #10-24 x .75 PHIL PAN SS | 1 |
| 14 | 8732 | NAMEPLATE SERIAL TAG, UL | 1 |



Primary Separator

| | | | | | | | | |
|---|------|-------------|----------|-----|-------|-------|------------|------|
| REV | NO. | DESCRIPTION | DATE | BY | SCALE | SHEET | PART NO. | REV. |
| - | 8739 | RELEASED | 05/06/21 | JRF | 1/20 | 1/2 | 35000-402A | - |
| THIS DOCUMENT SHALL NOT BE REPRODUCED NOR SHALL THE INFORMATION THEREIN BE USED BY OR DISCLOSED TO OTHERS EXCEPT AS AUTHORIZED BY J.E. ADAMS INDUSTRIES | | | | | | | | |

| | | | | | | | |
|------------------------|--|--|--|----------------------------|--|--|--|
| TITLE | | | | PRIMARY SEPARATOR, 54 X 30 | | | |
| UNSPECIFIED TOLERANCES | | | | CEDAR RAPIDS, IOWA | | | |
| 1 PL ± .030 | | | | DRAWN BY JOHN F | | | |
| 2 PL ± .020 | | | | DATE 6/12/2020 | | | |
| 3 PL ± .003 | | | | J.E. ADAMS INDUSTRIES LTD | | | |
| ANGLE ± 1° | | | | PART NO. 35000-402A | | | |