

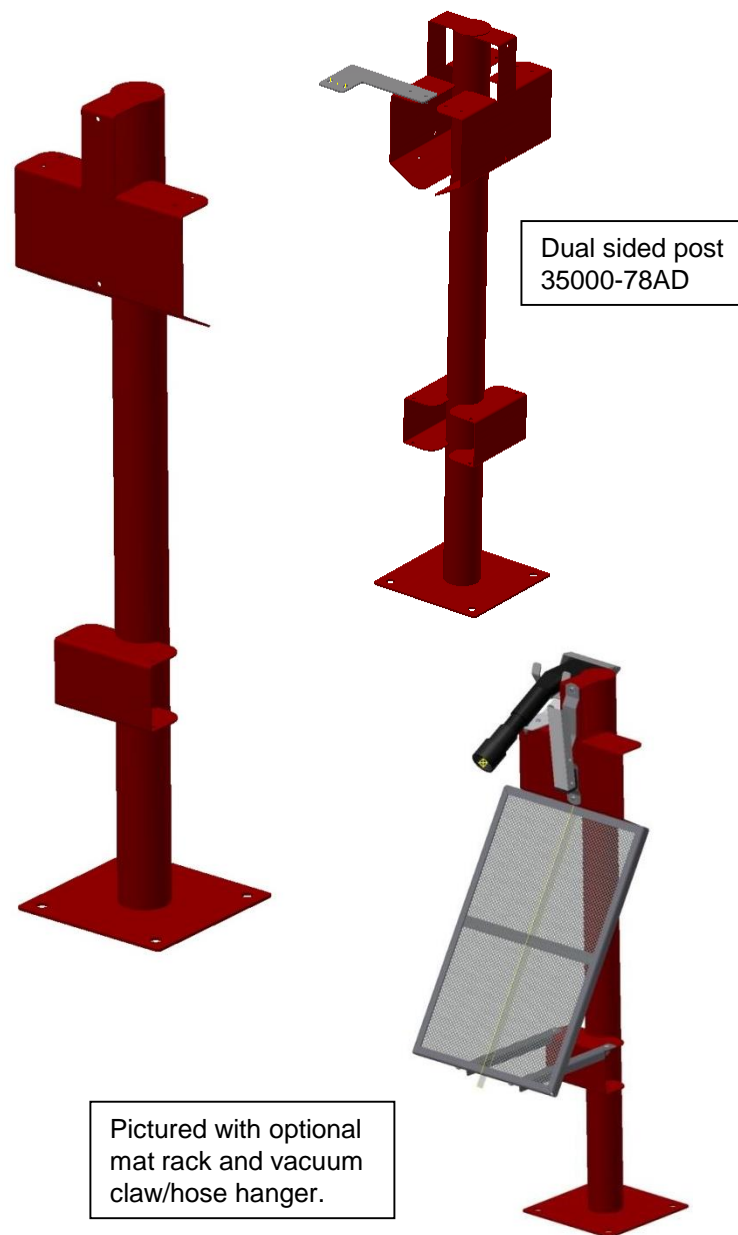

Models- **35000-78A, 35000-78AD**

Page 2	Product Information
Page 3	Specifications
Page 4,5	Product Dimensions
Page 6-9	Installation Instructions
Page 8	Maintenance
Page 11-17	Parts



PRODUCT INFORMATION

Please take a moment to fill out the information below in order to aid us with any future sales or service inquiries. Model number and serial number information can be found on the serial tag located inside the control box and/or on the lower exterior of the can. Key number can be found on the tag that comes attached to the keys. There may be more than one key number depending on unit.

Please keep this information with your records.

MODEL#:_____

SERIAL#:_____

KEY NUMBER(S):_____

DATE PURCHASED:_____

DISTRIBUTOR:_____

**J.E. Adams Industries
1025 63rd Ave. S.W.
Cedar Rapids, IA 52404
1-800-553-8861
www.jeadams.com**

Specifications

Unit features:

- Posts are typically used on dual arch systems configured in a V-formation (pictured below).
- Posts have commercial grade powder coat with zinc rich primer.
- Optional stainless steel construction available.
- Bolt on options available include mat rack kit, trash module and crevice or claw tool holder.
- Available in a dual sided configuration so some options can be mounted on both sides.

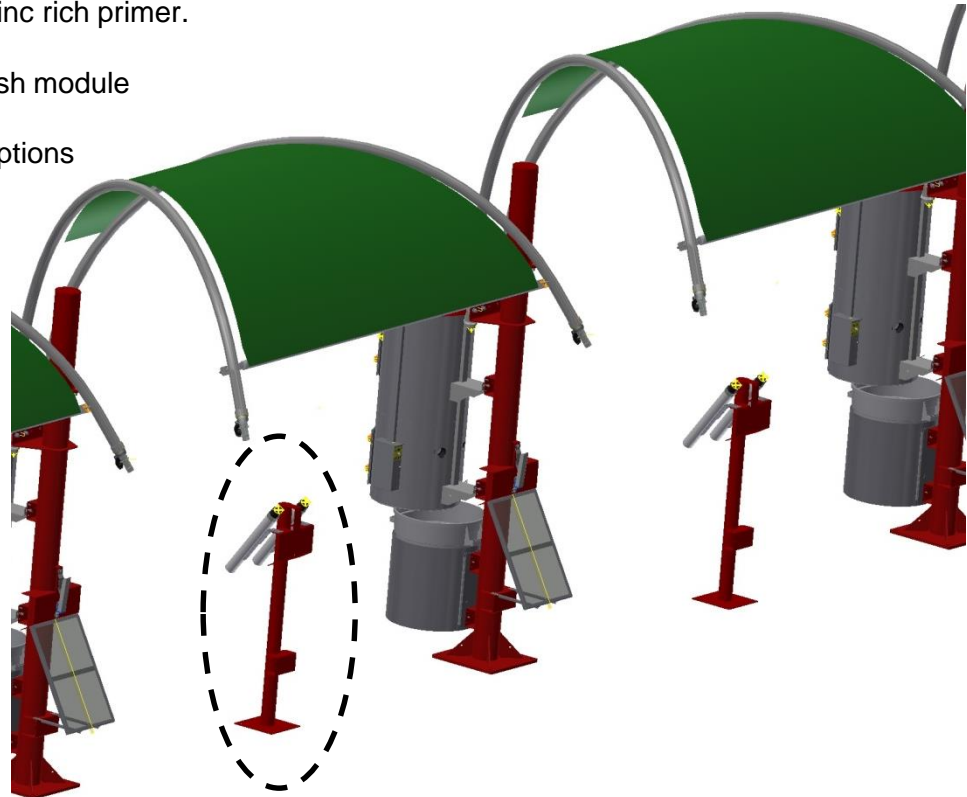

Typical installation example. **Note:** One hose hanger post can be shared between each stanchion unless spacing stanchions wider than 14 feet. 14 feet or greater spacing does not allow sharing of hose hanger posts and additional posts will need to be purchased for each arch/hose.

35000-78A Dimensions

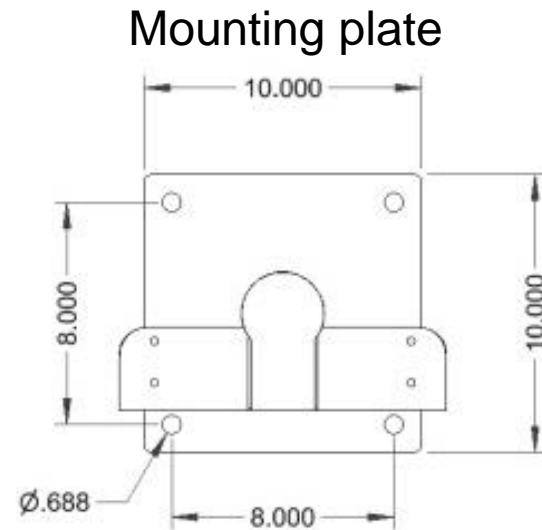
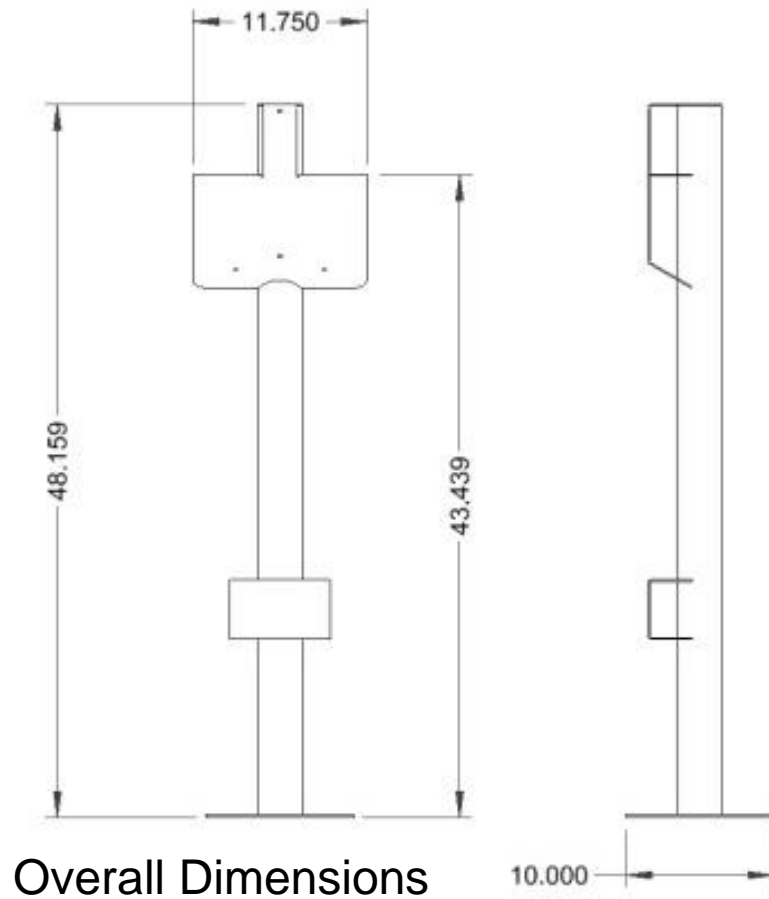

Use minimum 3/8" diameter concrete studs for mount.

35000-78AD Dimensions

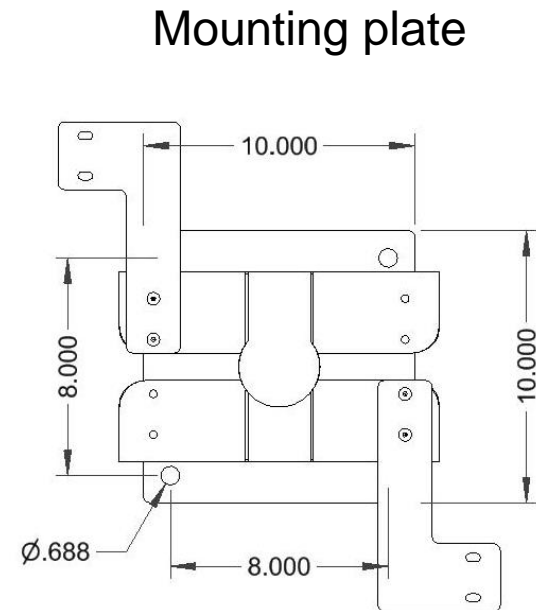
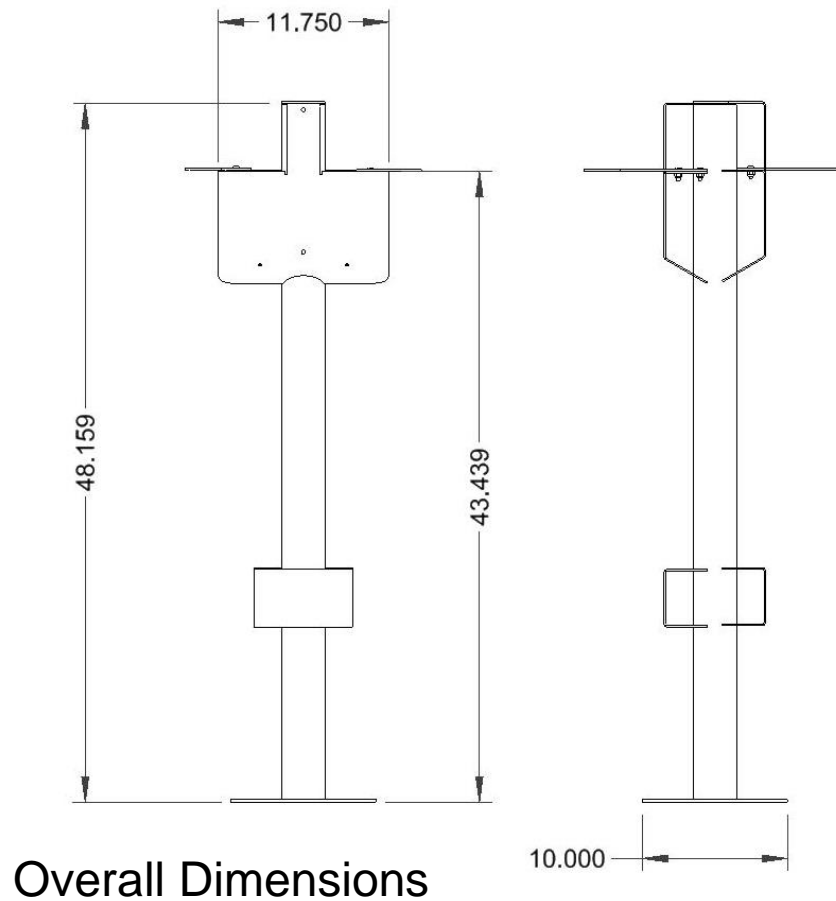

Use minimum 3/8" diameter concrete studs for mount.

Installation

STEP 1 – Mount post to solid concrete pad. Use minimum 3/8" diameter hardware with flat washers. Space posts evenly between main stanchions.

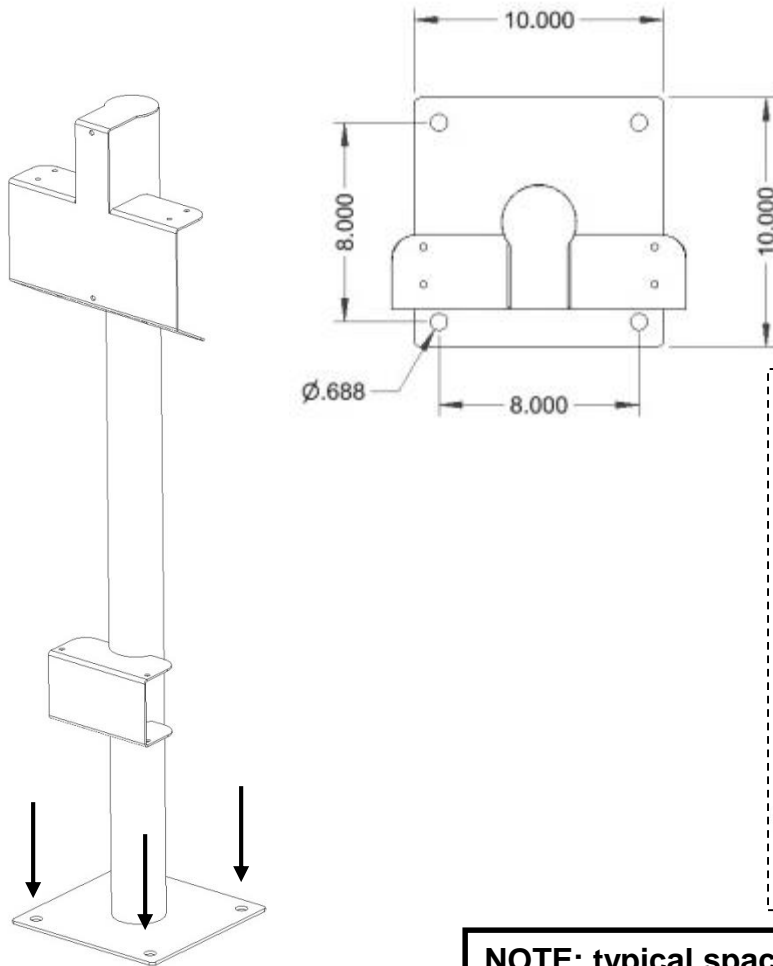

Multiple post installation,
Birds eye view

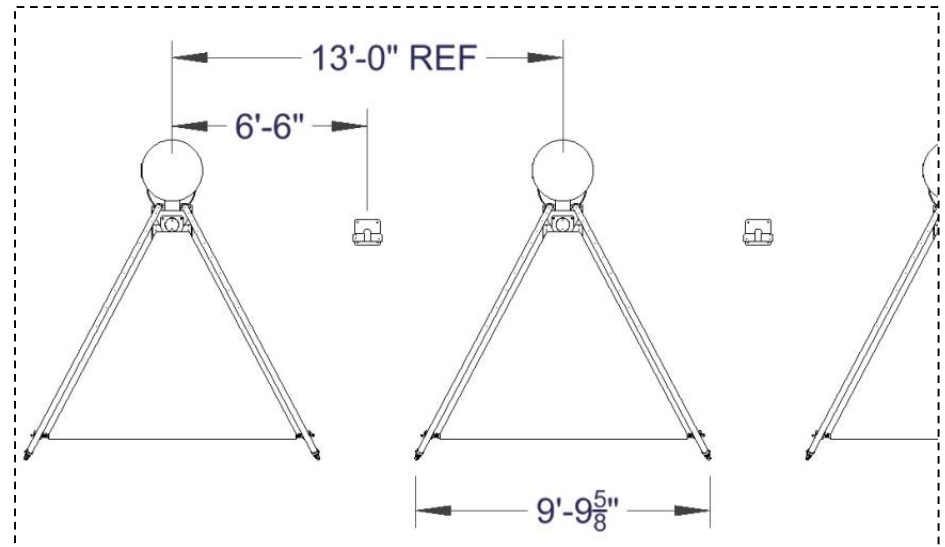

NOTE: typical spacing between stanchions varies from 11 feet to 14 feet in normal applications (13 feet example is pictured). If wanting greater than 14 feet spacing, sharing of posts between stanchions is discouraged and additional posts should be purchased.

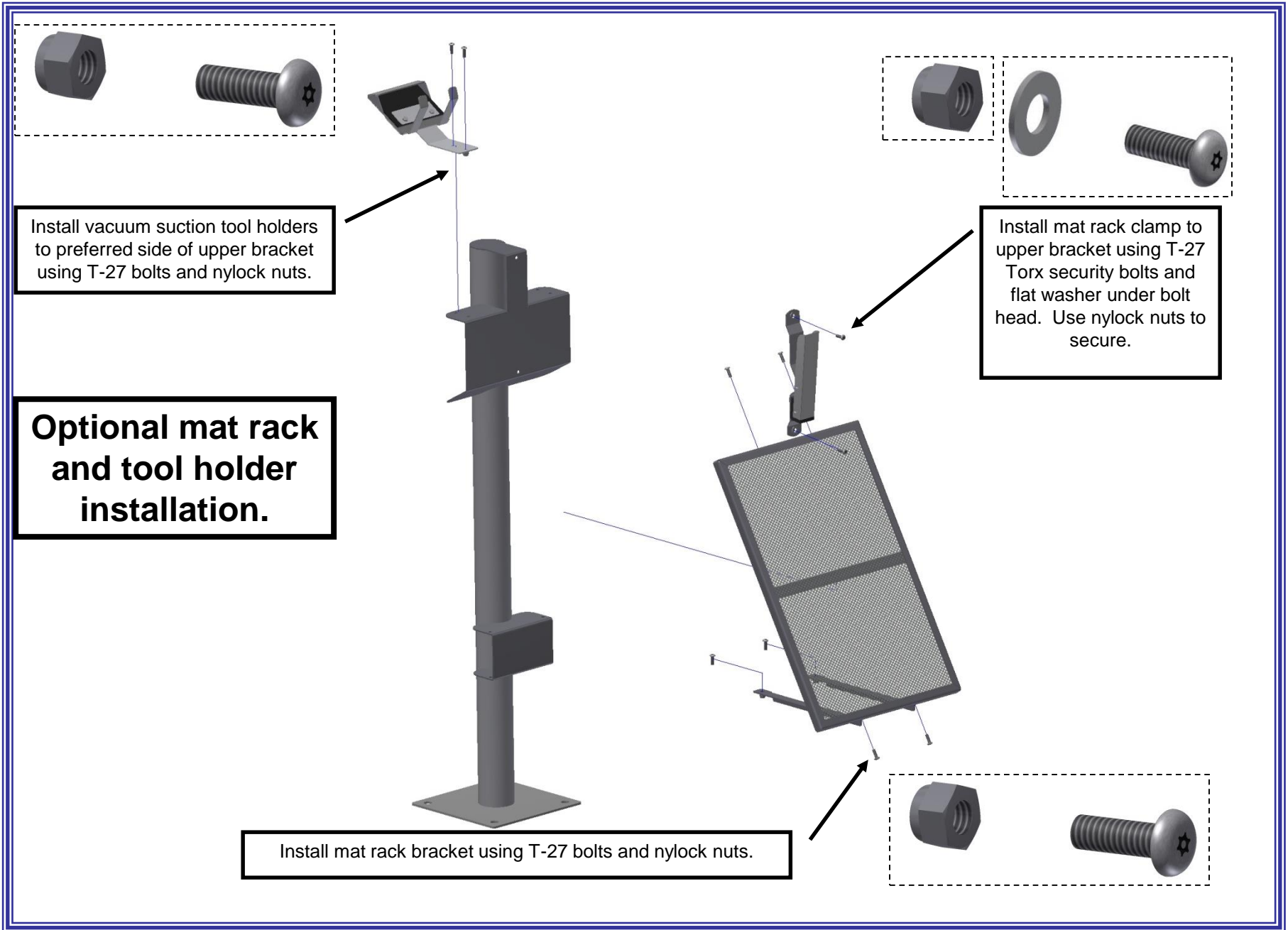

Optional trash module installation.

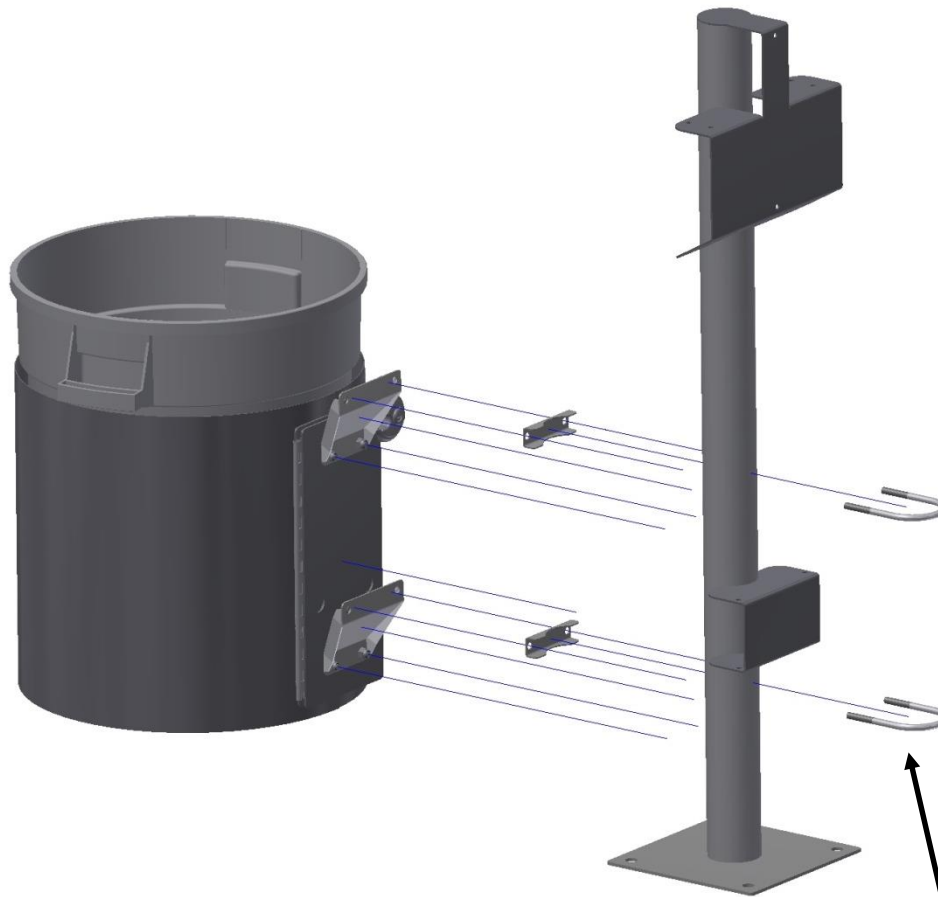

Install swinging trash can module to post using provided U-bolts. Insert trash can into module and secure with Abus style lock.

Optional Towel Dispenser Installation.

Mount Towel Dispenser on underside of angled portion of top bracket as shown. Towel dispenser bottom bracket will rest on top of lower bracket.

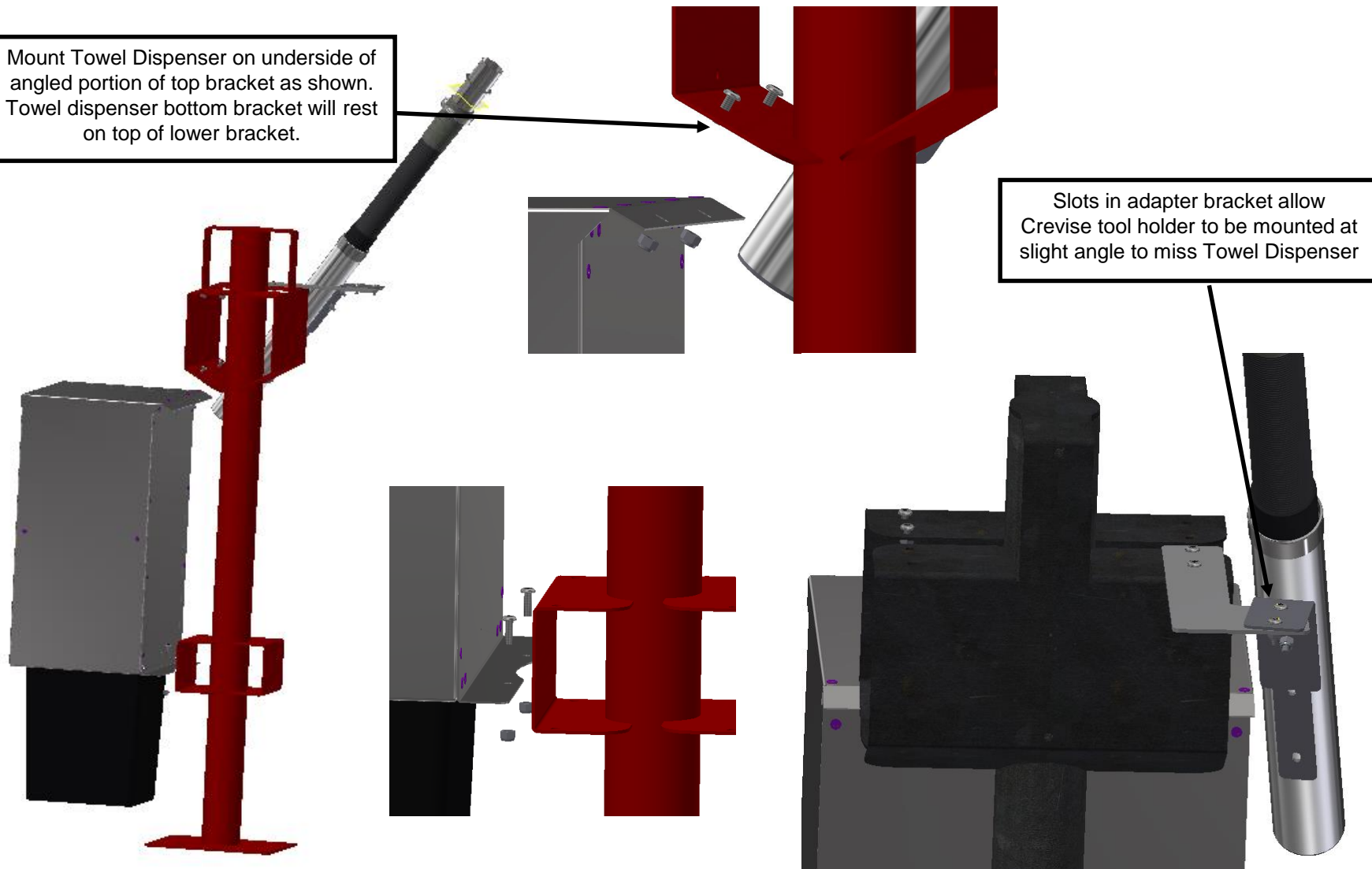

Maintenance:

- Rubber pads on hose hangers should be checked once a week or as needed to make sure there is a good seal against the vacuum claw.
- Vacuum hose and vacuum claw (or crevice tool) should be inspected for wear once a week or as needed.
- Nuts and bolts on structure should be checked and tightened once a month or as needed.
- Powder coated parts will eventually wear over time. JE Adams offers touch up paint to keep your parts looking great.
- Stainless steel parts should be wiped/ cleaned as needed.

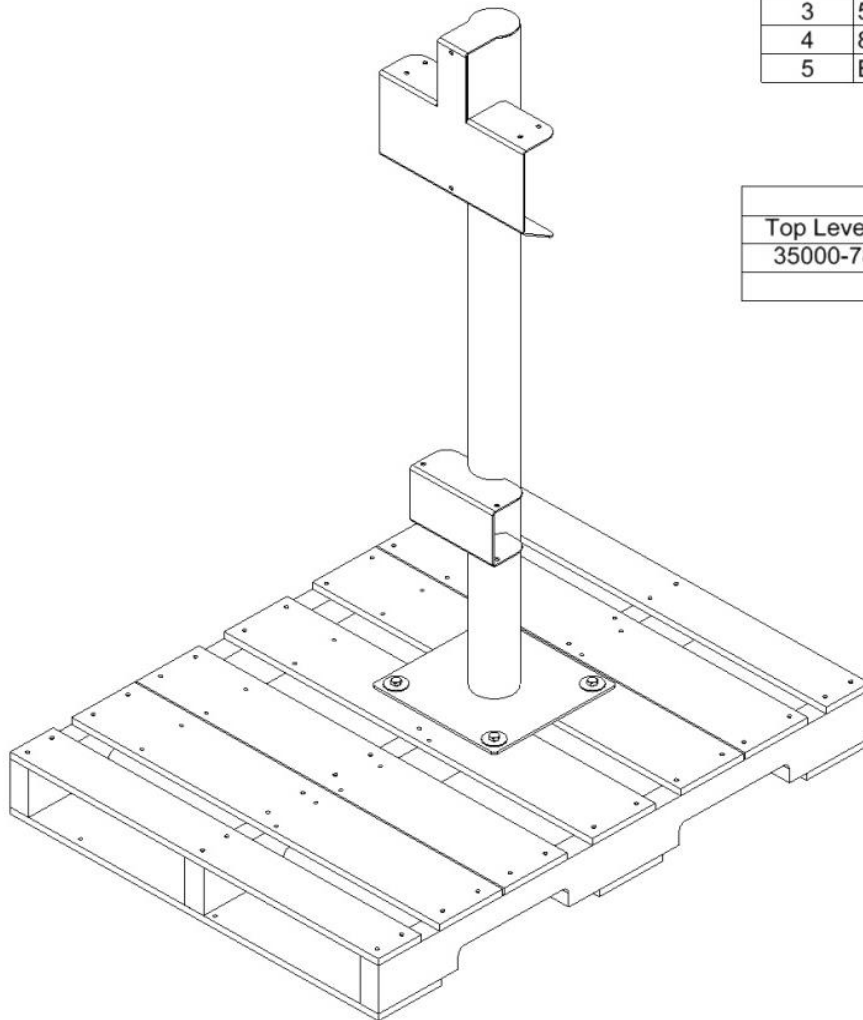

BILL OF MATERIALS

ITEM	PART NUMBER	DESCRIPTION	QTY
1	35000-78W-P *	HOSE HANGER COLUMN, PAINTED	1
2	5600D4	3/8-16 X 1.5 HHCS	4
3	5606D22	WASHER, 3/8 FENDER	8
4	8939	PALLET, DUAL, OVAL, SPECIALITY, 30" X 40"	1
5	B5722-002	NUT, 3/8-16 UNC HEX LOCK NUT	4

* Suffix Part # List

Top Level Part	Item #	PART #	Red	Blue	Yello	Green	Custom
35000-78A-			RED	BLU	YEL	GRN	CU
	1	35000-78W-P	R	B	Y	G	CU

POST OPTIONS:

35000-40A - MAT RACK ASSEMBLY

35000-30-4A - HOSE/CREVICE TOOL ASSEMBLY

2058-13A-1 - HOSE/CLAW HANGER ASSEMBLY

REV	NO.	DESCRIPTION	DATE	BY
THIS DOCUMENT SHALL NOT BE REPRODUCED NOR SHALL THE INFORMATION THEREIN BE USED BY OR DISCLOSED TO OTHERS EXCEPT AS AUTHORIZED BY J.E. ADAMS INDUSTRIES				

TITLE HOSE HANGER ASSY		MATERIAL		CEDAR RAPIDS, IOWA	
UNSPECIFIED TOLERANCES		DRAWN BY JOHN F			
1 PL ±.030		DATE 7/12/2012			
2 PL ±.020		SCALE 1 / 2			
3 PL ±.003		SHEET 1 / 2		REV: 35000-78A	
ANGLE ± 1°					

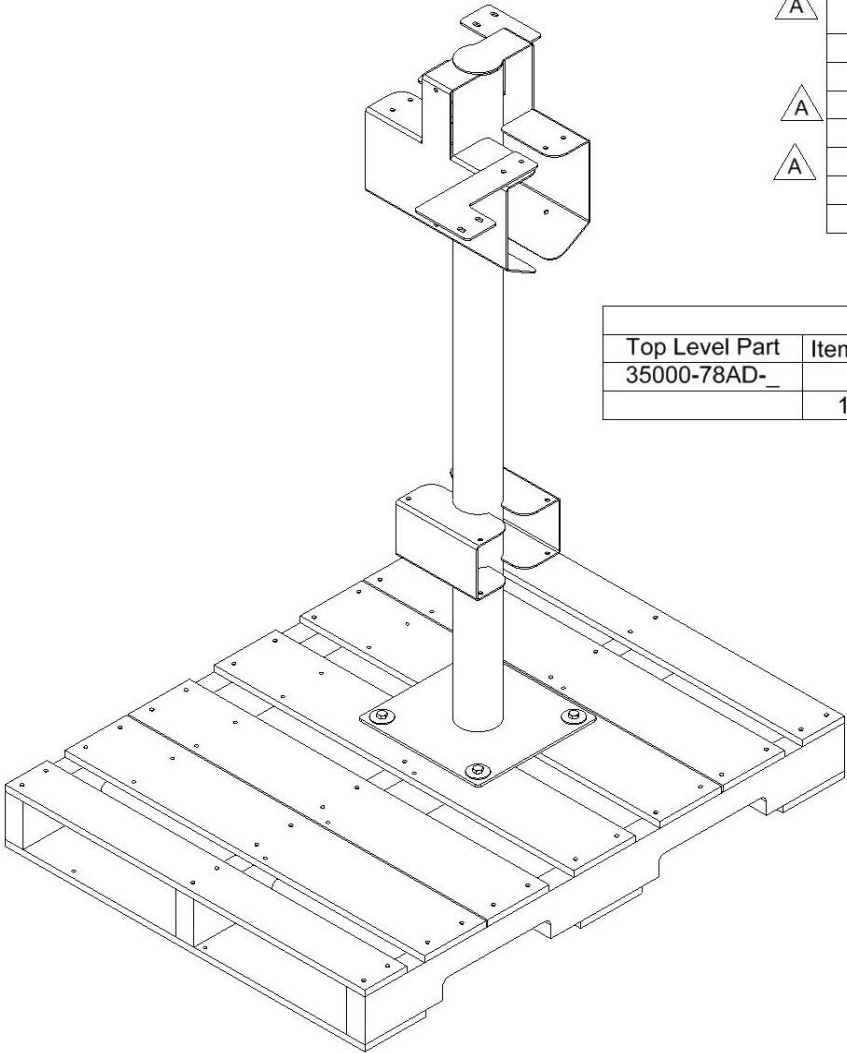

BILL OF MATERIALS			
ITEM	PART NUMBER	DESCRIPTION	QTY
1	2058-9-5	BRKT, CREVICE TOOL MOUNTING, DUAL TOOL STAND	2
2	35000-78WD-P_	TOOL STAND, TWO SIDED, PAINTED	1
3	5600D4	3/8-16 X 1.5 HHCS	4
4	5603D2	1/4-20 NYLOCK NUT, SS	4
5	5606D22	WASHER, 3/8 FENDER	8
6	5702D5	1/4-20 X .75 TORX SEC. T-27	4
7	8939	PALLET, DUAL, OVAL, SPECIAL, 30X40	1
8	B5722-002	NUT, 3/8-16 UNC HEX LOCK NUT	4

* Suffix Part # List								
Top Level Part	Item #	PART #	RED	BLUE	YELLOW	GREEN	BLACK	CUSTOM
35000-78AD-			RED	BLU	YEL	GRN	BLK	CU
	1	35000-78WD-P_	R	B	Y	G	BK	CU

POST OPTIONS:
 35000-40A - MAT RACK ASSEMBLY
 35000-30-4A - HOSE/CREVICE TOOL ASSEMBLY
 2058-13A-1 - HOSE/CLAW HANGER ASSEMBLY
 35000-240A - TOWEL RETURN

A	8995	ADDED 205-9-5 (2), 5702D5 (4) AND 5603D2 (4)	3/22/23	BJL
-	8994	RELEASED	3/20/23	BJL
REV	NO.	DESCRIPTION	DATE	BY

TITLE			
TOOL STAND, TWO SIDED, ASSY, PAINTED			
UNSPECIFIED TOLERANCES		MATERIAL	
1 PL ±.030	BY	B. LEMKE	
2 PL ±.020	DATE	3/20/2023	
3 PL ±.003	SCALE	SHEET	PART NO
ANGLE ± 1°		1 / 2	35000-78AD
			REV. A

2058-13A-1

NOTES:

1. REPLACES 2058-10A
2. PACKAGE IN BOX THAT ITEM 1 COMES IN OR IN 75000BOX. UP TO TWO HOSES CAN FIX IN BOX.
3. ALL PARTS BESIDES HOSE AND CLAW ASSEMBLY TO BE PLACED IN BAG.

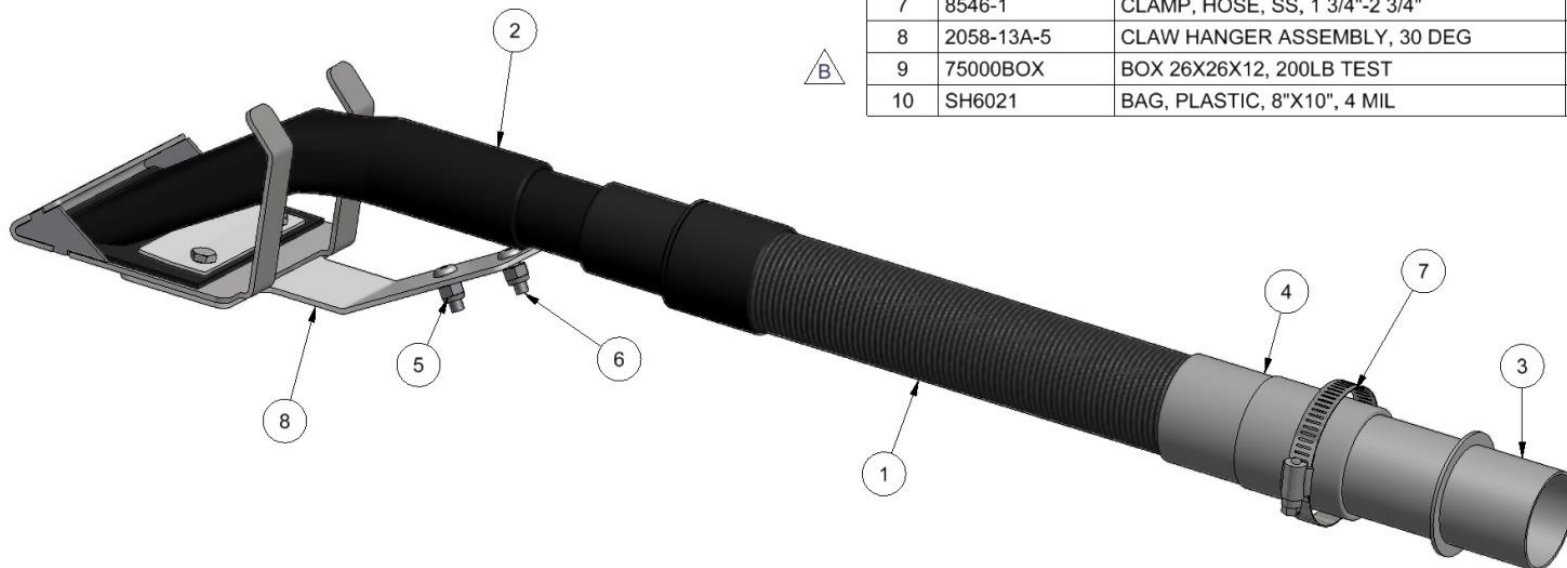

B

B

BILL OF MATERIALS

ITEM	PART NUMBER	DESCRIPTION	QTY
1	2032BLACK	HOSE, 1-1/2" X 15" BLACK VACUUM HOSE	1
2	2058-15	CLAW/CUFF ASSY 1-1/2	1
3	2083-4	2" HOSE ADAPTOR	1
4	2084	HOSE COUPLER/ENLARGER 1-1/2 HOSE	1
5	5603D2	1/4 Std NC Nylock Nut SS	2
6	5702D5	1/4-20 X .75 TORX SEC. T-27	2
7	8546-1	CLAMP, HOSE, SS, 1 3/4"-2 3/4"	1
8	2058-13A-5	CLAW HANGER ASSEMBLY, 30 DEG	1
9	75000BOX	BOX 26X26X12, 200LB TEST	1
10	SH6021	BAG, PLASTIC, 8"X10", 4 MIL	1

TITLE		CLAW HANGER ASSEMBLY, 30 DEG	
UNSPECIFIED TOLERANCES		DRAWN BY: mws	
1 PL ±.030		DATE: 12/16/2014	
2 PL ±.020		SCALE: 1 / 1	
3 PL ±.003		SHEET: 1 / 1	
ANGLE ± 1°		PART NO: 2058-13A-1	
		REV: B	

B	7795	REPLACED 2058-13-1, -13W, -14, -3, 5601D4, (2) 5603D2 WITH 2058-13A-5	7/8/16	MWS
A	7522	ADD MORE COMPONENTS TO KIT	070715	JF
REV	NO.	DESCRIPTION	DATE	BY

THIS DOCUMENT SHALL NOT BE REPRODUCED NOR SHALL THE INFORMATION THEREIN BE USED BY OR DISCLOSED TO OTHERS EXCEPT AS AUTHORIZED BY J.E. ADAMS INDUSTRIES



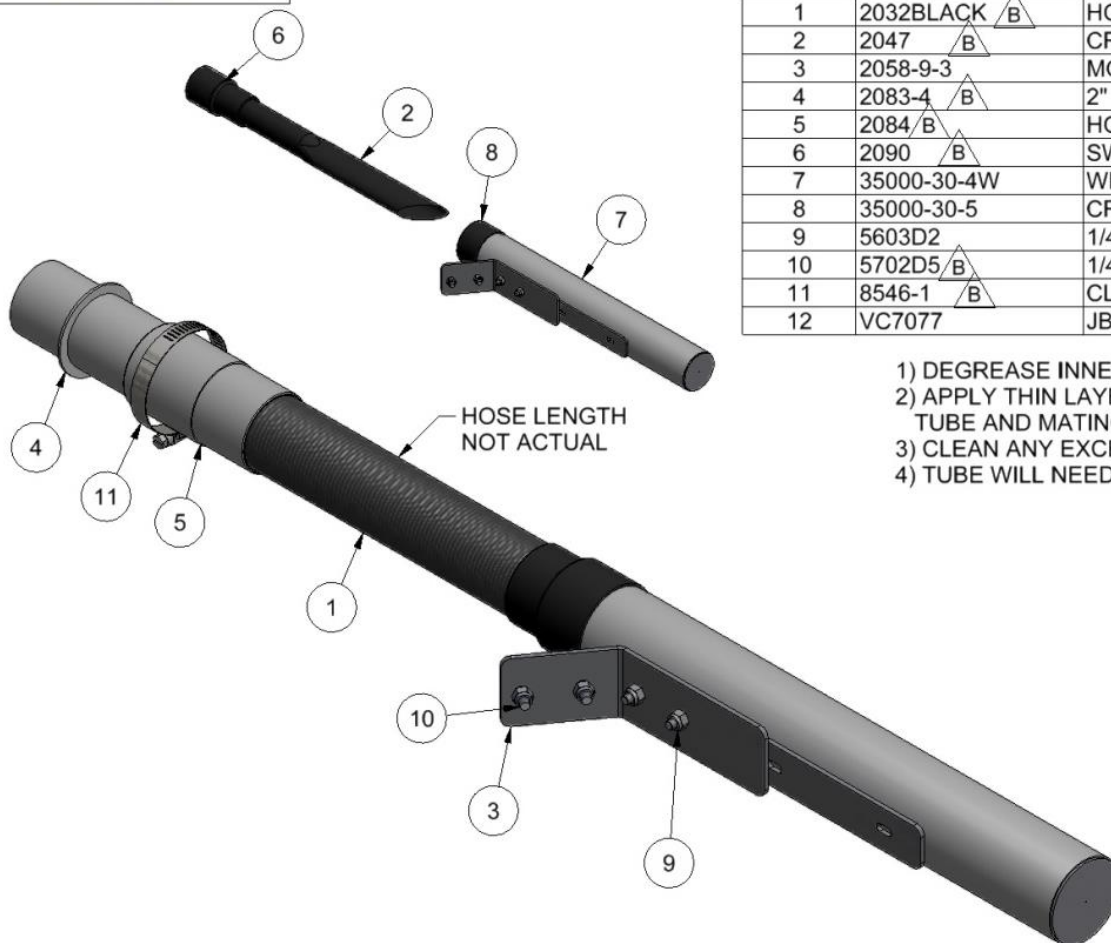

BILL OF MATERIALS

ITEM	PART NUMBER	DESCRIPTION	QTY
1	2032BLACK ^B	HOSE, 1-1/2" X 15" BLACK VACUUM HOSE	1
2	2047 ^B	CREVICE TOOL, BLACK 16" X 1-1/2"	1
3	2058-9-3	MOUNTING BRACKET, CREVICE HOLDER	1
4	2083-4 ^B	2" HOSE ADAPTOR	1
5	2084/B ^B	HOSE COUPLER/ENLARGER 1-1/2 HOSE	1
6	2090 ^B	SWIVEL COUPLING 1-1/2"	1
7	35000-30-4W	WELDMENT, CREVICE TOOL HOUSING	1
8	35000-30-5	CREVICE HOLSTER END CAP	1
9	5603D2	1/4 Std NC Nylock Nut	^B 4
10	5702D5 ^B	1/4-20 X .75 TORX SEC. T-27	2
11	8546-1 ^B	CLAMP, HOSE, SS, 1 3/4"-2 3/4"	1
12	VC7077	JB WELD	X

- 1) DEGREASE INNER TUBE WITH ALCOHOL.
- 2) APPLY THIN LAYER OF GLUE (VC7077) TO UPPER 2" OF INNER TUBE AND MATING PART OF PLASTIC SLEEVE, 80% COVERAGE MIN.
- 3) CLEAN ANY EXCESS ADHESIVE BEFORE DRY.
- 4) TUBE WILL NEED A MINIMUM 24 HOURS DRY TIME BEFORE USE.

TITLE

CREVICE TOOL ASSEMBLY

B	7522	ADD MORE COMPONENTS TO KIT	070715	JF
A	7464	CHANGE ADHESIVE TO JB WELD, REVISE INSTRUCTIONS	051215	JF
REV	NO.	DESCRIPTION	DATE	BY

THIS DOCUMENT SHALL NOT BE REPRODUCED NOR SHALL THE INFORMATION THEREIN BE USED BY OR DISCLOSED TO OTHERS EXCEPT AS AUTHORIZED BY J.E. ADAMS INDUSTRIES

UNSPECIFIED
TOLERANCES

1 PL ±.030
2 PL ±.010
3 PL ±.003
ANGLE ±1.0°

MATERIAL

SCALE

DRAWN
BY

JOHN F.

DATE

7/23/2012

CEDAR RAPIDS, IOWA

PART
NO.

35000-30-4A

REV.
B

PART
NO 35000-40A

- NOTES:
1. 35000-40A IS ASSEMBLY WITH BLACK MAT CLAMP WHICH IS STANDARD ON ALL COLORED SYSTEMS.
2. OTHER COLORS ARE BY SPECIAL ORDER ONLY, 35000-40A-"COLOR CODE"

B

BILL OF MATERIALS			
ITEM	PART NUMBER	DESCRIPTION	QTY
1	32000-__	CLAMP, MAT, ASSEMBLY	1
2	35000-40-6	MAT FRAME, LOWER BRKT	2
3	35000-40-8W	MAT RACK 1 PC WELDMENT	1
4	5603D2	1/4-20 NYLOCK NUT, SS	8
5	5702D5	1/4-20 X .75 TORX SEC. T-27	8
6	8597	5/16 WASHER	2

* Suffix Part # List						
Top Level Part	PART #	Column 1	Red	Blue	Yellow	Green
35000-40A-__			9	10	8	11
1	32000-__		9	10	8	11

* BLACK IS STANDARD COLOR

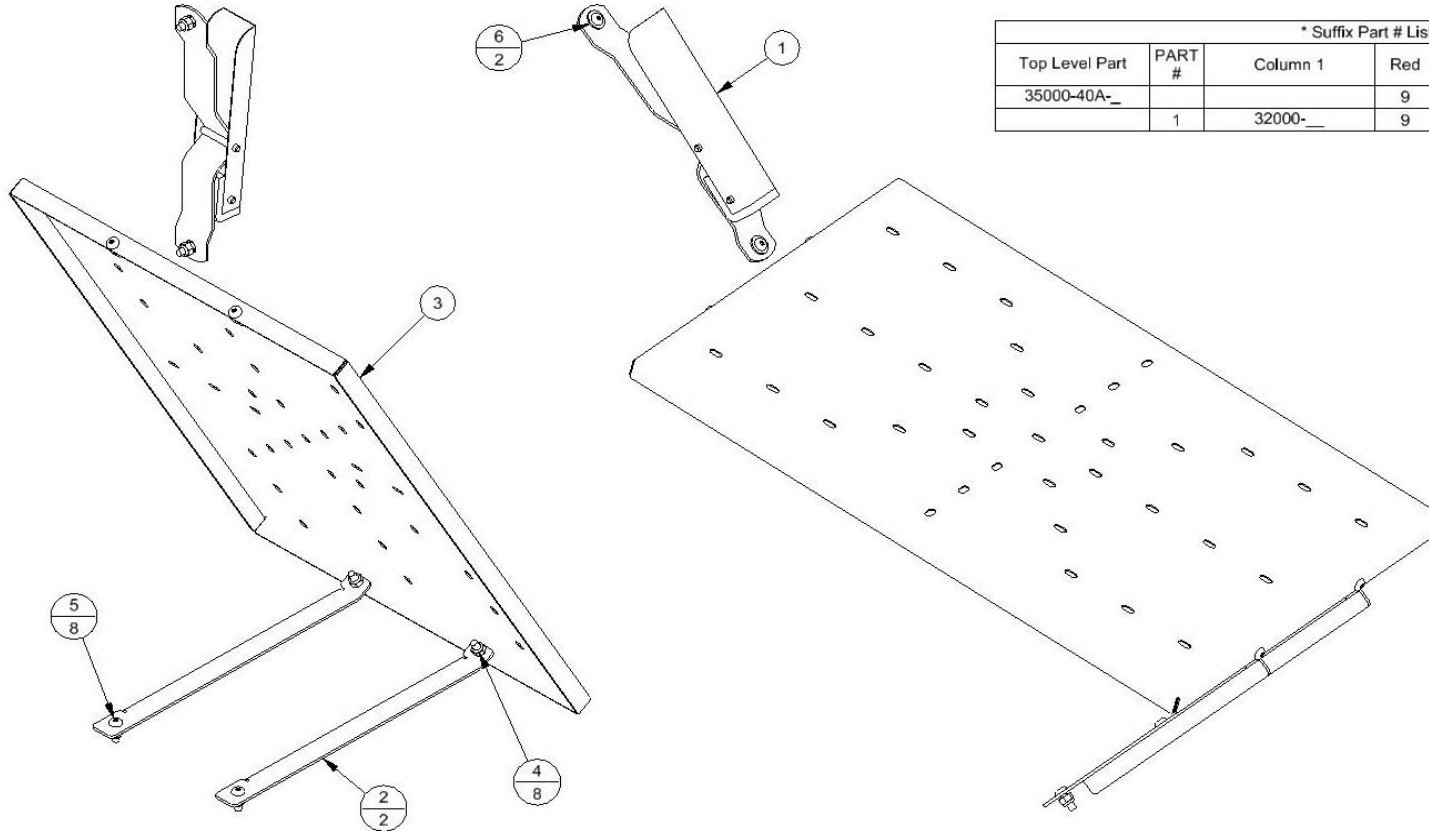

B	8848	ITEM 3 WAS 35000-40W	3/17/22	MWS
A	7563	CORRECTED COLOR CHART TO APPLY TO THIS ASSEMBLY, BLACK IS NOW STANDARD	9/2/15	MWS
REV	NO.	DESCRIPTION	DATE	BY

THIS DOCUMENT SHALL NOT BE REPRODUCED NOR SHALL THE INFORMATION THEREIN BE USED BY OR DISCLOSED TO OTHERS EXCEPT AS AUTHORIZED BY J.E. ADAMS INDUSTRIES

TITLE			
MAT RACK, CENTRAL VAC POST			
UNSPECIFIED TOLERANCES	MATERIAL	CEDAR RAPIDS, IOWA	
1 PL ±.030	DRAWN BY JOHN F		
2 PL ±.020	DATE 7/6/2015		
3 PL ±.003	SCALE 0.17 : 1		
ANGLE ± 1°	SHEET 1 / 1	PART NO 35000-40A	REV. B

35000-78-140A

NOTES:
1. ASSEMBLY CAN BE STACKED ON 52" X 52" PALLET, 4 PER LEVEL AND UP TO 3 HIGH FOR TOTAL OF 12.

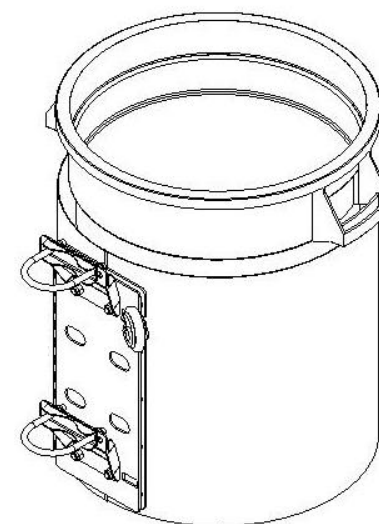
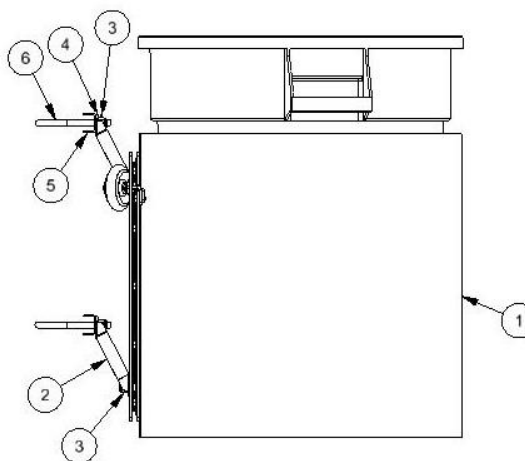
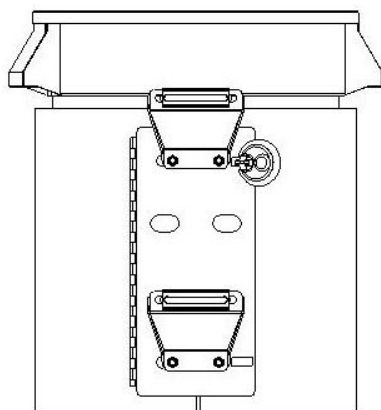
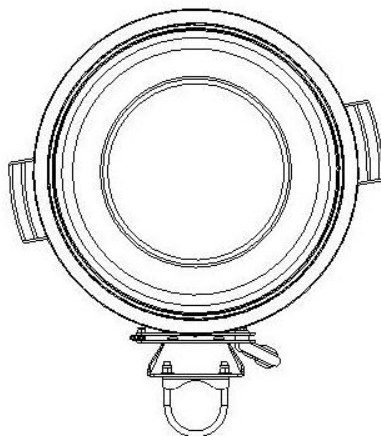

BILL OF MATERIALS

ITEM	PART NUMBER	DESCRIPTION	QTY
1	35000-140BDA	TRASH CAN ASY, BI-DIRECTIONAL	1
2	75000-140W	BRKT, TRASH CAN ADAPTOR WDMT	2
3	5603D3	NUT, 3/8-16 Nylock, SS	8
4	5606D31	WASHER, FLAT 3/8" SAE, SS	4
5	35000-78-140	BRACKET 3" POLE TO TRASH CAN ADAPTER	2
6	5733D34	U-BOLT, 3"ID X 3/8" X 4.75" L SS	2

D	9003	REMOVED 35000-5252 QTY .083	4/12/23	BJL
C	8627	REPLACED 35000-140A WITH 35000-140BDA	7/14/20	MWS
B	8105	ADDED 35000-5252 AND NOTE	11/2/17	MWS
A	8067	SWAPPED 5606D31 FOR 5606D3, SS IN PLACE OF ZP	8/9/17	MWS
REV	NO.	DESCRIPTION	DATE	BY

TITLE		TRASH CAN MOUNT ASY, 3" RND POST	
UNSPECIFIED TOLERANCES		MATERIAL	
1 PL	± .030	DRAWN BY	MWS
2 PL	± .020	DATE	2/23/2016
3 PL	± .003	SCALE	1 / 10
ANGLE ± 1°		SHEET	1 / 1
PART NO.		35000-78-140A	
REV.		D	

THIS DOCUMENT SHALL NOT BE REPRODUCED NOR SHALL THE INFORMATION THEREIN BE USED BY OR DISCLOSED TO OTHERS EXCEPT AS AUTHORIZED BY J.E. ADAMS INDUSTRIES



CEDAR RAPIDS, IOWA

BILL OF MATERIALS			
ITEM	PART NUMBER	DESCRIPTION	QTY
1	5603D2	1/4-20 NYLOCK NUT, SS	4
2	5647D8	RIVET, POP, SS, 1/16"-1/8"	43
3	5702D5	1/4-20 X .75 TORX SEC. T-27	4
4	6409	BOX, AIR MACHINE, 24x20x14	1
5	35000-240-1	PLATE, TOP, TOWEL RETURN	1
6	35000-240-2	PLATE, RETURN SUPPORT, TOWEL RETURN	2
7	35000-240-3	PLATE, BACK, TOWEL RETURN	1
8	35000-240-4	TOWEL RETURN, 4 GALLON, SQUARE PAIL	1
9	35000-240-5	PLATE, SHELF, TOWEL RETURN	1

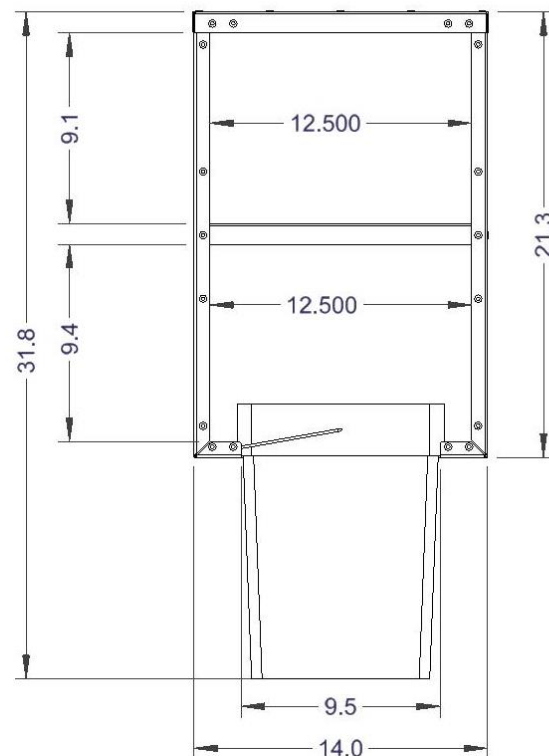
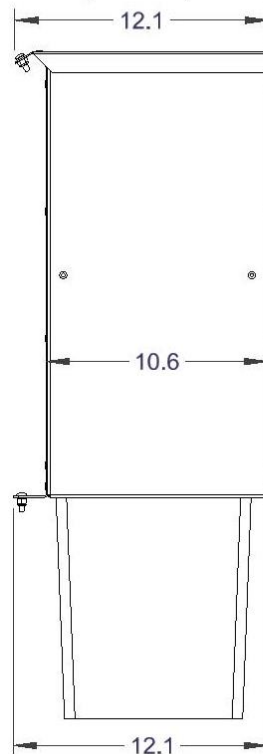
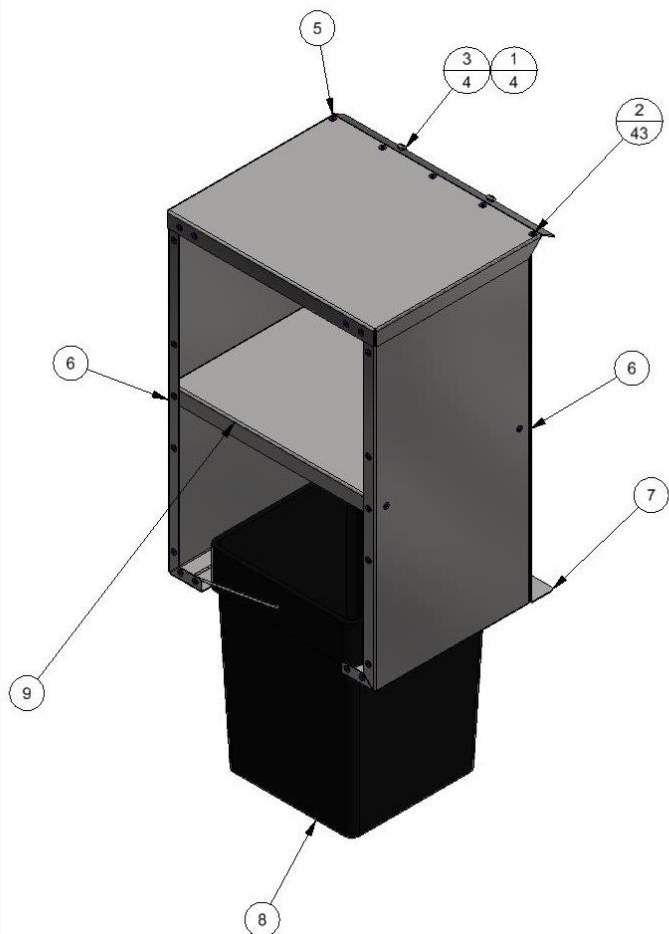

A	9028	REDESIGNED TO OPEN FRONT	6/14/23	BJL
-	8993	RELEASED	3/13/23	BJL
REV	NO.	DESCRIPTION	DATE	BY

THIS DOCUMENT SHALL NOT BE REPRODUCED NOR SHALL THE INFORMATION THEREIN BE USED BY OR DISCLOSED TO OTHERS EXCEPT AS AUTHORIZED BY J.E. ADAMS INDUSTRIES

TITLE		TOWEL RETURN ASSEMBLY		CEDAR RAPIDS, IOWA	
UNSPECIFIED TOLERANCES 1 PL ±.030 2 PL ±.020 3 PL ±.003 ANGLE ± 1°		MATERIAL			
		DRAWN BY			
		DATE			
		12/22/2022			
		SCALE	SHEET	PART NO	REV.
		1 / 8	1 / 1	35000-240A	