

Models- **36000-400 CENTRAL VAC PAY SYSTEM**

Page 2	Product Information
Page 3,4	Specifications
Page 5	Product Dimensions
Page 6	Collector Information
Page 7-9	Control Box Installation Instructions
Page 10-13	Valve Installation Instructions
Page 14	Face Plate Installation Instructions
Page 15	Maintenance/Operation
Page 16-22	Parts

PRODUCT INFORMATION

Please take a moment to fill out the information below in order to aid us with any future sales or service inquiries. Model number and serial number information can be found on the serial tag located inside the control box and/or on the lower exterior of the can. Key number can be found on the tag that comes attached to the keys. There may be more than one key number depending on unit.

Please keep this information with your records.

MODEL#:_____

SERIAL#:_____

KEY NUMBER(S):_____

DATE PURCHASED:_____

DISTRIBUTOR:_____

**J.E. Adams Industries
1025 63rd Ave. S.W.
Cedar Rapids, IA 52404
1-800-553-8861
www.jeadams.com**

Specifications

Pay system will work with existing arch systems, with following additions:

- Pre-collector kit swap (singles on ends, doubles in middle) (mandatory)
- Valve kits, singles and doubles (comes with control solenoid when necessary)
- Control/pay box (tall box only, uses long face plates, left or right post mounting)
- Control faceplate assemblies (standard combinations available)
- Customer supplied air source and air lines **(90 PSI maximum pressure)**

NOTE: This manual is for central vac pay system only. If installing new system you must use 36000-01_11-W **SUPPORTED ARCH** Manual which has details of installation of stanchions, arches and canopies along with accessories.

Pay system works with standard accessories:

- Locking trash receptacle
- Stainless steel mat rack
- Mat clamp
- Claw tool holster
- Crevice tool holster
- Optional 12 or 14 foot shade canopies
- Optional LED Lighting

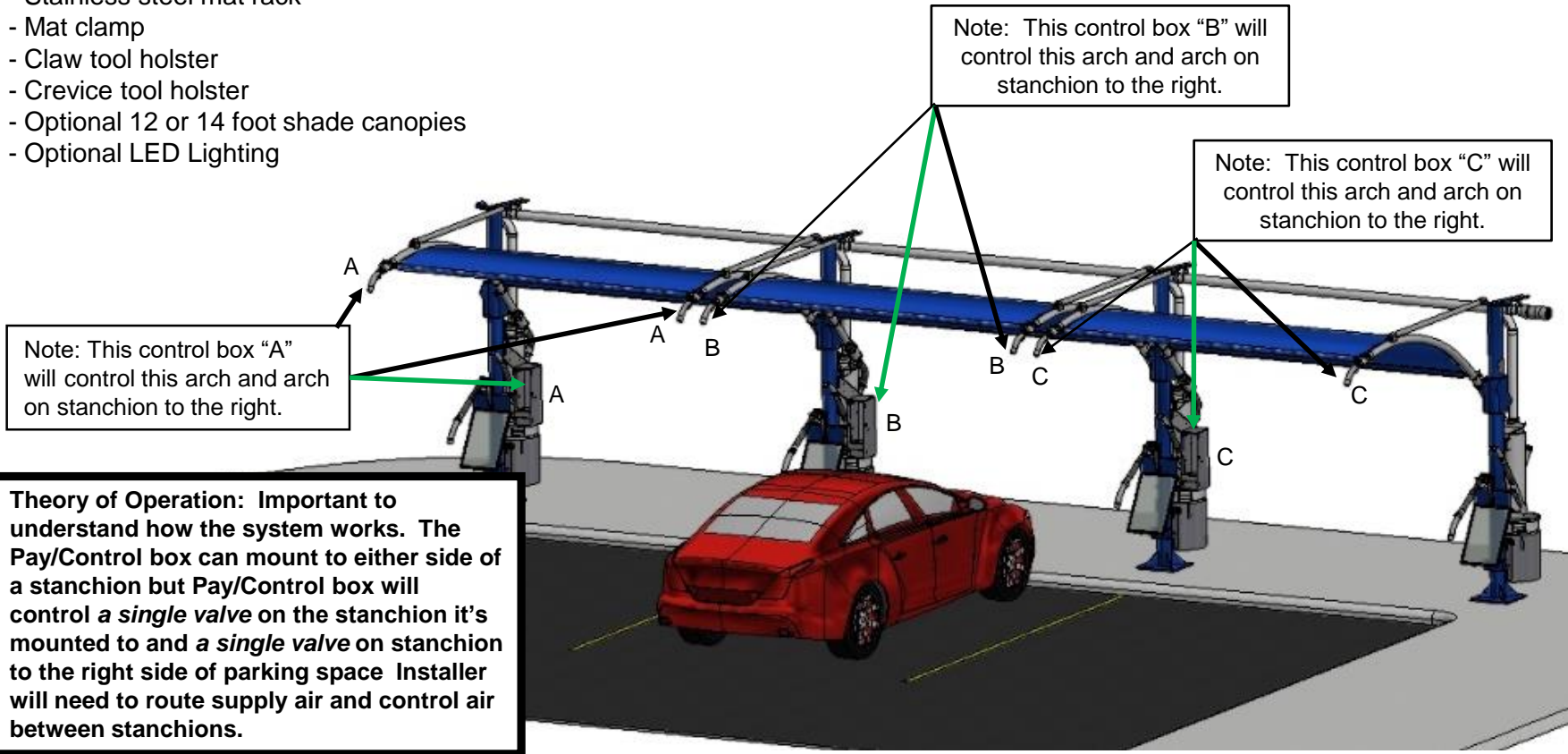

Specifications Cont.

Unit specifications:

Voltage:

Amperage:

Weight:

Per Control Box Assembly (LED7 Display version)

120vac, 60hz

5 amp

35000-400-4A (Control Box Assembly) 48 lbs

35000-400-20A (Face Plate Assembly) 14 lbs

9202-65A (Pre-Collector) 27 lbs.

Dimensions

NOTE: This manual covers only the Pay Central Vac system and is not intended to replace the standard install manual. Standard installation instructions must be followed in manual 36000-01_11-W SUPPORTED ARCH

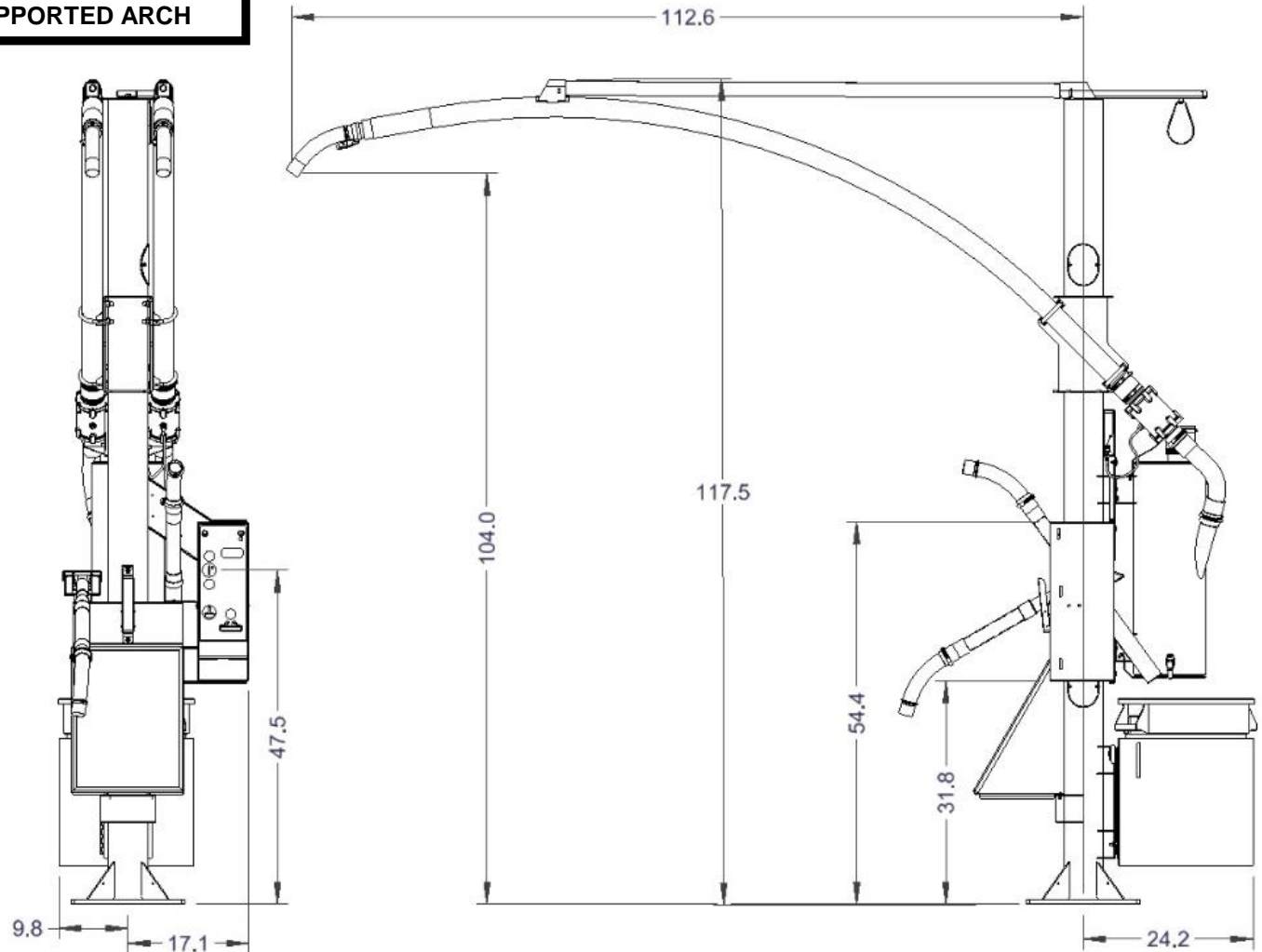

Pre-Collector Considerations:

36000-11A-W and 36000-01A-W Central vacuum Stanchion assemblies will require a replacement Pre-Collector if retrofitting on existing install due to component valve clearance on Pay Vac system.



Standard Pre-Collector
9202-61A (double arch)
(9202-61A-1 for single arch)



Pre-Collector for Pay Vac System
9202-65A (double arch)
(9202-65-4 for single arch)

Control Box Install, 35000-400-4A:

The control box can be mounted on either the left or right side of post. Customer preference as to which side of the stanchion it is mounted. Same parts are used regardless of orientation of Control Box. In retrofit situations the swing out trash can 35000-140A is more difficult to remove with Control Box on left but still functional. Post May 2020 standard Central Vac systems come with bidirectional trash can unit.

This step requires 2 people as there can be multiple items of some weight to hold in place while hardware is started. Hardware used are (4) 3/8" Torx security bolts and (4) 3/8" hex bolts with locknuts

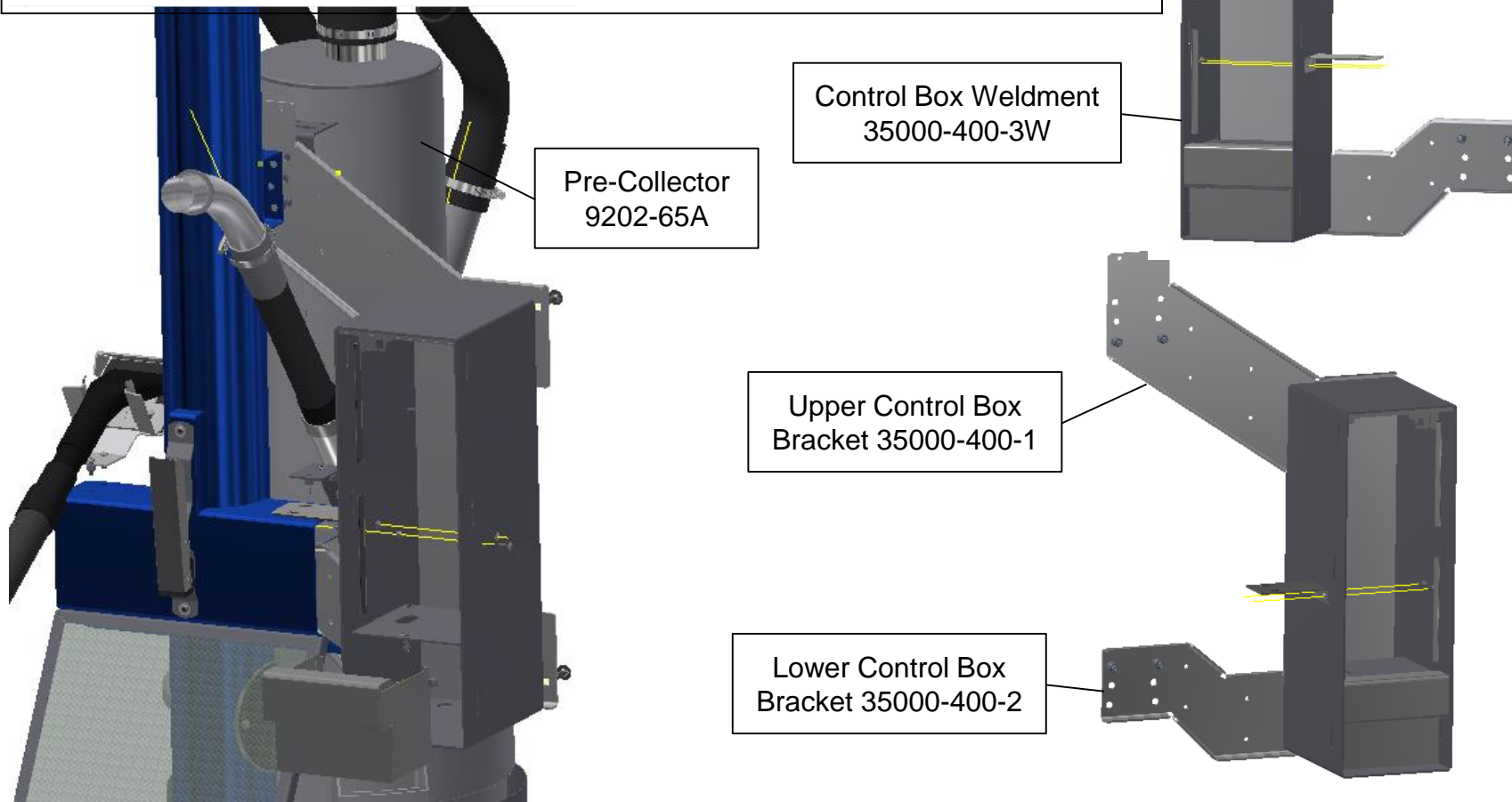

Control Box Install, 35000-400-4A continued:

Step 1: Start assembly with just the upper and lower brackets, Pre-Collector and LED power supply & bracket (optional). Start all of the bolts to mount the pre-collector, upper & lower brackets and LED power supply (option) but leave them all a bit loose for next step.

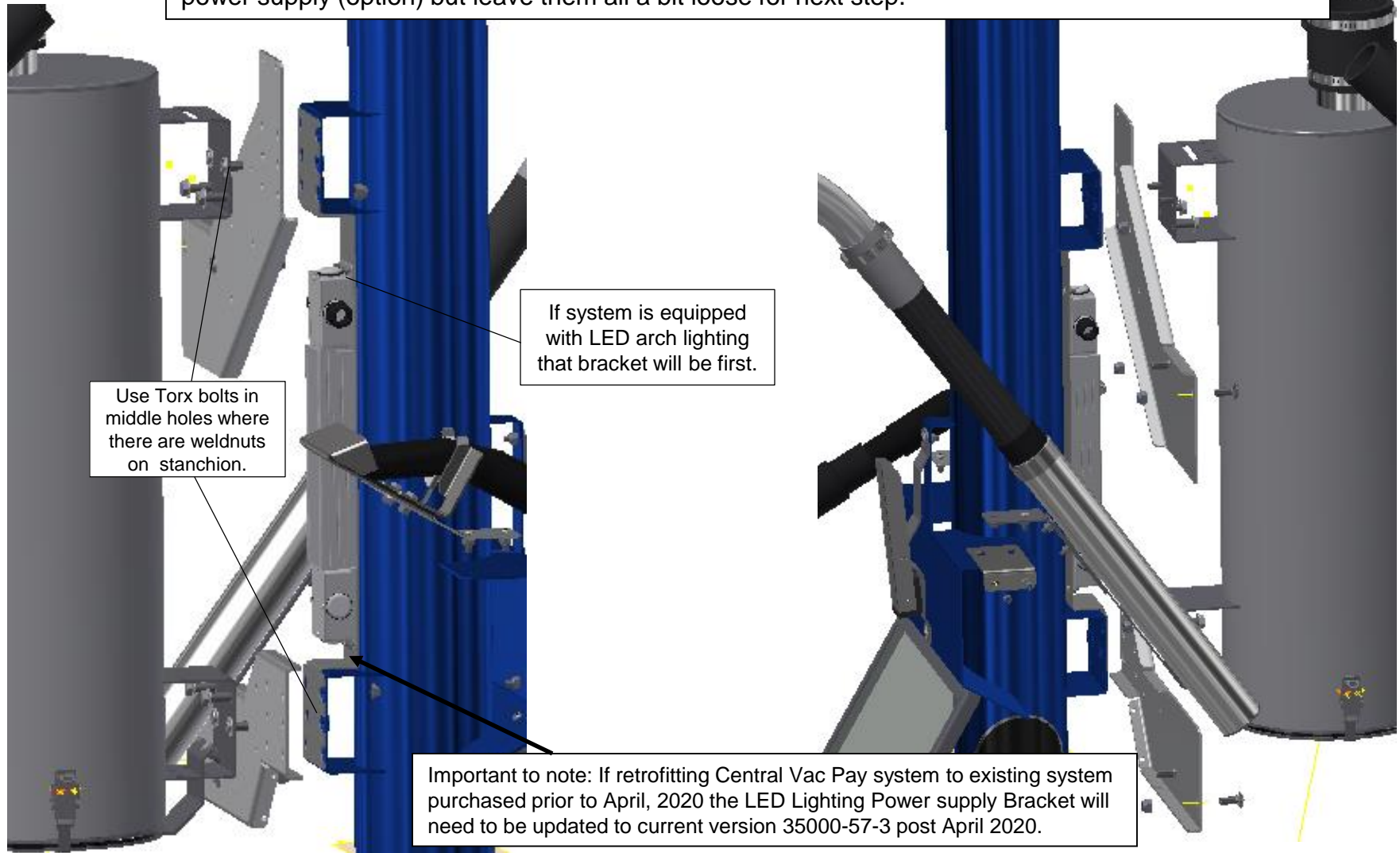

Control Box Install, 35000-400-4A continued:

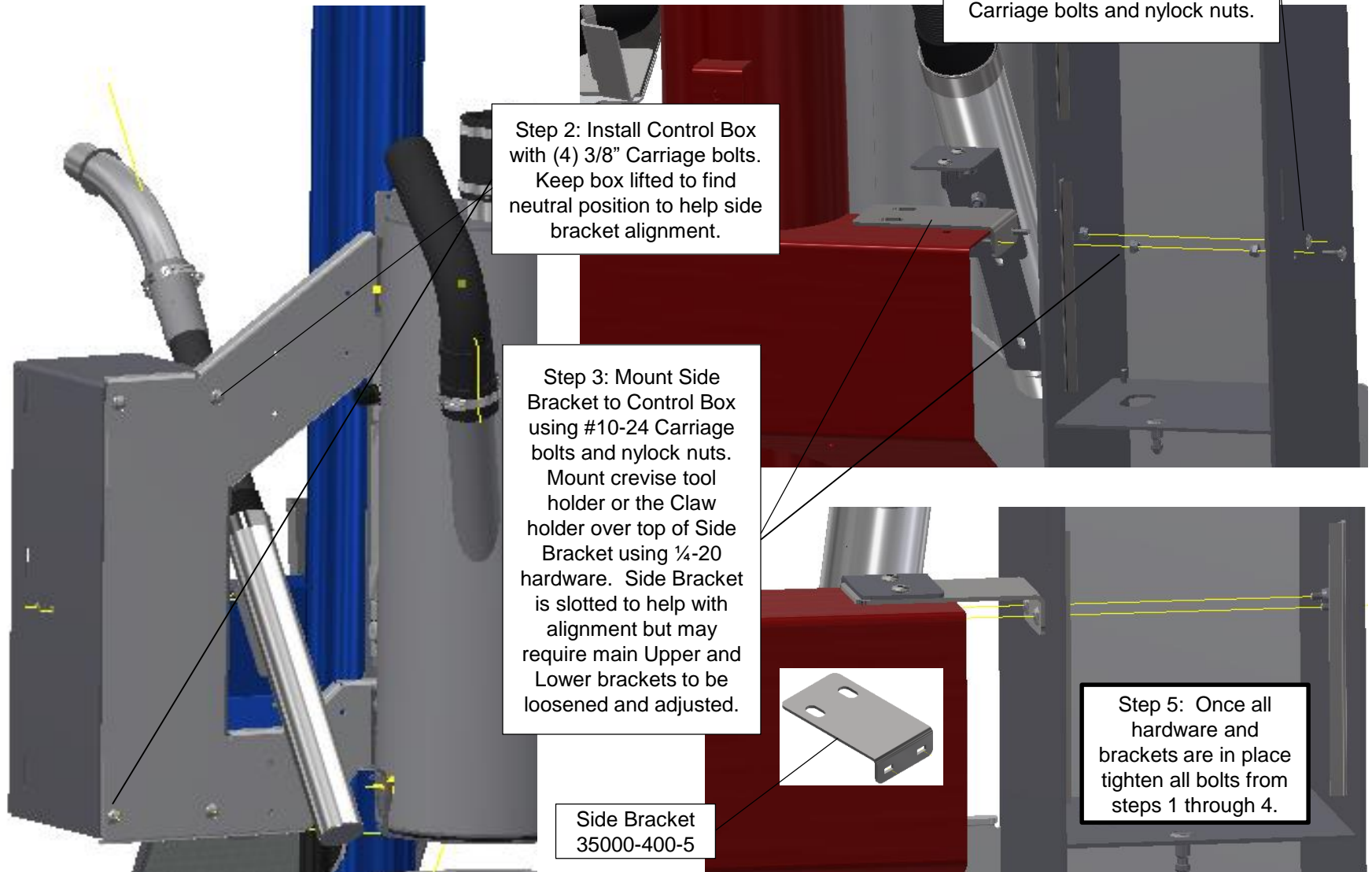

Solenoid & Valve Install 35000-400-2A-3, 4, 5:

Double Valve Asy
35000-400-2VA
Used with 2 arches.

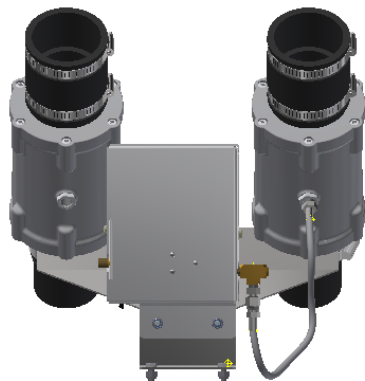

Single Valve Asy
35000-400-2VA-4
Used on left
single arch.

Solenoid in
enclosure

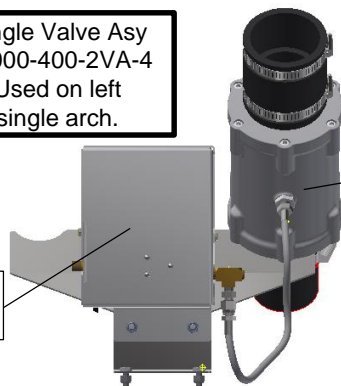

2" Valve
35000-400-2V

Valve Support Brkt
35000-400-7

Single Valve Asy
35000-400-2VA-5
Used on right
single arch
(No solenoid).

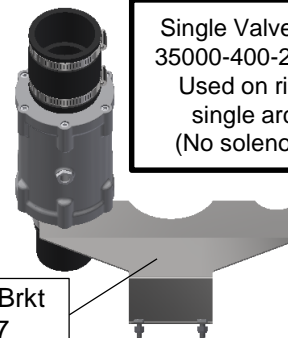

Typical dual arch system (36000-11A with 36000-01A single arch ends) will require 3 different valve/ solenoid kits. The left most Stanchion with single arch will have (1) Valve and (1) Solenoid Controller. The inner Stanchions will have Dual Valve Asy at each Stanchion. The right end Stanchion will have a single valve assembly only, no Solenoid.

Single Valve Asy
w/ Solenoid
35000-400-2VA-4

Double Valve Asy
w/ Solenoid
35000-400-2VA-3

Single Valve Asy
35000-400-2VA-5
No Solenoid

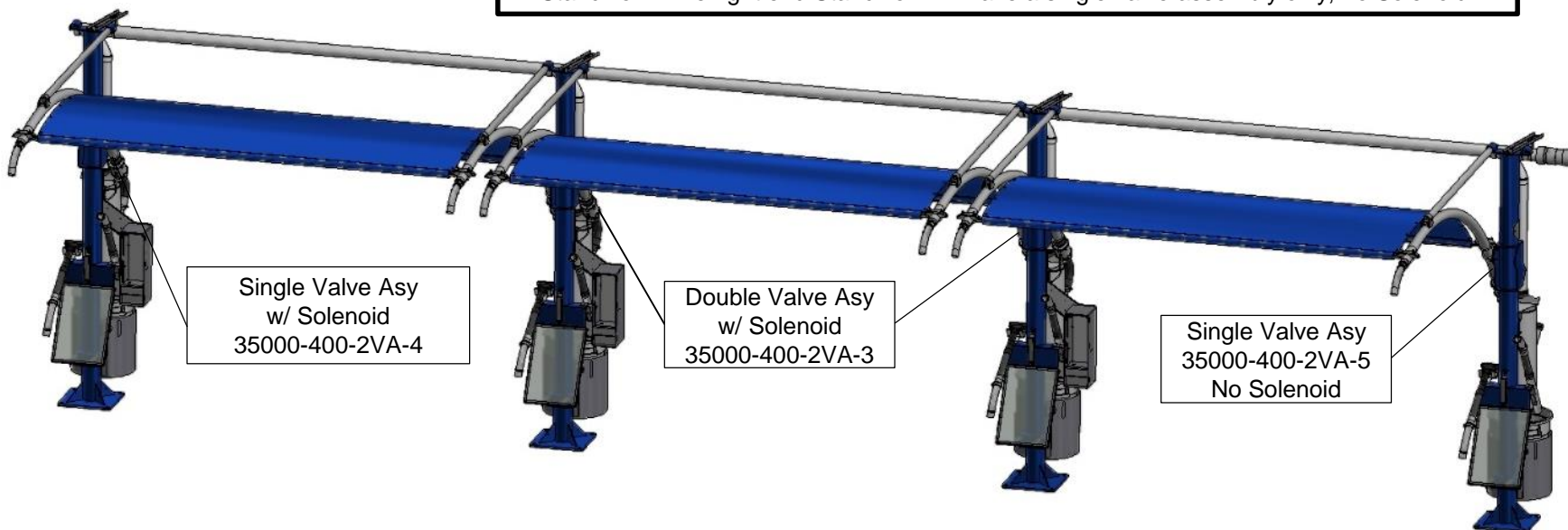

Solenoid & Valve Install Continued:

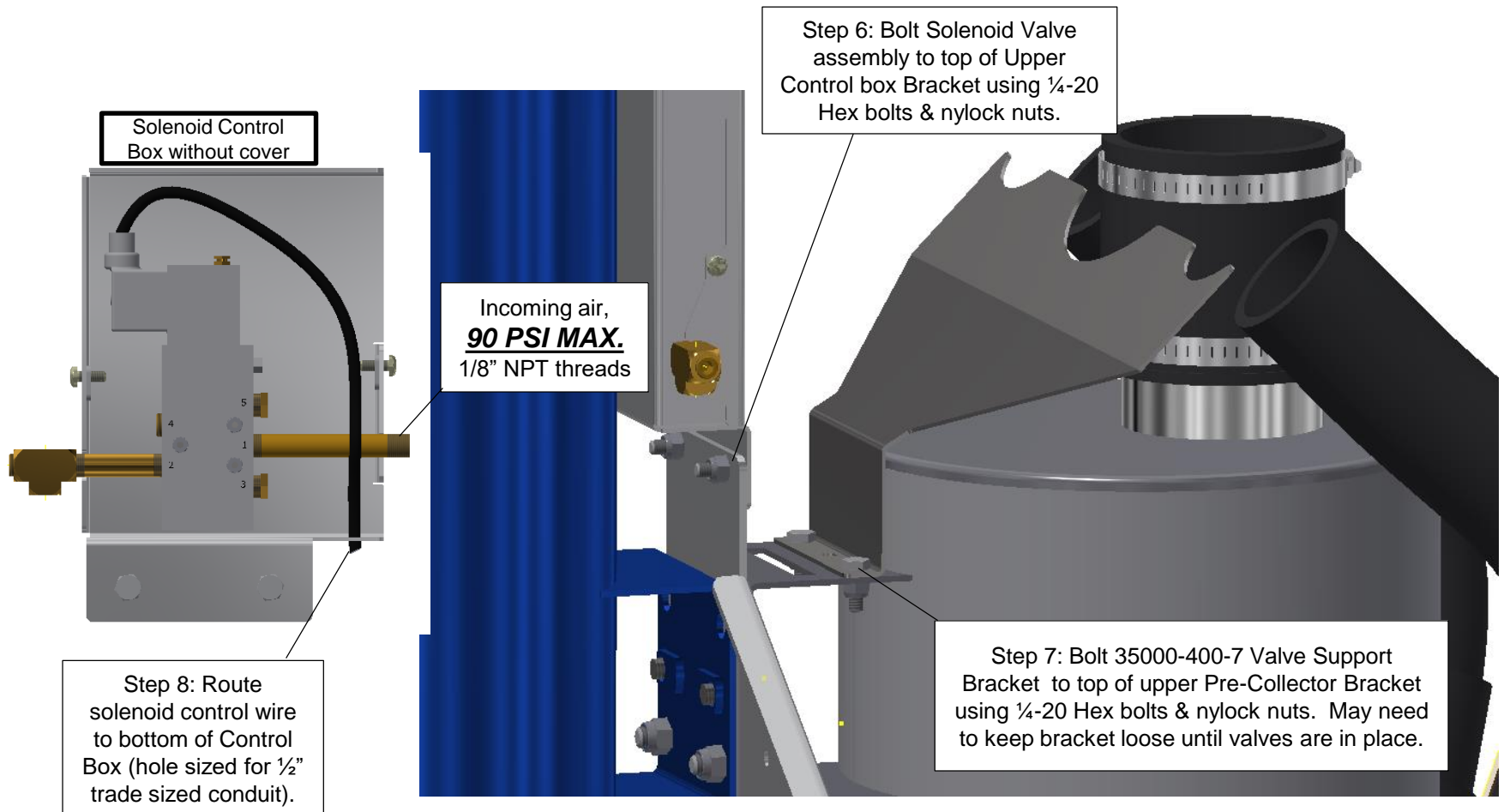

Solenoid & Valve Install Continued:

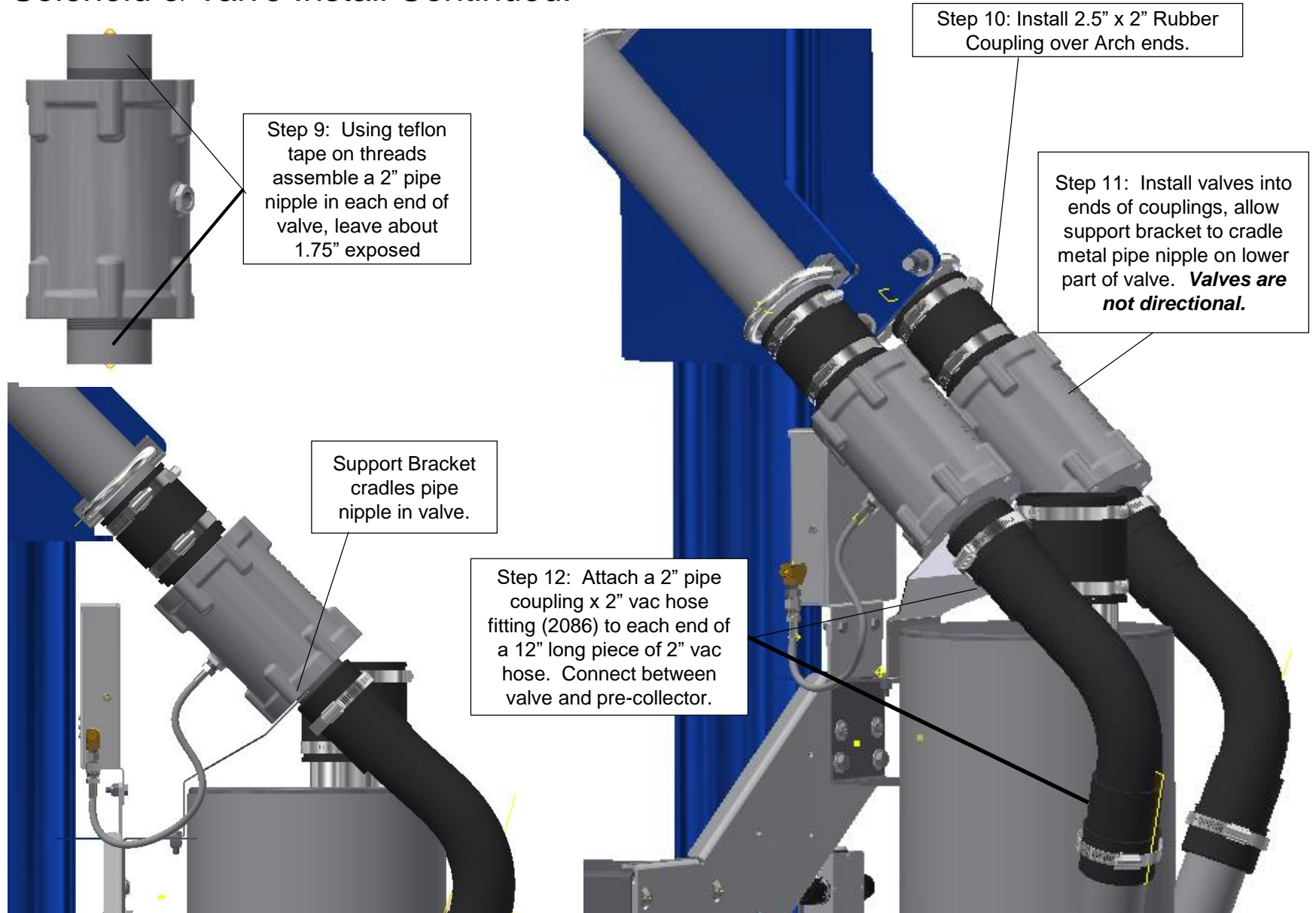

Solenoid & Valve Install Continued:

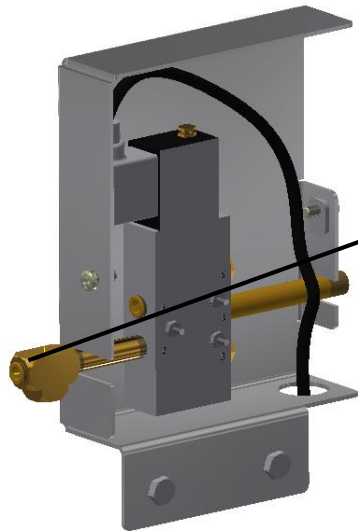

Step 13: The left valve in dual valve or the left valve on a far left stanchion in a row of stanchions will need to be connected to the solenoid valve on the stanchion to the left as noted on page 3 of the manual. Remove plug in end of Tee and attach air line between valve and solenoid.

Convenient to route control air line along overhead vacuum supply pipe or canopy structure.

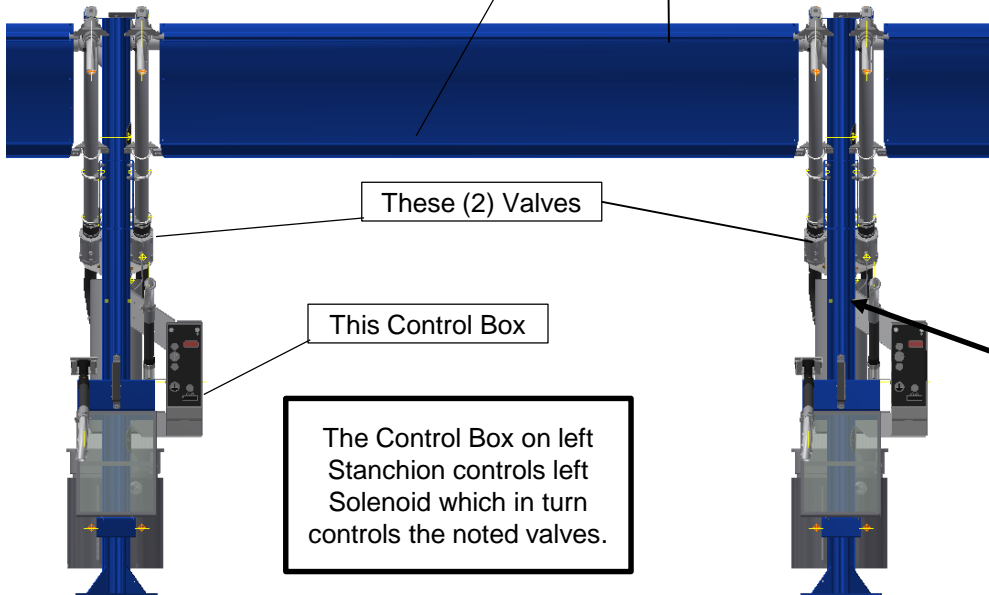

These (2) Valves

This Control Box

The Control Box on left Stanchion controls left Solenoid which in turn controls the noted valves.

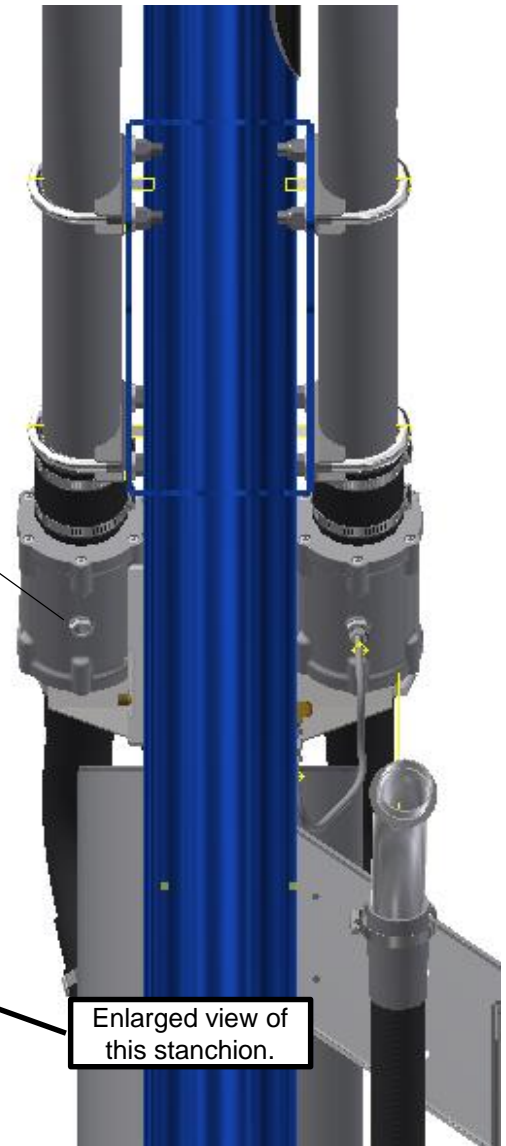

Enlarged view of this stanchion.

Control/Faceplate/Power Installation:

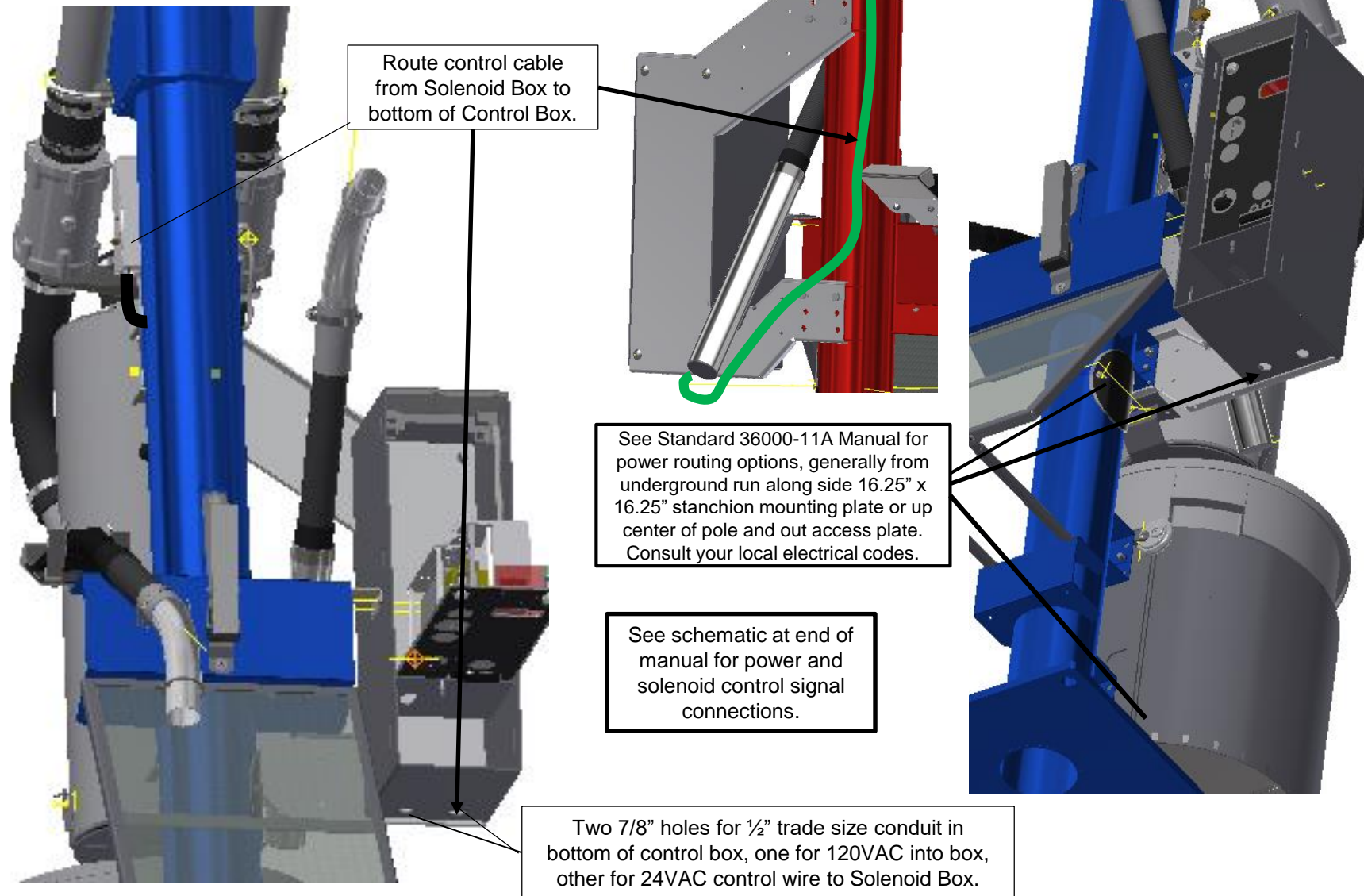

Maintenance:

- Pre-collectors dirt bins must be emptied on a daily basis or as needed. Large particulate such as pens, coins, jewelry, bolts, etc. will be collected here.
- Gaskets on pre-collectors must be checked for wear once a week or as needed.
- Nuts and bolts on structure should be checked once a month or as needed.
- Fabric canopies should be taken down before severe weather situations.
- Powder coated parts will eventually wear over time. JE Adams offers touch up paint to keep your parts looking great.
- Stainless steel parts should be wiped/ cleaned as needed.
- Verify daily that system air pressure is not exceeding the operational maximum of 90 PSI

Operations:

- Valves in their off state have pressure on an internal bladder that keeps them from flowing vacuum pressure. When customer purchases time at a vacuum drop the solenoid allows the air pressure to bleed off the valve/s associated with that drop location thus allowing vacuum pressure at the hoses. It is best to operate valves at lowest pressure possible while still closing off majority of vacuum pressure (50 to 60 PSI) This will prolong life of valve and reduce stress on internal rubber bladder.
- ***When central vacuum system is deactivated (producer is powered down) it is vitally important that the supply pressure to valves is also disconnected at source and allowed to bleed off so valves remain in relaxed state (open) during shut off. This will prevent bladders in valves from taking a set and not opening completely when in use.**
- System can become a free vend system again by simply removing supply air pressure at source and allow all valves to bleed off their pressure.

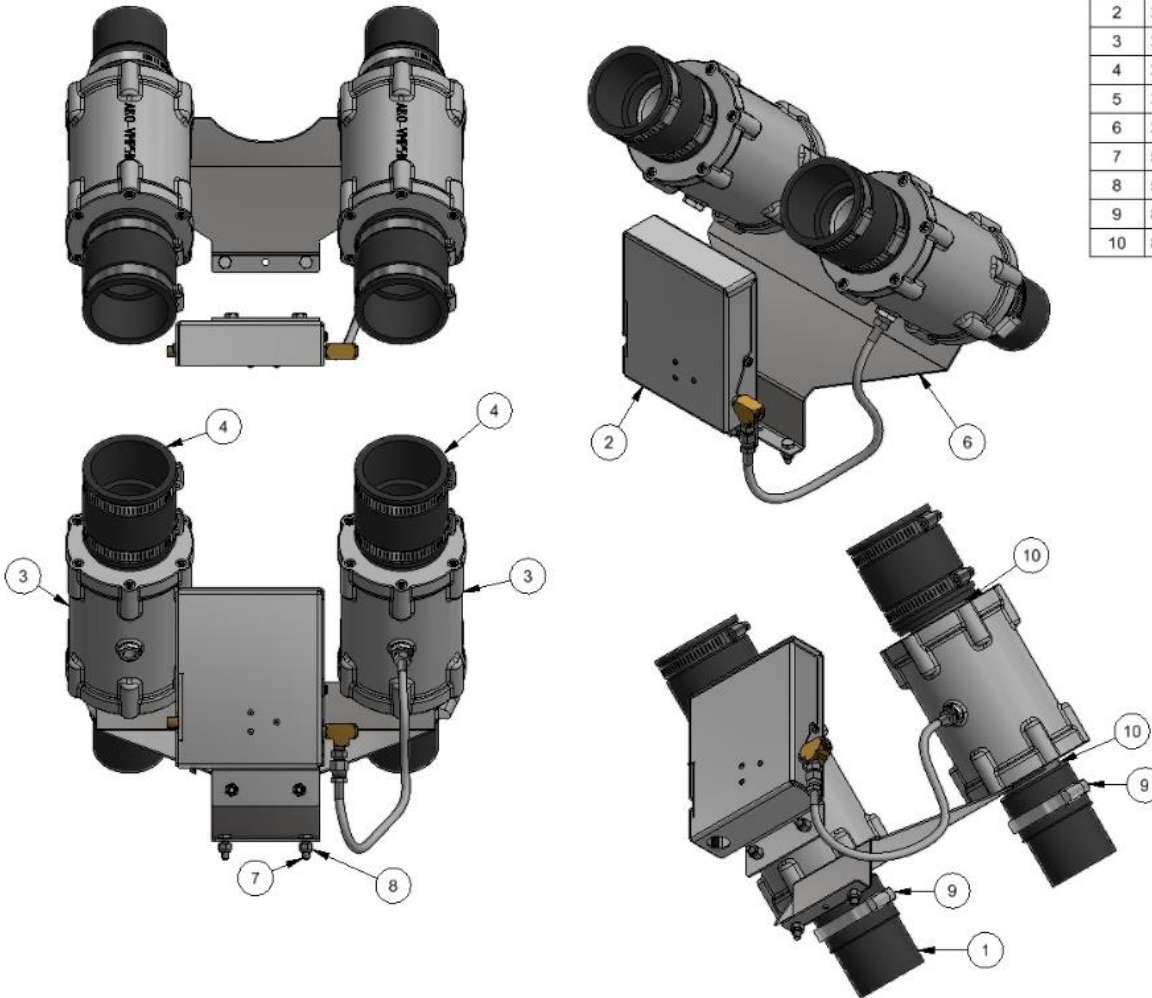

BILL OF MATERIALS			
ITEM	PART NUMBER	DESCRIPTION	QTY
1	2086	COUPLER, 2" PIPE - 2" HOSE	2
2	35000-400-10A	AIR VALVE ASY, 2 VALVE, CV PAY	1
3	35000-400-2V	VALVE, PINCH, 2" PLASTIC BODY	2
4	35000-400-30	COUPLER, RUBBER, 2" PIPE TO 2.5" PIPE	2
5	35000-400-34	HOSE ASY, CV PAY AIR, 18"	1
6	35000-400-7	BRKT, VALVE SUPPORT, CV PAY	1
7	5601D4	1/4-20 x 3/4 HHCS-SS	2
8	5603D2	1/4-20 NYLOCK NUT, SS	2
9	8061-720-8	3" HOSE CLAMP, STAINLESS STEEL	2
10	8708-3	PIPE NIPPLE- 2"-11 1/2 NPT x 2"	4

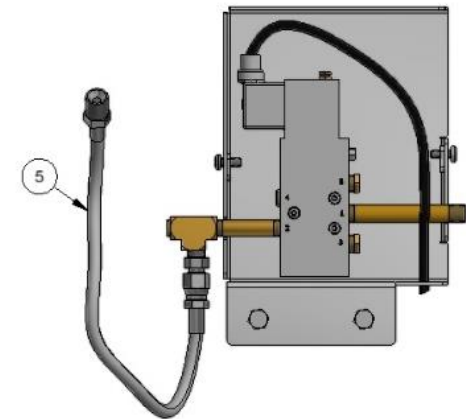

-	8566	RELEASED	4/20/20	MWS
REV	NO.	DESCRIPTION	DATE	BY

THIS DOCUMENT SHALL NOT BE REPRODUCED NOR SHALL THE INFORMATION THEREIN BE USED BY OR DISCLOSED TO OTHERS EXCEPT AS AUTHORIZED BY J.E. ADAMS INDUSTRIES

TITLE			
CV PAY, 2 FLAT ARCH VALVE ASY			
UNSPECIFIED TOLERANCES	MATERIAL	DATE	REV.
1 PL ±.030	DATE	2/28/2020	-
2 PL ±.020	SCALE	0.16 : 1	
3 PL ±.003	SHEET	1 / 1	
ANGLE ± 1°	PART NO.	35000-400-2VA-3	



35000-400-4A

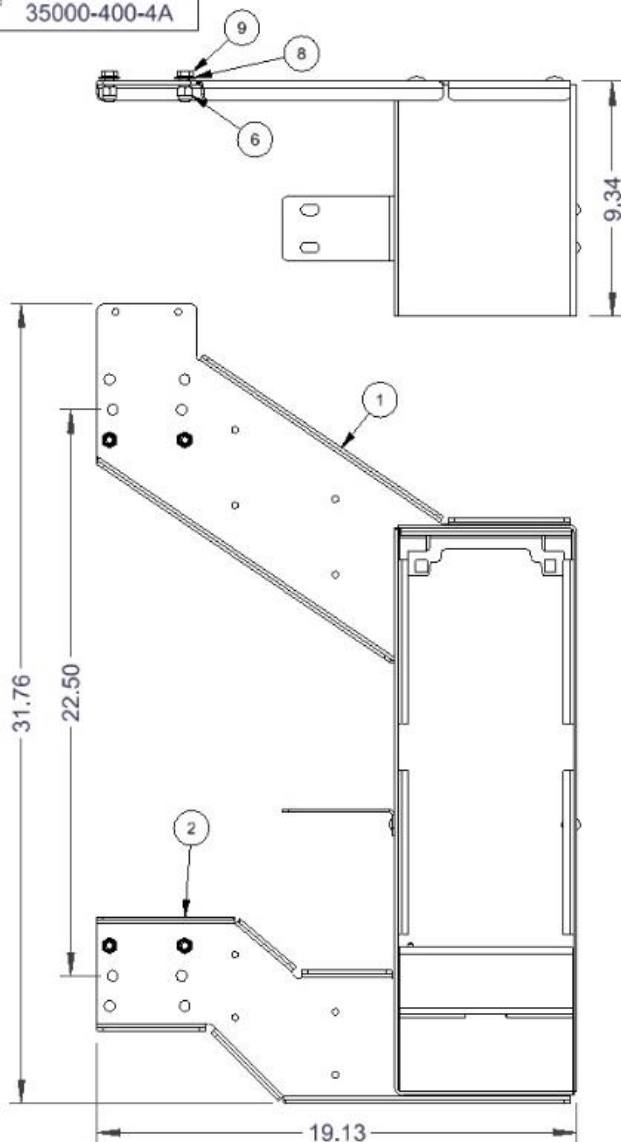

- NOTES:
 1. PACKAGE ALL HARDWARE IN BAG.
 2. UNIT WILL NORMALLY SHIP WITH FACE PLATE ASSEMBLY INSTALLED IN ITEM 3

BILL OF MATERIALS

ITEM	PART NUMBER	DESCRIPTION	QTY
1	35000-400-1	BRKT, UPPER SPRT, CV PAY MNT	1
2	35000-400-2	BRKT, LOWER SPRT, CV PAY UNIT	1
3	35000-400-3W	CONTROL BOX WLDMNT, CV PAY	1
4	35000-400-5	BRKT, CV PAY BOX SUPRT	1
5	5603D1	10-24 Std NC Nylock Nut	4
6	5603D3	3/8-16 Std NC Nylock Nut	8
7	5604D1	#10-24 x 1/2 CARR BOLT	4
8	5606D31	WASHER, FLAT 3/8" SAE, SS	4
9	5622D1	3/8-16 UNC x 1 CAP SCREW	4
10	5632D9	BOLT, 3/8-16 X 1.0" CH, SS	4
11	8204RW	COIN BOX, PIN LOCK WELDMNT	1
12	8638	PIN LOCK	1

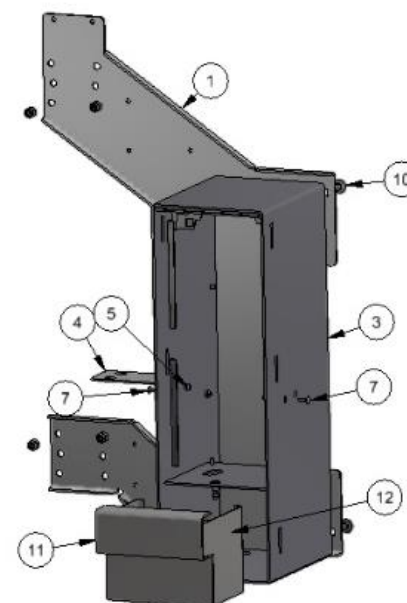

-	8566	RELEASED	4/20/20	MWS
REV	NO.	DESCRIPTION	DATE	BY

THIS DOCUMENT SHALL NOT BE REPRODUCED NOR SHALL THE INFORMATION THEREIN BE USED BY OR DISCLOSED TO OTHERS EXCEPT AS AUTHORIZED BY J.E. ADAMS INDUSTRIES

TITLE: CV PAY BOX ASSEMBLY STD.			
UNSPECIFIED TOLERANCES	MATERIAL	DATE	BY
1 PL ±.030	DATE	2/28/2020	MTWS
2 PL ±.020	SCALE	1 / 1	
3 PL ±.003	SHEET	1 / 1	
ANGLE ± 1°			
J.E. ADAMS INDUSTRIES, LTD.		CEDAR RAPIDS, IOWA	
35000-400-4A		REV: -	

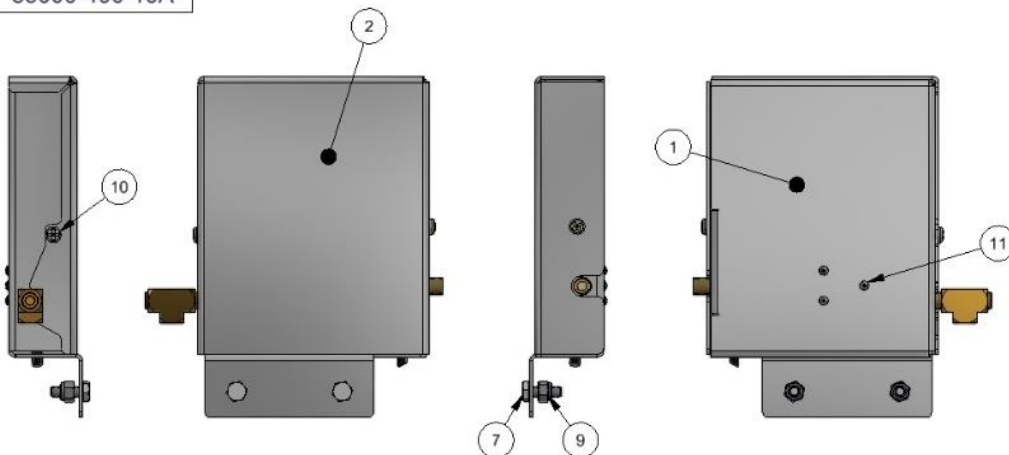

BILL OF MATERIALS			
ITEM	PART NUMBER	DESCRIPTION	QTY
1	35000-400-10W	BRKT, WELD, VALVE MNT, CV PAY	1
2	35000-400-11W	COVER, WELD, VALVE, CV PAY	1
3	35000-400-33	FITTING BREATHER, 1/8 NPT BRASS	2
4	35000-400-V24	VALVE, SOLENOID, 5 PORT 24VAC	1
5	35000-400-VC	CORD, 80", NUMATICS VALVE	1
6	5043	PLUG, 1/8" NPT	2
7	5601D4	1/4-20 x 3/4 HHCS-SS	2
8	5603D15	NUT, 4-40 UNC KEPS	3
9	5603D2	1/4-20 NYLOCK NUT, SS	2
10	5636D1	SCREW, #10-24 X .50, PH, PD, SS	2
11	5666D20	SCREW, #4-40X1.25, PH, PD, SS	3
12	5809D17	1/8 NPT X 3" NIPPLE, BRASS	1
13	5809D18	NIPPLE, 1/8 NPT X 2.0", BRASS	1
14	5813D4	FITTING, TEE, 1/8 FNPT, BRASS	1

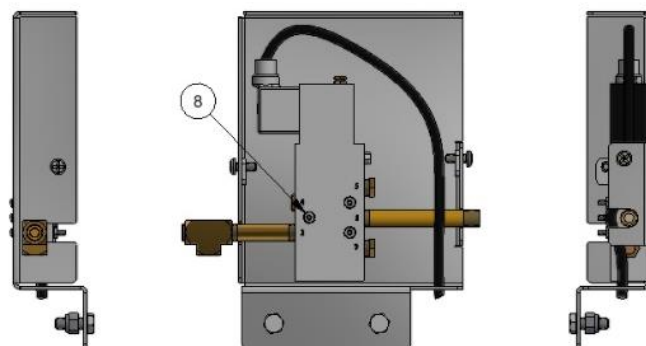

NO COVER SHOWN
SCALE .25

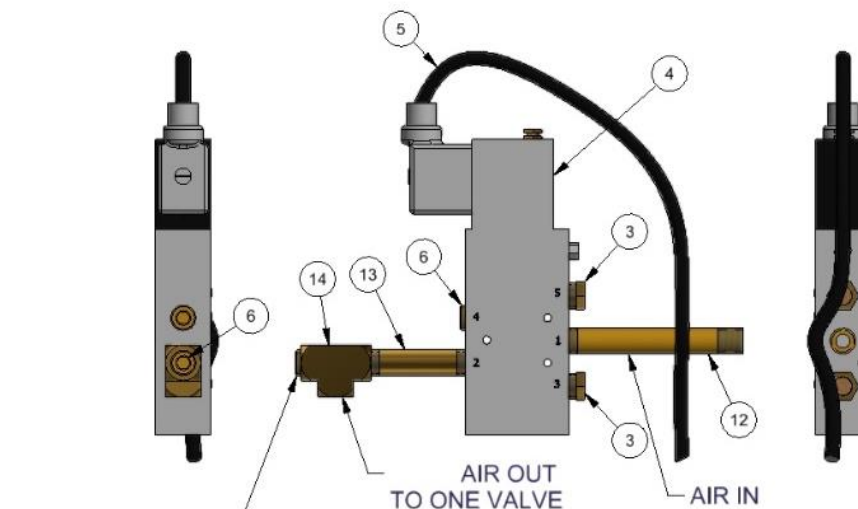
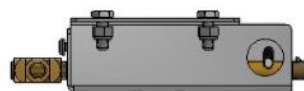

IF CONTROLLING
TWO VALVES
REMOVE PLUG AND
CONNECT 2ND VALVE

VALVE PLUMBING:
PORT 1: INCOMING PRESSURE 45-90PSI MAX
PORT 2: CONTROLLED AIR OUT TO VALVES
PORT 3: NOT USED (BREATHER)
PORT 4: MUST BE PLUGGED
PORT 5: NOT USED (BREATHER)

-	8566	RELEASED	4/20/20	MWS
REV	NO.	DESCRIPTION	DATE	BY

THIS DOCUMENT SHALL NOT BE REPRODUCED NOR SHALL THE INFORMATION THEREIN BE USED BY OR DISCLOSED TO OTHERS EXCEPT AS AUTHORIZED BY J.E. ADAMS INDUSTRIES

TITLE			
AIR VALVE ASY, 2 VALVE, CV PAY			
UNSPECIFIED TOLERANCES	DATE	BY	REV.
1 PL ±.030	3/9/2020	MWS	
2 PL ±.020			
3 PL ±.003			
ANGLE ±1°			
SCALE .25	SHEET 1 / 1	PART NO 35000-400-10A	REV. -



NOTES:

1. SEE S35000-400-20A SCHEMATIC FOR WIRING DIRECTION.

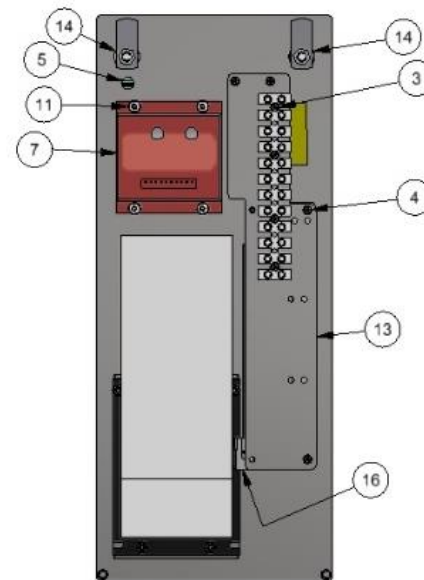
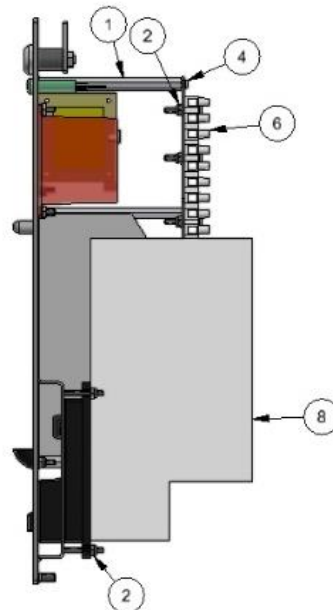
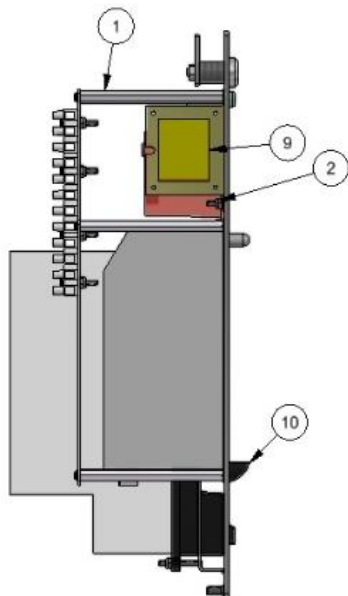
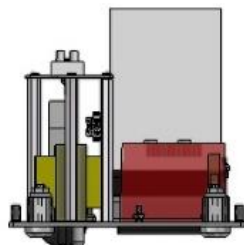

BILL OF MATERIALS			
ITEM	PART NUMBER	DESCRIPTION	QTY
1	5000D5	STAND-OFF, 6-32	4
2	5603D10	NUT NYLOCK, #6-32, SS	11
3	5627D1	6-32 x 1.0 PHIL. PAN -MACHINE SCREW	4
4	5662D2	6-32 x 1/2 PHIL. PAN -MACHINE SCREW	4
5	5913D8	LAMP, PANEL MT-3/8, 12V,LED, GRN	1
6	5944D001	TERMINAL STRIP, 12 POLES, 8AWG MAX	1
7	8000-10	DIXMOR DSPY TIMER, LED7 SINGLE FUNCTION	1
8	8130-6	MEI MARS, 110V BILL VALIDATOR	1
9	8131-2	TRANSFORMER, 110/220-24 1.66A	1
10	8149	IMONEX COIN ACCEPTOR	1
11	8157	NUT, #6-32 KEPP NUT STAINLESS	4
12	8900-7VW	FACEPLATE WELDMENT, W/VALI	1
13	8900-82	TERMINAL BRACKET, VAC-SCENT	1
14	8953	MEDECO CAM LOCK W/2 KEYS	2
15	9200-1D-1-10	DECAL, FACEPLATE	1
16	9500-56	CABLE ASY, BILL ACCEPTOR, 30" EXT.	1

-	8566	RELEASED	4/20/20	MWS
REV	NO.	DESCRIPTION	DATE	BY

TITLE			
FACEPLATE ASY, CV PAY, CM, V, LED7			
UNSPECIFIED TOLERANCES		MATERIAL	
1 PL ± .030		DRAWN BY MIKE S	
2 PL ± .020		DATE 11/18/2019	
3 PL ± .003		SCALE	
ANGLE ± 1°		SHEET 1 / 1	
		PART NO. 35000-400-20A	
		REV. -	

THIS DOCUMENT SHALL NOT BE REPRODUCED NOR SHALL THE INFORMATION THEREIN BE USED BY OR DISCLOSED TO OTHERS EXCEPT AS AUTHORIZED BY J.E. ADAMS INDUSTRIES

NOTES:

1. SEE SCHEMATIC S35000-400-21A FOR WIRING DETAILS.

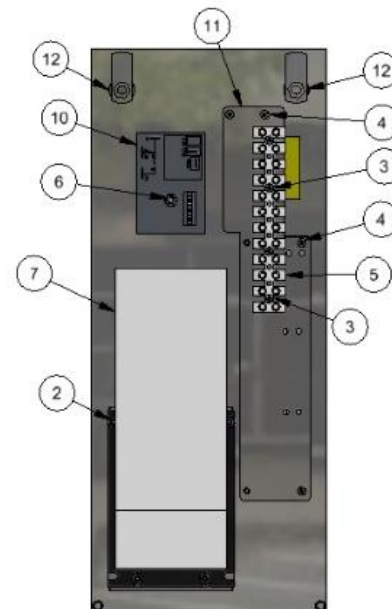
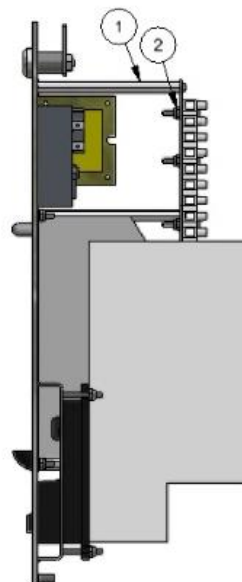
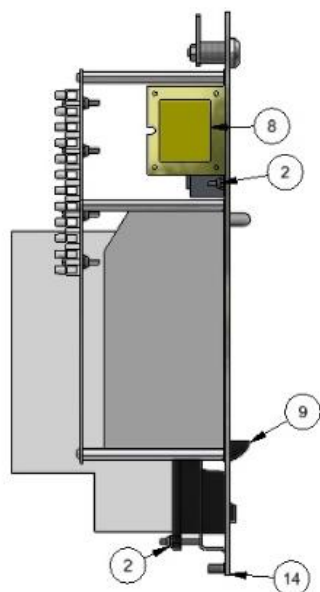
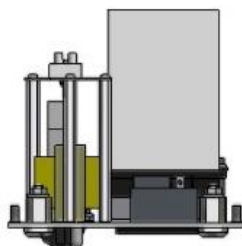
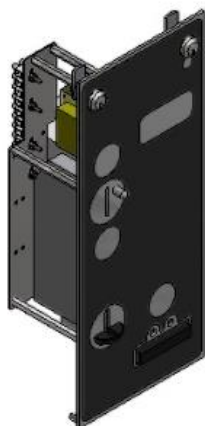

BILL OF MATERIALS

ITEM	PART NUMBER	DESCRIPTION	QTY
1	5000D5	STAND-OFF, 6-32	4
2	5603D10	NUT NYLOCK, #6-32, SS	11
3	5627D1	6-32 x 1.0 PHIL. PAN -MACHINE SCREW	4
4	5662D2	6-32 x 1/2 PHIL. PAN -MACHINE SCREW	4
5	5944D001	TERMINAL STRIP, 12 POLES, BAWG MAX	1
6	8045	8-32 NYLOCK NUT	1
7	8130-6	MEI MARS, 110V BILL VALIDATOR	1
8	8131-2	TRANSFORMER, 110/220-24 1.66A	1
9	8149	IMONEX COIN ACCEPTOR	1
10	8712SS4	SSAC TIMER, 24-240VAC, ACCUMULATING	1
11	8900-82	TERMINAL BRACKET, VAC-SCENT	1
12	8953	MEDECO CAM LOCK W/2 KEYS	2
13	9200-1D-1-10	DECAL, FACEPLATE	1
14	9209-2W	FACEPLATE WELDMENT, SHAMPOO	1

-	8566	RELEASED	4/20/20	MWS
REV	NO.	DESCRIPTION	DATE	BY
THIS DOCUMENT SHALL NOT BE REPRODUCED NOR SHALL THE INFORMATION THEREIN BE USED BY OR DISCLOSED TO OTHERS EXCEPT AS AUTHORIZED BY J.E. ADAMS INDUSTRIES				
UNSPECIFIED TOLERANCES		FACEPLT ASY,CV,SSAC,V		
1 PL ±.030		Cedar Rapids, Iowa		
2 PL ±.020		J.E. ADAMS INDUSTRIES, LTD.		
3 PL ±.003		35000-400-21A		
ANGLE ±1°		REV.		
SCALE .2		-		
SHEET 1 / 1				

ITEM NO.	PART NO.	DESCRIPTION	QTY.
----------	----------	-------------	------

NOTE: FIELD WIRING MUST COMPLY WITH LOCAL AND NATIONAL ELECTRICAL CODES.

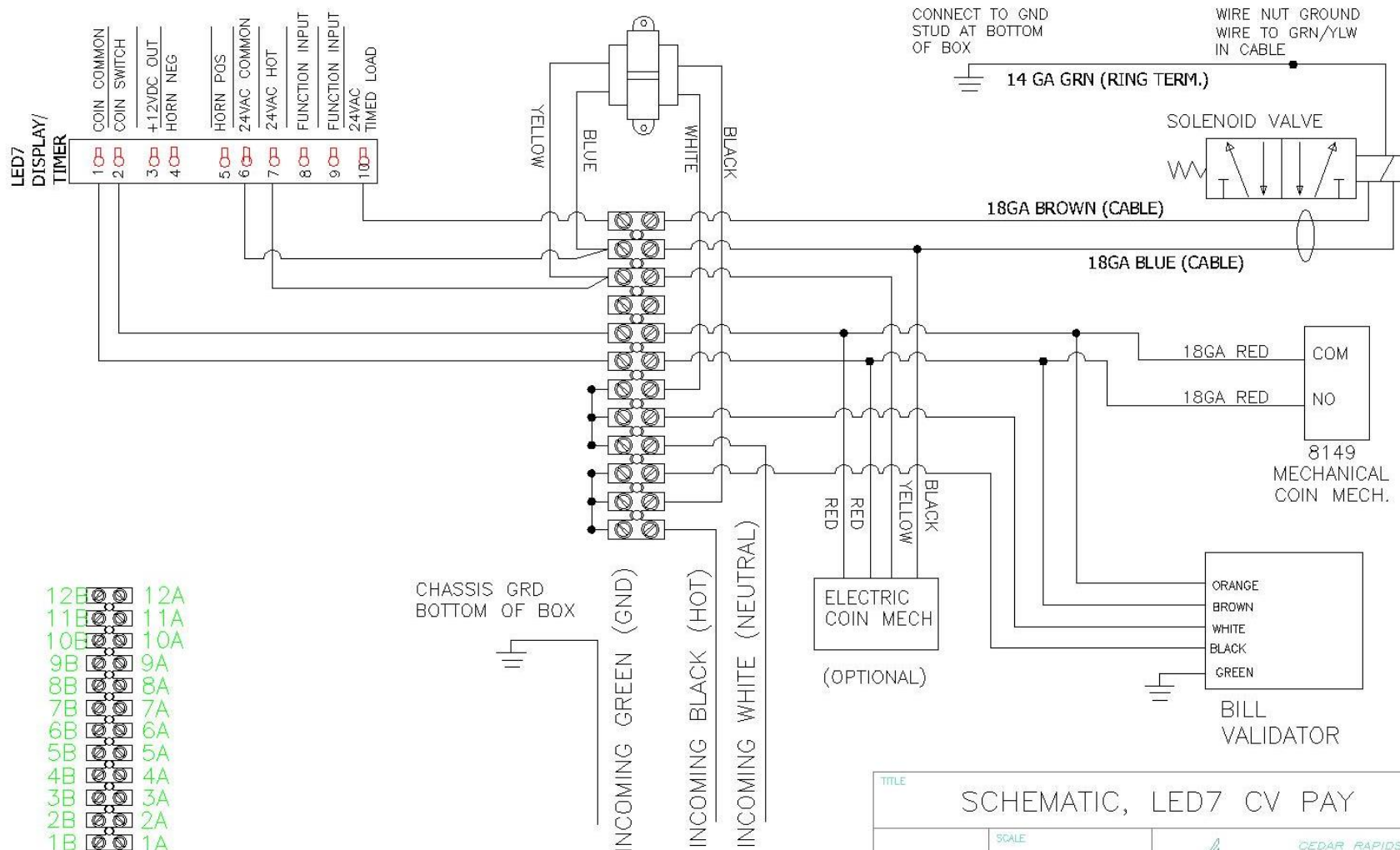



TITLE			
SCHEMATIC, LED7 CV PAY			
UNSPECIFIED TOLERANCES FRACT. $\pm 1/32$ 2 PL $\pm .020$ 3 PL $\pm .010$ ANGLE $\pm 1.0^\circ$	SCALE		
	DRAWN BY MWS		
	DATE 1/20		
	REL. FOR PROD.		
PART NO.		REV.	
S35000-400-20A			

REV	NO.	DESCRIPTION	DATE	BY
-	8566	RELEASED	4/20/20	MWS

ITEM NO.	PART NO.	DESCRIPTION	QTY.
----------	----------	-------------	------

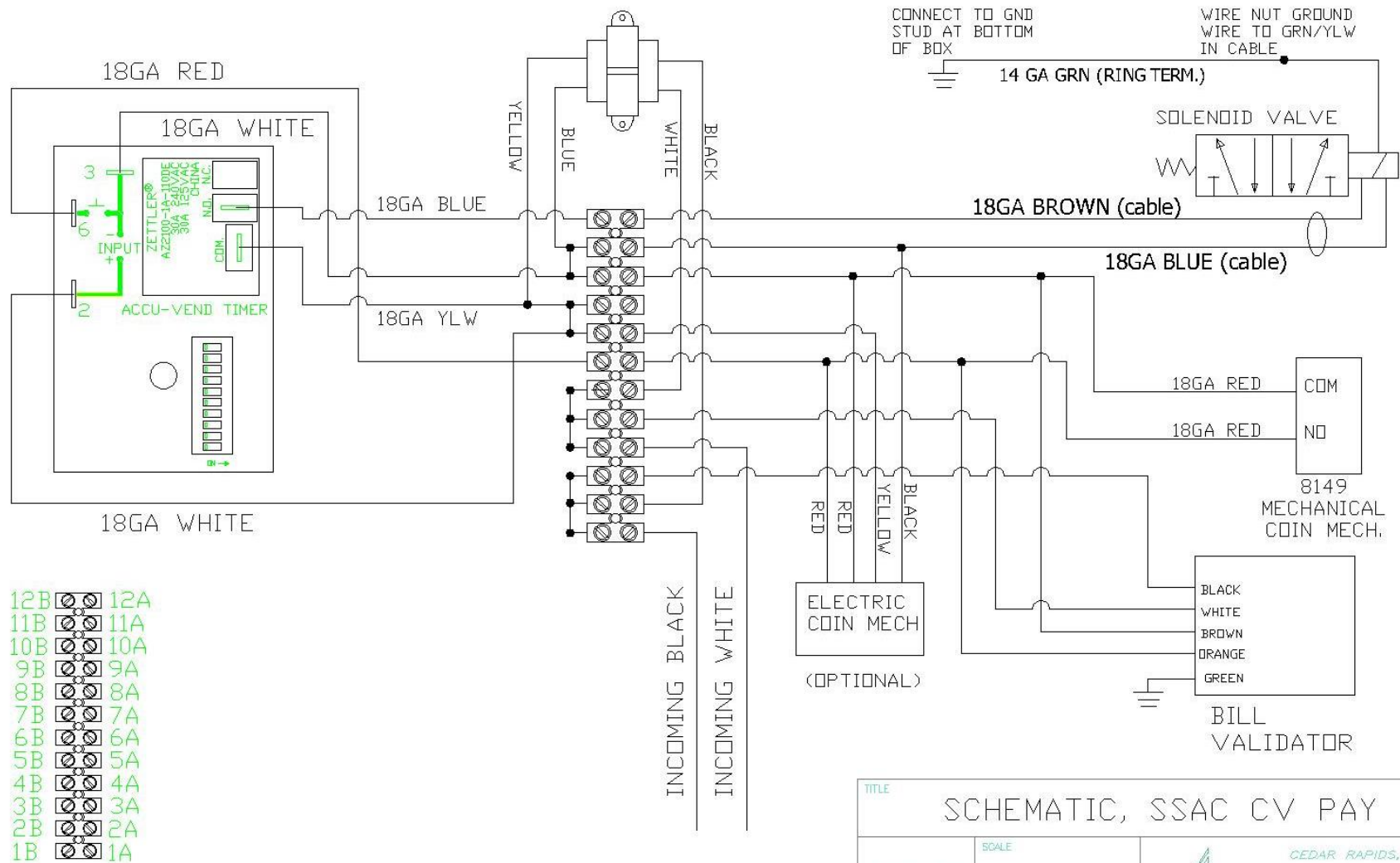
NOTE: FIELD WIRING MUST COMPLY WITH LOCAL AND NATIONAL ELECTRICAL CODES.



TITLE			
SCHEMATIC, SSAC CV PAY			
UNSPECIFIED TOLERANCES FRACT. $\pm 1/32$ 2 PL ± 0.020 3 PL ± 0.010 ANGLE $\pm 1.0^\circ$	SCALE	 CEDAR RAPIDS, IOWA	
	DRAWN BY		
	DATE		
	REL. FOR PROD.		
MWS		1/20	
PART NO.		REV.	
S35000-400-21A		REV 1-1-2020	

-	8566	RELEASED	4/20/20MWS
REV	NO.	DESCRIPTION	DATE BY