

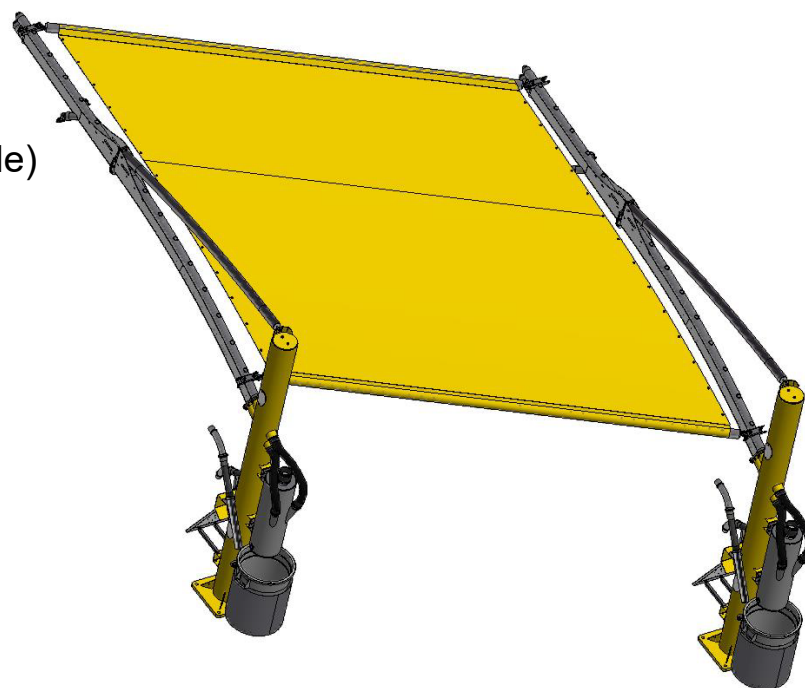

Models- **37000-ACA-_
ANGLED PARKING CANOPY MANUAL**

Page 2	Product Information
Page 3	Specifications
Page 4	Product Dimensions
Page 5	Application (left and right angle)
Page 6-11	Layout Instructions
Page 12-17	37000 Canopy Installation
Page 18	Maintenance
Page 19-21	Parts



PRODUCT INFORMATION

Please take a moment to fill out the information below in order to aid us with any future sales or service inquiries. Model number and serial number information can be found on the serial tag located inside the control box and/or on the lower exterior of the can. Key number can be found on the tag that comes attached to the keys. There may be more than one key number depending on unit.

Please keep this information with your records.

MODEL#: _____

SERIAL#: _____

KEY NUMBER(S): _____

DATE PURCHASED: _____

DISTRIBUTOR: _____

**J.E. Adams Industries
1025 63rd Ave. S.W.
Cedar Rapids, IA 52404
1-800-553-8861
www.jeadams.com**

Specifications

Features:

- Angled canopy system for 37000 series stanchions
- 30 degree angle parking stalls only.
- 12 foot wide parking stall width.
- System can be used for left or right angle parking by flipping canopy.
- All standard accessories for stanchion systems will work with angle parking.

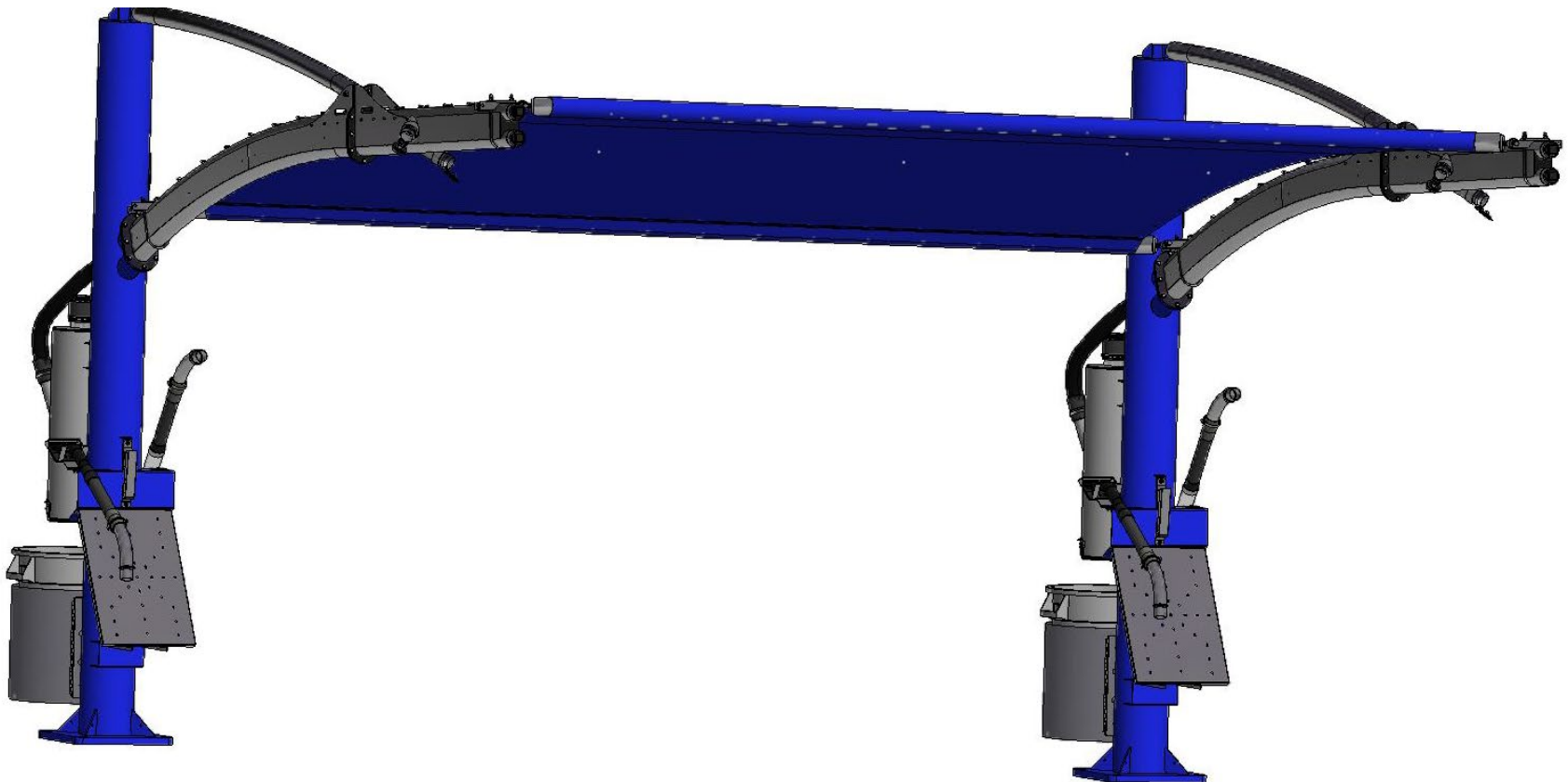

Dimensions

Angle parking canopy is uniquely designed for 12 foot lane spacing and 30 degree angle parking and will not fit other dimensional variations. Layout and assembly of arch system will be critical for proper fit.

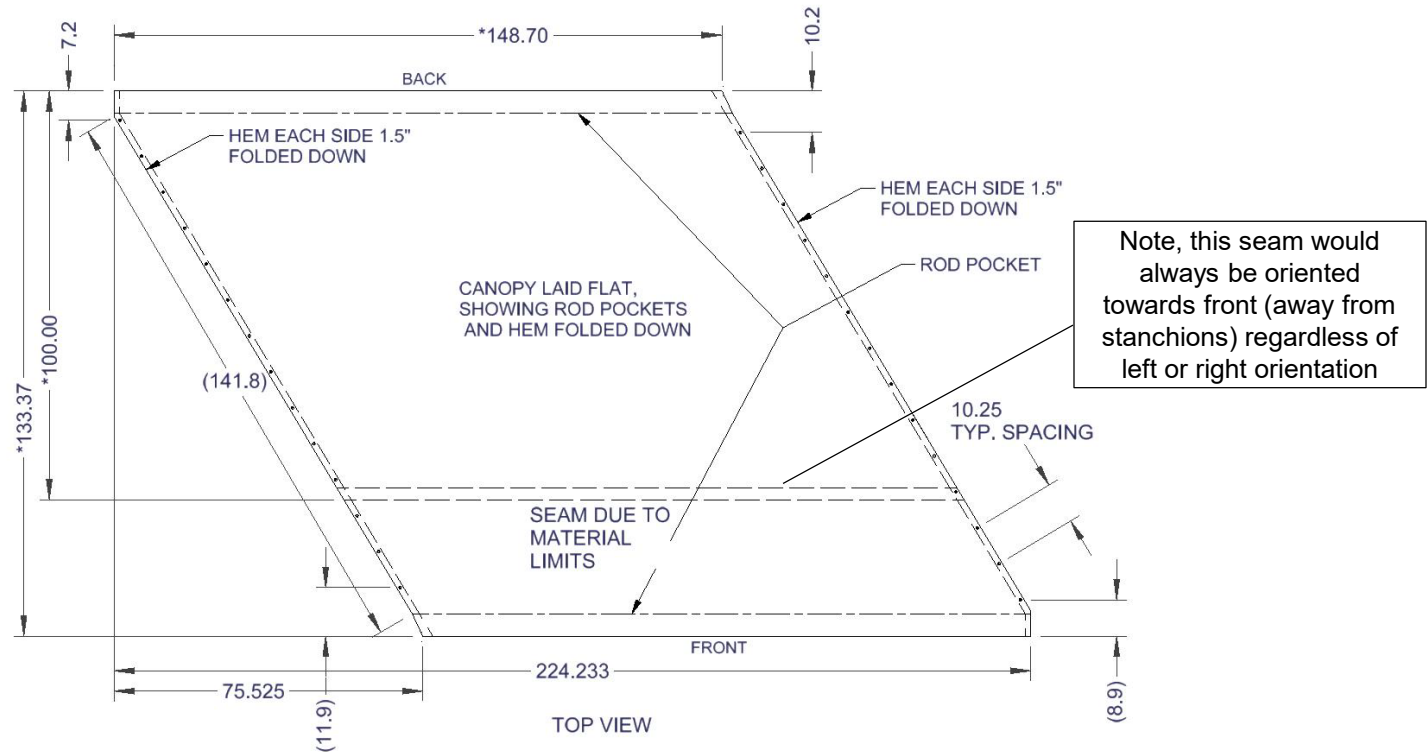

Note: Most of the details in this manual are referencing 30 degree parking angle to the right if on the street facing the curb. This system can be used for left angle parking as well by simply turning over canopy so edge seams are facing up. All dimensional information would simply be mirrored.

Application Considerations

RIGHT

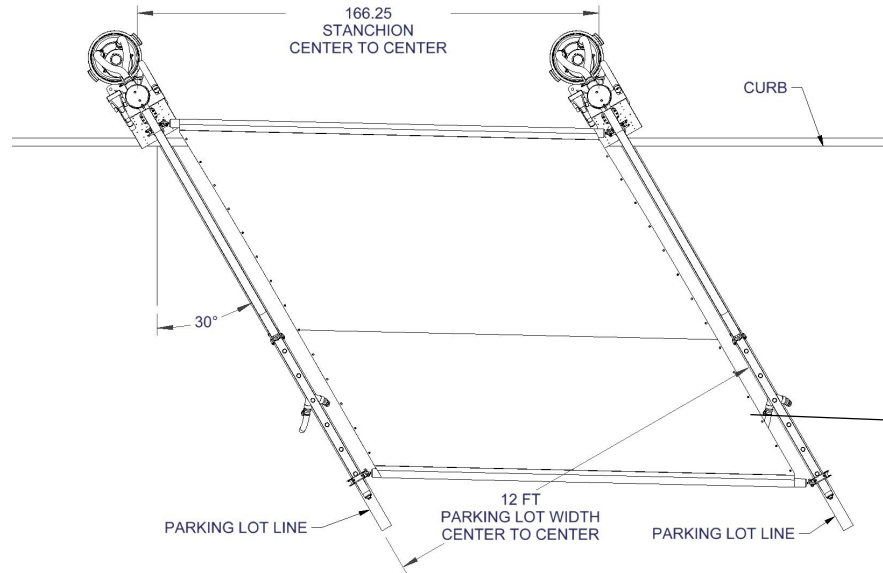

This orientation is consider right hand angled parking

Perimeter edge seams are down

TOP VIEWS

LEFT

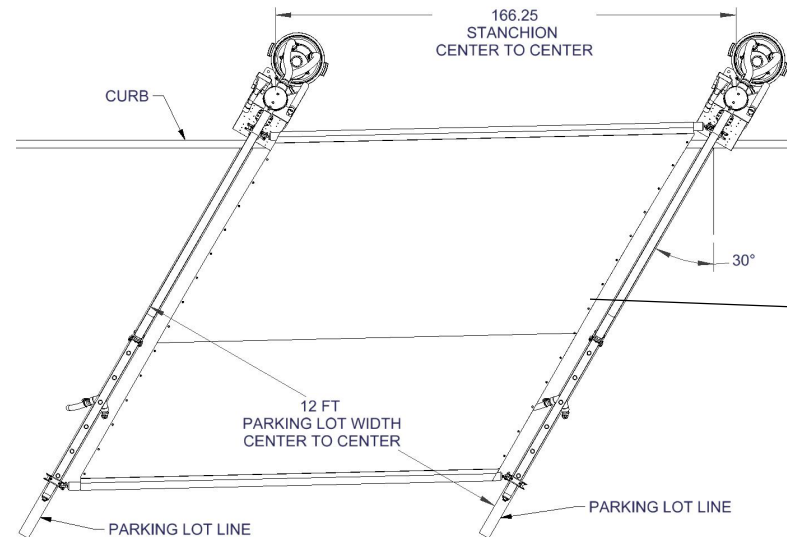

This orientation is consider left hand angled parking

Perimeter edge seams are up

Layout Considerations

CRITICAL STANCHION SPREAD INFORMATION

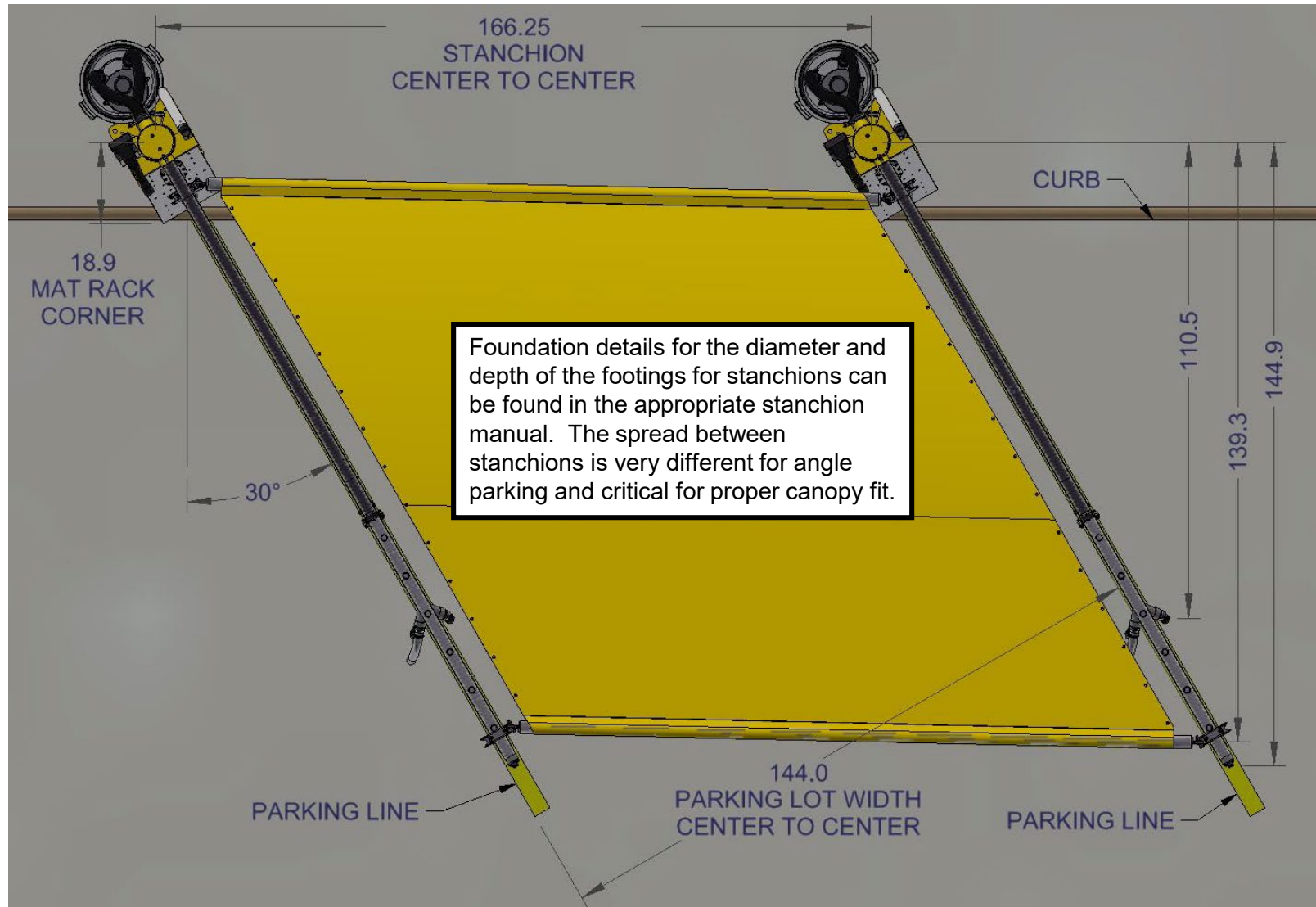

LAYOUT DIRECTIONS

USING 35000-79W-CFPA J BOLT HOLDING GUIDE CAN MAKE LAYOUT EASIER AS IT IS CRITICAL STANCHIONS BE ORIENTED 30 DEG. CONSISTANTLY AND SPACED AT 166.25". DETAILS OF THE FOOTINGS SUGGESTED CAN BE FOUND IN THE APPLICABLE STANCHION MANUAL.

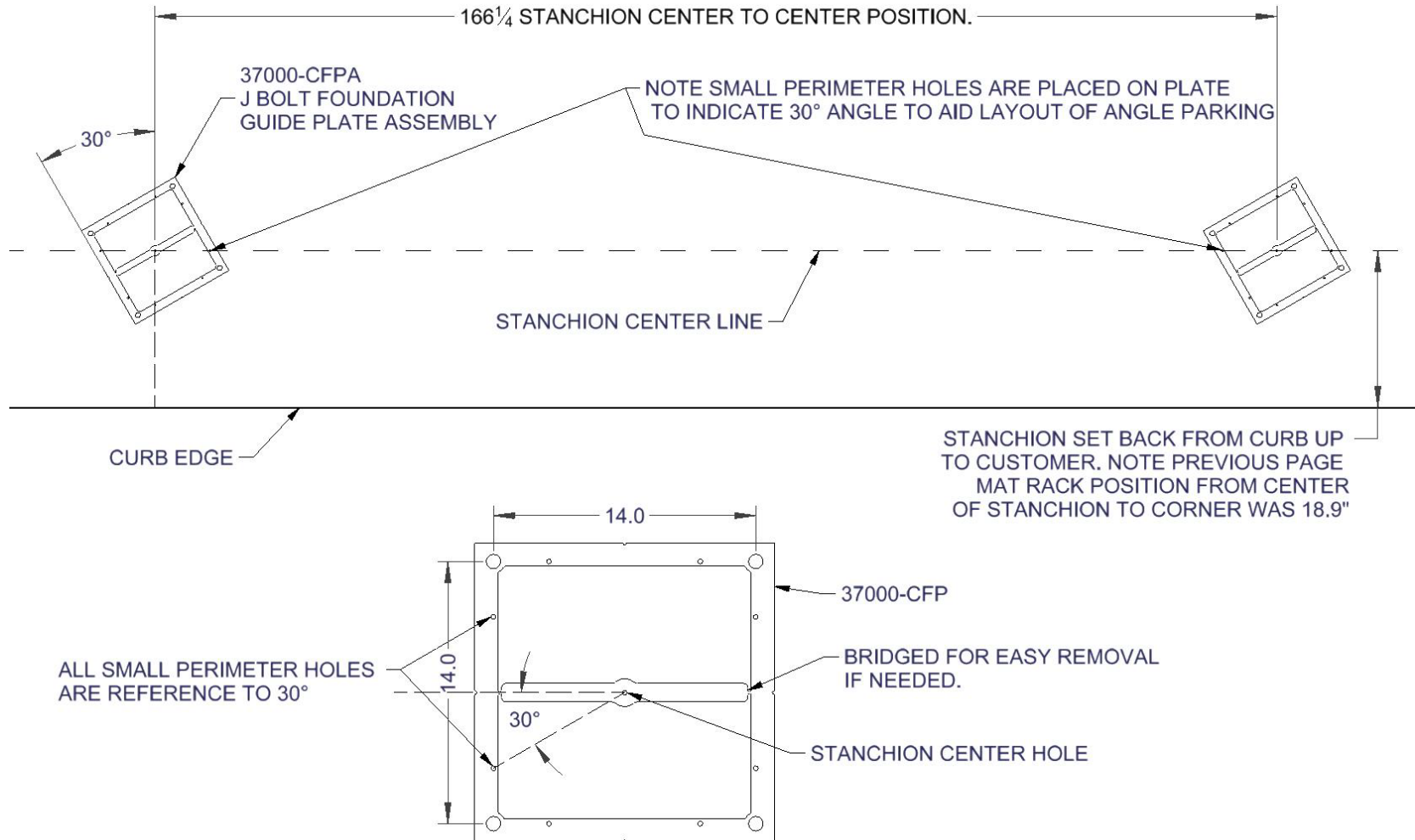

VERIFICATION OF ARCH POSITION: 37000 Series

Due to complication of angle canopy fit it will be very beneficial for installer to verify layout and arch position before installing canopy. **This would be done once stanchions and arches are installed per standard manual for 37000-1A DOUBLE ARCH manual.**

End arch height can be adjusted at top of stanchion, see 37000-1A Double Arch manual before adjusting. The height difference is mostly an aesthetic issue and will have little impact on measurements on next page.

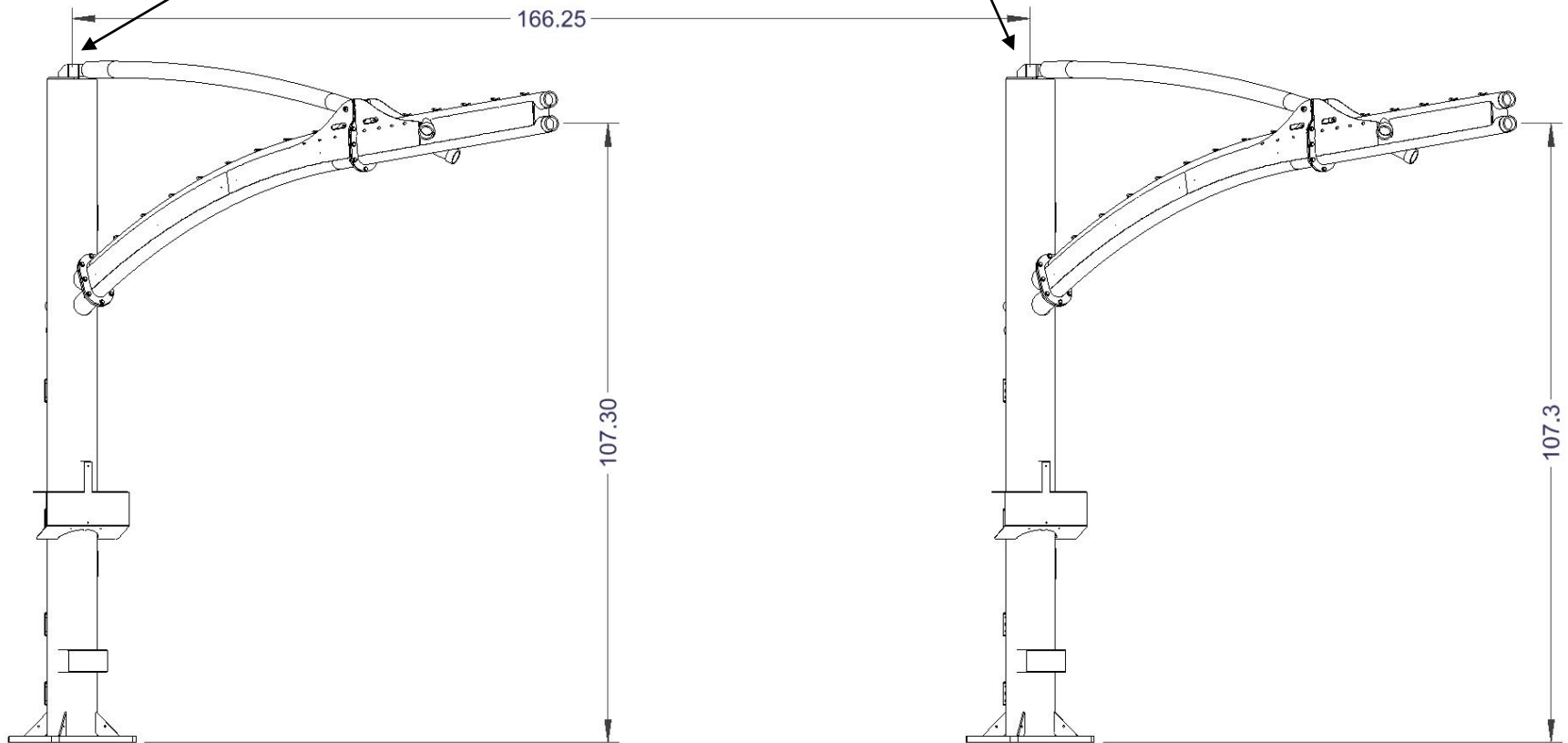

VERIFICATION OF ARCH POSITION: 37000 Series

Step 1 -- Verify 166.25" arch center to center at stanchion

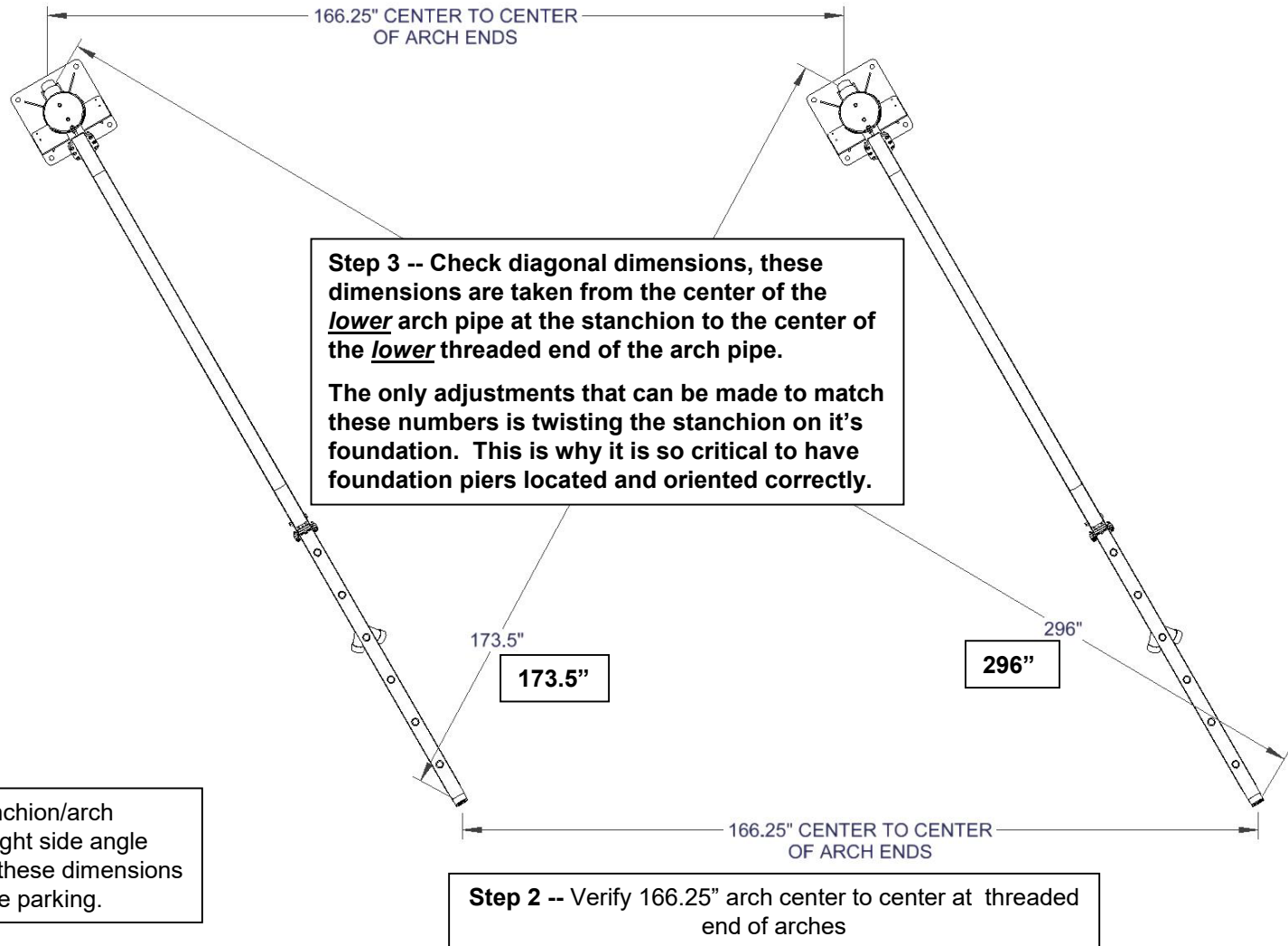

Top view of stanchion/arch assembly with right side angle parking. Mirror these dimensions for left side angle parking.

VERIFICATION OF ARCH POSITION EXAMPLE 1

Below are illustrations of how the arch position measurements shall be taken. Example is of a 35000 setup. Use appropriate dimension for setup at site.

Step 3 Measurement – Long Diagonal

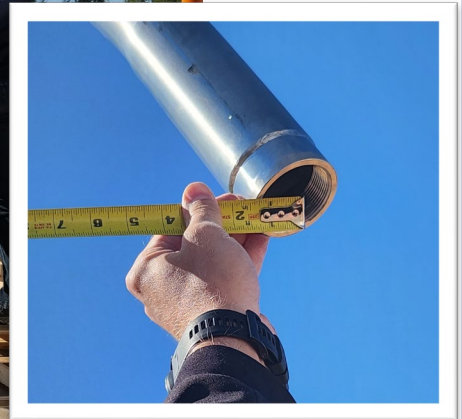

VERIFICATION OF ARCH POSITION EXAMPLE 2

Below are illustrations of how the arch position measurements shall be taken. Example is of a 35000 setup. Use appropriate dimension for setup at site.

Step 3 Measurement – Short Diagonal



37000 SERIES Canopy Installation – USE 2 PEOPLE!

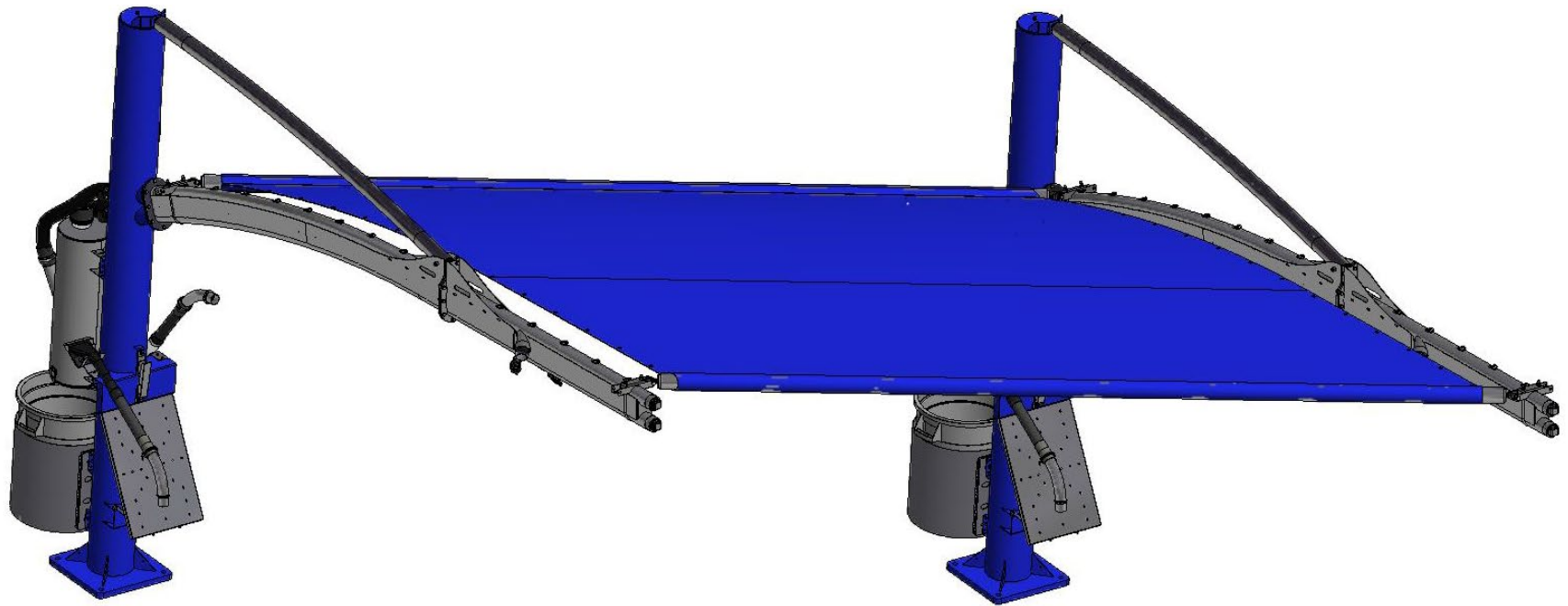

Canopy Installation – USE 2 PEOPLE!

Step 1 – U-Bolt Canopy bracket to double arch, just in front of first welded loop using 3/8" flat washer and 3/8"-16 Nylock nut. Repeat at front of other arch

37000-149-6W
Canopy bracket

The canopy has an orientation, there is a front and rear, review page 4 of this manual.

Step 3 – Slide Support tube into sleeve at end of canopy. Note orientation of canopy for front and left or right angle. See page 4 for correct canopy orientation.

DETAIL A
SCALE .15

Step 2 – Thread heim joints into each end of canopy support tube equally. Note heim joints come in left and right hand thread. Tube should have left and right hand threaded ends. Orientation of tube doesn't matter. There should be approximately 1.5" from center of heim ball to face of support tube exposed.

Front

37000-149-11W
Canopy Supt Tube

Rear

Canopy Installation – USE 2 PEOPLE!

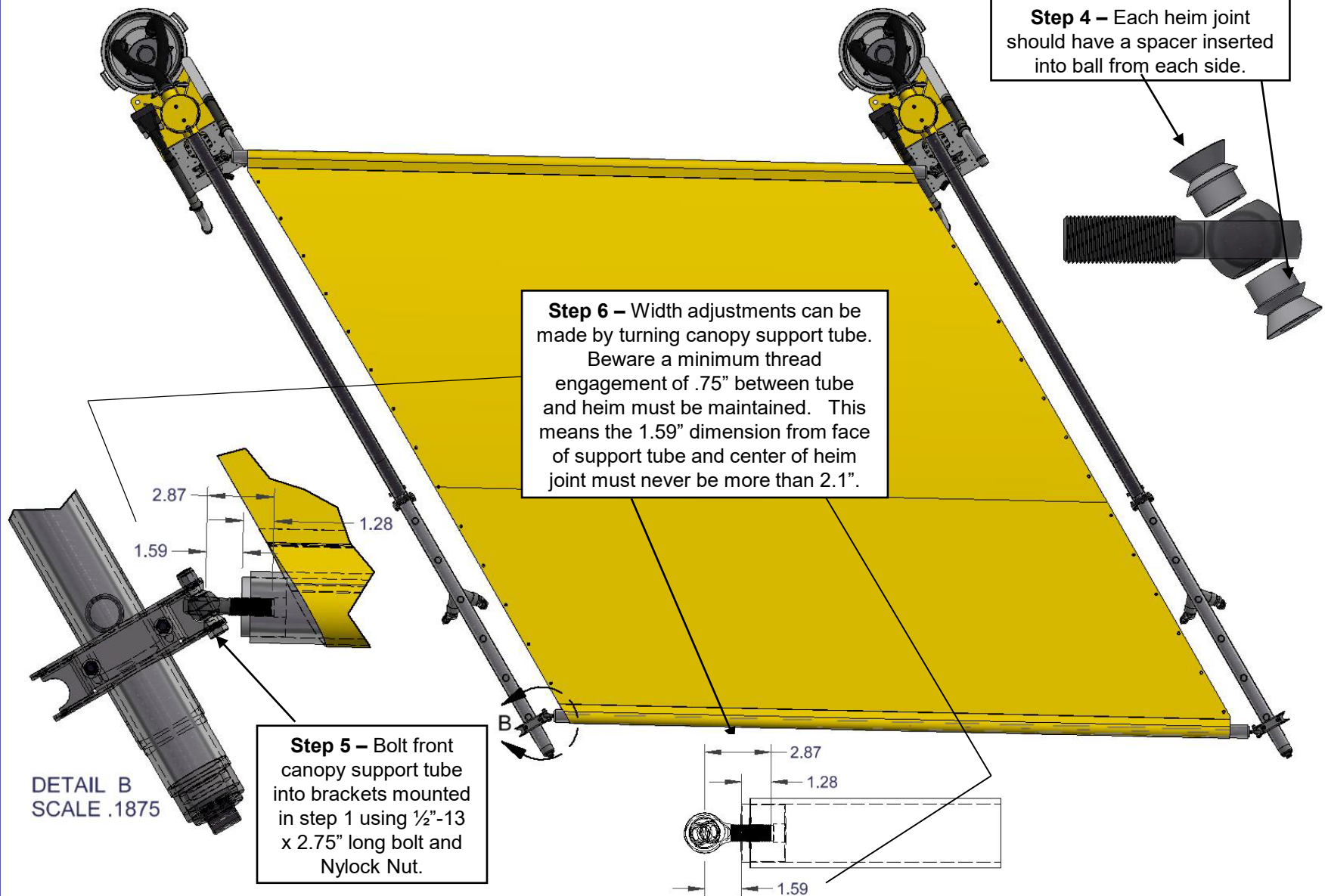

Canopy Installation – USE 2 PEOPLE!

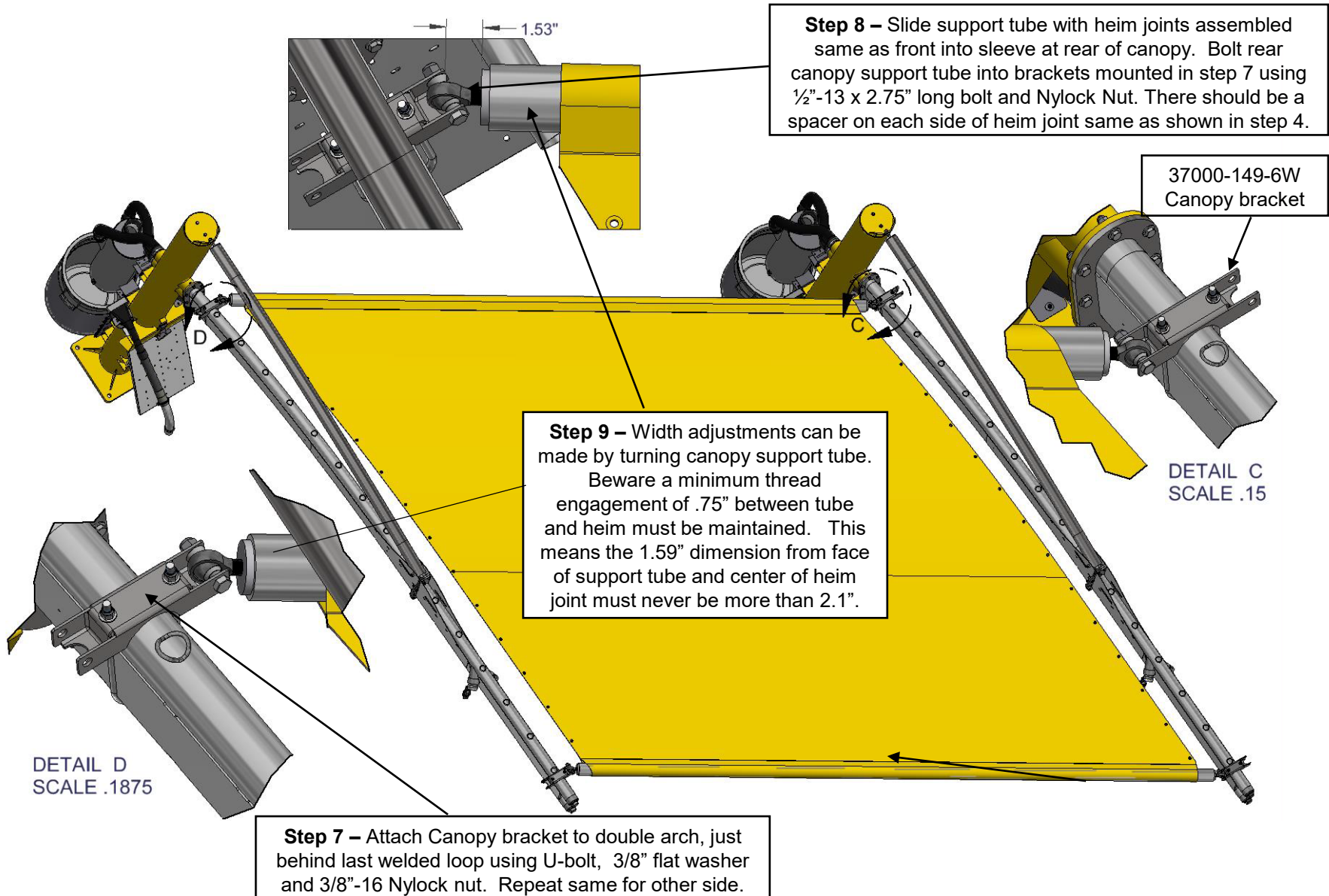

Canopy Installation – USE 2 PEOPLE!

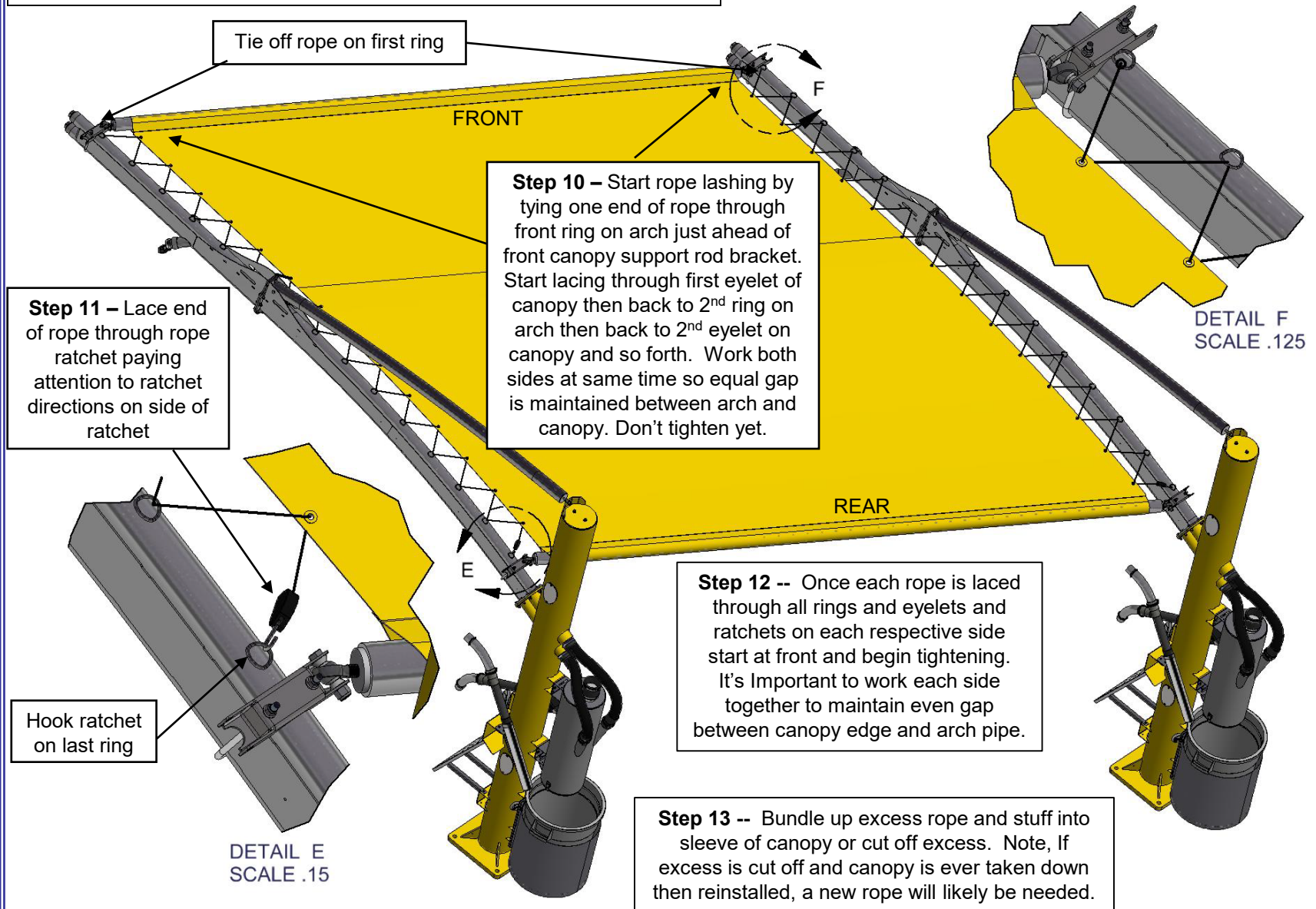

Canopy Installation – USE 2 PEOPLE!

Warning! Canopies must be removed during severe weather. High winds, snow or ice loads could collapse structure.

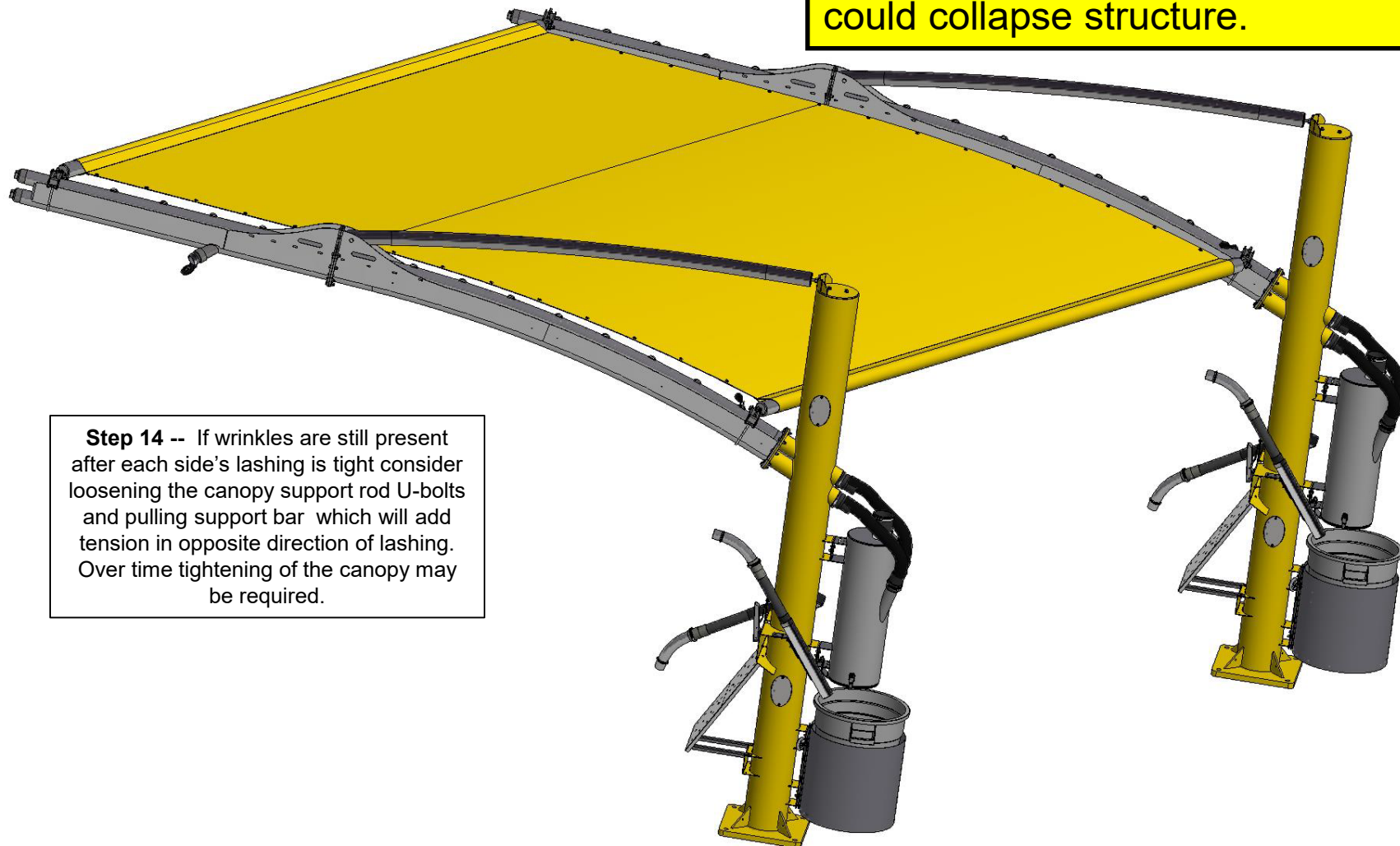

Step 14 -- If wrinkles are still present after each side's lashing is tight consider loosening the canopy support rod U-bolts and pulling support bar which will add tension in opposite direction of lashing. Over time tightening of the canopy may be required.

Maintenance:

- Nuts and bolts on structure should be checked once a month or as needed.
- Fabric canopies should be taken down before severe weather situations.
- Powder coated parts will wear over time. JE Adams offers touch up paint to keep your parts looking great.
- Stainless steel parts should be wiped/ cleaned as needed.
- Rope lashing shall be inspect monthly for loosening and for excessive wear. PN 35000-149-8 (Rope and Ratchet) should be ordered from JE Adams if replacements are required.

PART NO.

37000-ACA-_

* Suffix Part # List

Top Level Part	Item #	PART #	CHERRY RED	AQUATIC BLUE	YELLOW	GREEN	CUSTOM
37000-ACA-_			R	B	Y	G	CU
	5	37000-149-ACA-_	R	B	Y	G	CU

NOTES:

1. CANOPY FOR 37000 SERIES STANCHION ASSEMBLIES, 30° ANGLE PARKING AND 12FT WIDE PARKING SPACE. THIS CONFIGURATION IS CONSIDERED RIGHT SIDE ANGLE PARKING, SEAM IS DOWN IN THIS ORIENTATION. FOR LEFT SIDE ANGLE PARKING EDGE SEAMS WOULD BE UP.
SEE PAGE 2 FOR DETAILS
2. HEIM BALL JOINTS ARE LEFT AND RIGHT THREAD SO EACH ROD (ITEM 7) SHOULD HAVE 1 LEFT HAND AND 1 RIGHT HAND THREADED END.

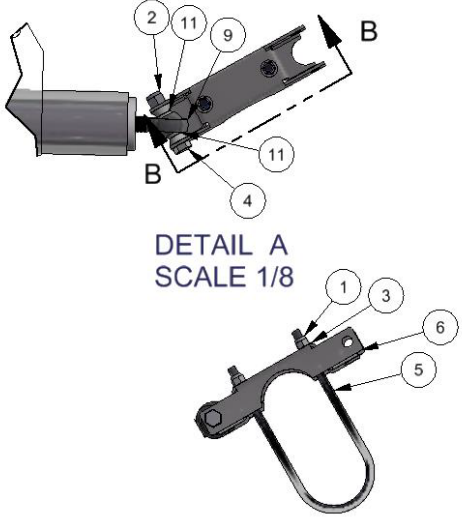
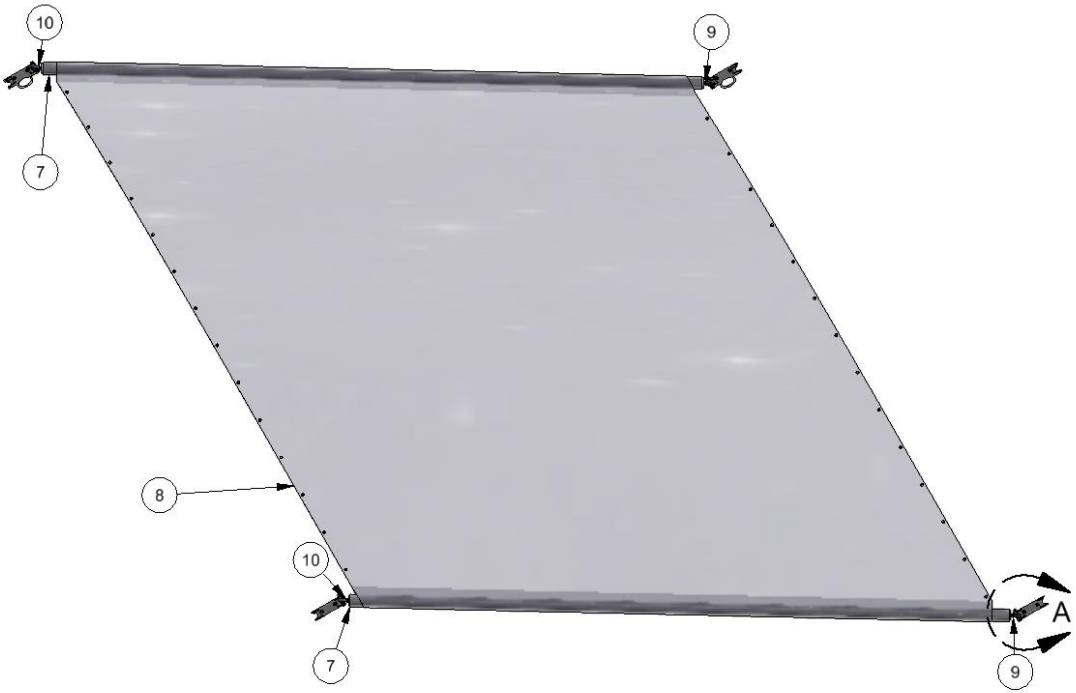

BILL OF MATERIALS

ITEM	PART NUMBER	DESCRIPTION	QTY
1	5603D3	NUT, 3/8-16 Nylock, SS	8
2	5603D4	1/2 Std NC Nylock Nut	4
3	5606D31	WASHER, FLAT 3/8" SAE, SS	8
4	5646D11	BOLT, 1/2-13 X 2.75",HH, HD, SS	4
5	5733D3	U-BOLT, 3.125"ID X 3/8" X 6.75"L SS	4
6	37000-149-6W	WLDMNT, BKT, 37K ACA ARCH TO CANOPY ROD	4
7	37000-149-11W	WLDMNT, 37K ANGLE CANOPY CROSS BAR	2
8	37000-149-ACA-_	CANOPY, D STACK ARCH, 12FT ACA	1
9	37000-AC-2L	HEIM JOINT, 3/4-16 X 3/4 CENTER, LH	2
10	37000-AC-2R	HEIM JOINT, 3/4-16 X 3/4 CENTER, RH	2
11	37000-AC-3	BALL JOINT SPACER 3/4 X 1/2	8
12	35000-149-8	3/16IN ROPE RATCHET W/S-HOOK & 40FT OF 3/16 ROPE	2

-	9132	RELEASED	3/6/24	MWS
REV	NO.	DESCRIPTION	DATE	BY

THIS DOCUMENT SHALL NOT BE REPRODUCED NOR SHALL THE INFORMATION THEREIN BE USED BY OR DISCLOSED TO OTHERS EXCEPT AS AUTHORIZED BY J.E. ADAMS INDUSTRIES

TITLE		37000 CANOPY ASY 30DEG, 12FT ANGLE PARKING	
UNSPECIFIED TOLERANCES		MATERIAL	
1 PL ± .030		DRAWN BY BJL	
2 PL ± .020		DATE 5/19/2023	
3 PL ± .003		SCALE .025	
ANGLE ± 1°		SHEET 1 / 2	
		PART NO. 37000-ACA-_	
		REV. -	

CEDAR RAPIDS, IOWA

J.E. ADAMS INDUSTRIES, LTD.

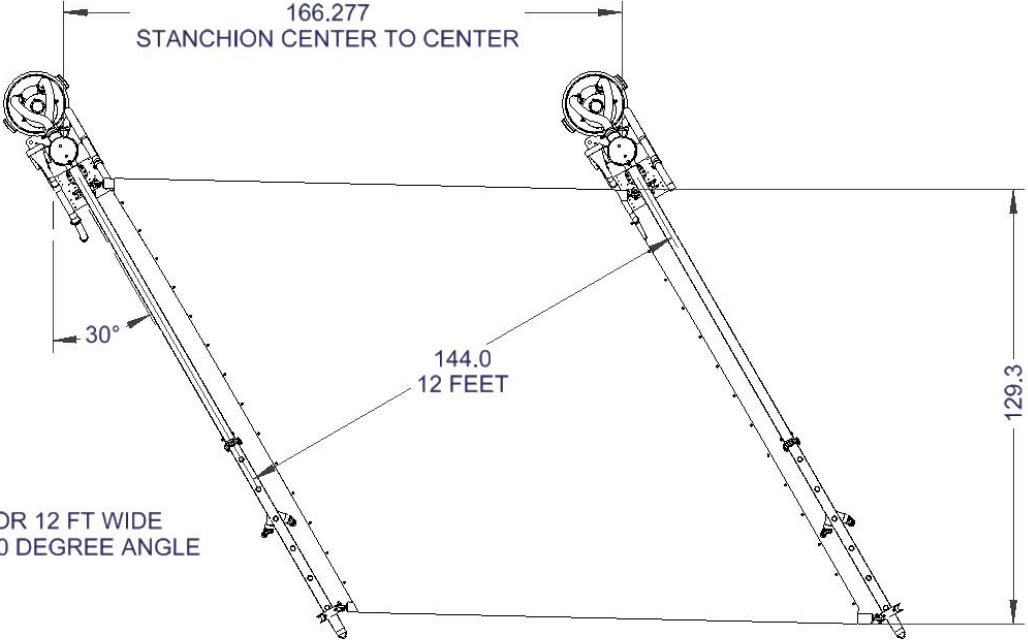

CANOPY DESIGNED FOR 12 FT WIDE
PARKING SPACE ON 30 DEGREE ANGLE

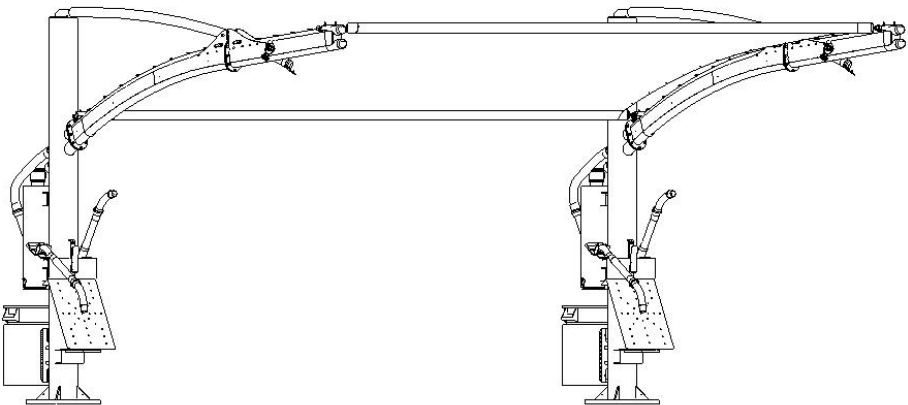

TITLE 37000 CANOPY ASY 30DEG, 12FT ANGLE PARKING			
UNSPECIFIED TOLERANCES		MATERIAL	
1 PL ±.030	BY BJJ		
2 PL ±.020	DATE 5/19/2023		
3 PL ±.003	SCALE .025	SHEET 2 / 2	PART NO 37000-ACA-
ANGLE ± 1°			REV -

REV	NO.	DESCRIPTION	DATE	BY
THIS DOCUMENT SHALL NOT BE REPRODUCED NOR SHALL THE INFORMATION THEREIN BE USED BY OR DISCLOSED TO OTHERS EXCEPT AS AUTHORIZED BY J.E. ADAMS INDUSTRIES				

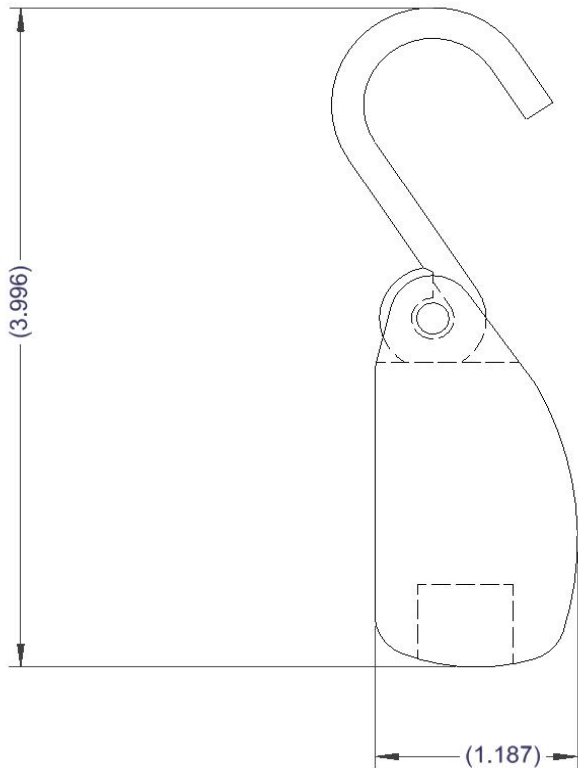

A	9021	ROPE LENGTH 40' WAS 20', CHANGED TO ACCOMODATE 37000 SERIES	6/2/23	BJL
-	8932	RELEASED	11/16/22	BJL
REV	NO.	DESCRIPTION	DATE	BY

THIS DOCUMENT SHALL NOT BE REPRODUCED NOR SHALL THE INFORMATION THEREIN BE USED BY OR DISCLOSED TO OTHERS EXCEPT AS AUTHORIZED BY J.E. ADAMS INDUSTRIES

TITLE				
3/16 INCH ROPE RATCHET W/S-HOOK & 40FT OF 3/16 ROPE				
UNSPECIFIED TOLERANCES	MATERIAL	Generic		
	DRAWN BY	BJL		
	DATE	11/16/2022		
	3 PL ±.003			
ANGLE ± 1°	SCALE 1:1	SHEET 1 / 1	PART NO 35000-149-8	REV. A

