

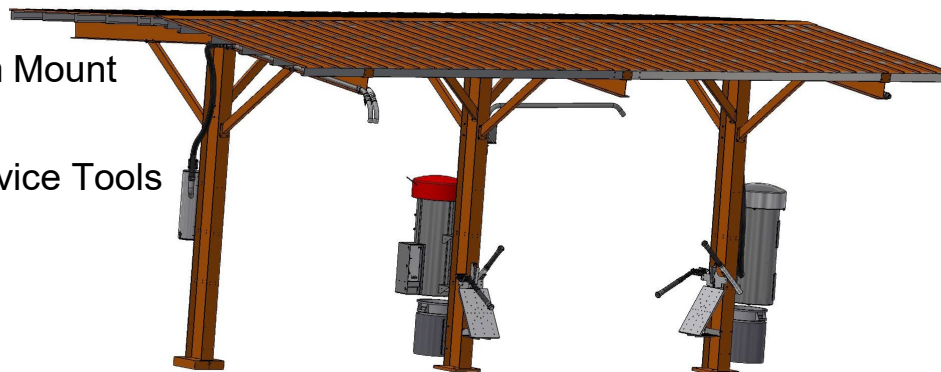

Models- **43000 Oasis Shelter Accessories**

Page 2	Product Information
Page 3	Accessories List
Page 4-5	Pre-Collector, Vacuum Mount
Page 6	Trash Can
Page 7-8	Mat Rack, Claw & Crevice Tools
Page 9	Vacuum Sign
Page 10	Base Covers
Page 11	Overhead Lights
Page 12	Overhead Vacuum Tube
Page 13	Overhead Vacuum Pipe
Page 14	Maintenance
Page 15-27	Parts



PRODUCT INFORMATION

Please take a moment to fill out the information below in order to aid us with any future sales or service inquiries. Model number and serial number information can be found on the serial tag located inside the control box and/or on the lower exterior of the can. Key number can be found on the tag that comes attached to the keys. There may be more than one key number depending on unit.

Please keep this information with your records.

MODEL#: _____

SERIAL#: _____

KEY NUMBER(S): _____

DATE PURCHASED: _____

DISTRIBUTOR: _____

**J.E. Adams Industries
1025 63rd Ave. S.W.
Cedar Rapids, IA 52404
1-800-553-8861
www.jeadams.com**

Accessories

Accessory List:

- Various models of Vacuums
- Pre-collector for Central Vacuum applications
- Trash Can
- Mat Rack
- Claw and Crevice Tool

Accessory List:

- Backlit Vacuum Sign
- Base covers
- LED Overhead Lights, 6FT, 8FT
- Overhead Vacuum Tube kit
- Overhead Vacuum Pipe kit

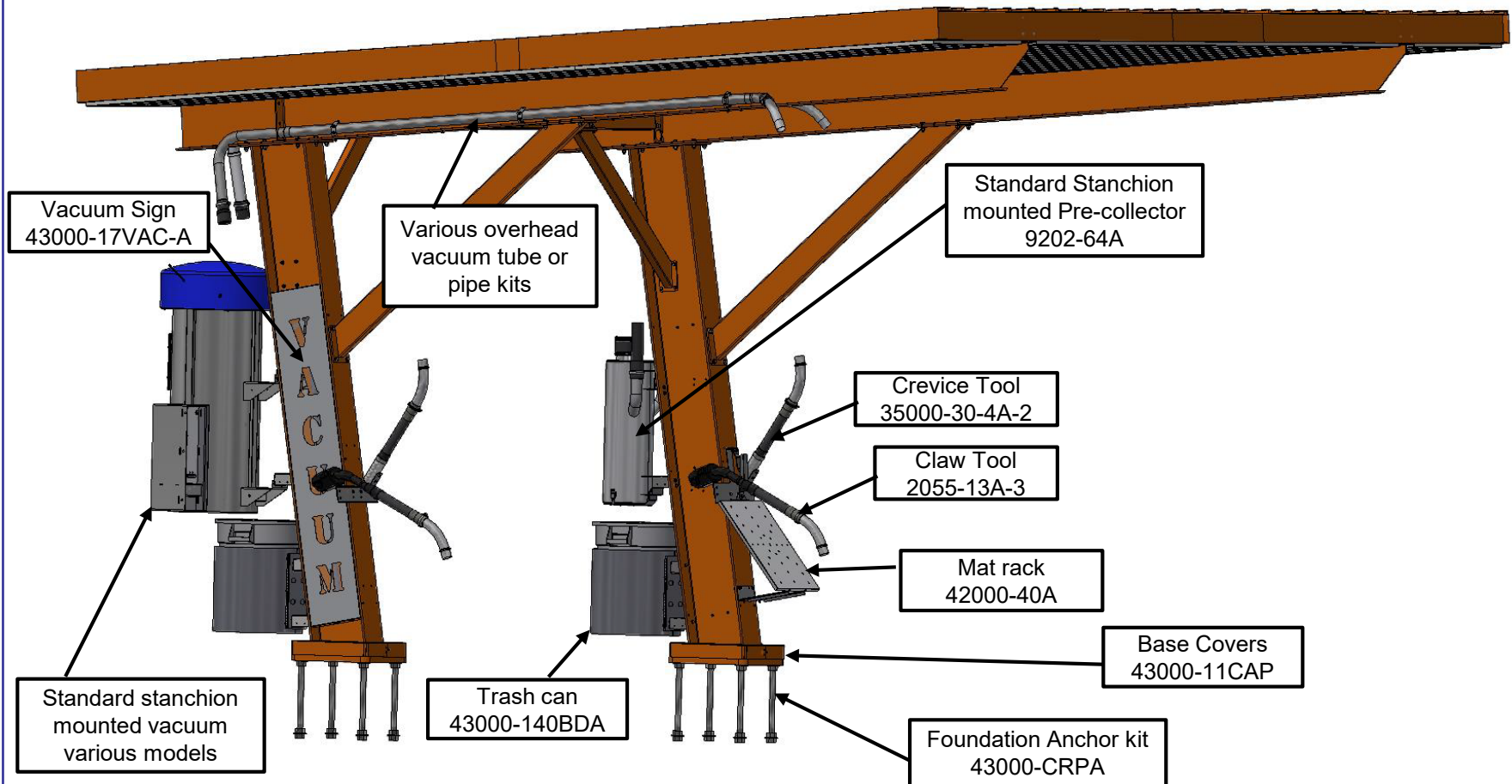

Pre-Collector/ Vacuum Mounting 43000-9202A Mounting Brackets

Vacuum and pre-collector mount same way,
both utilize 43000-9202A mounting kit which
has an upper and lower brackets

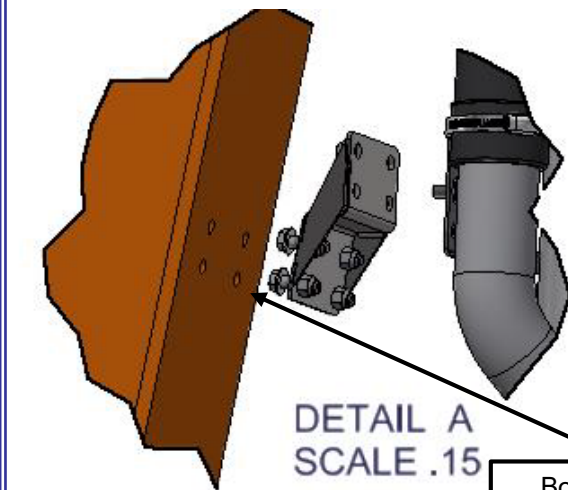

Bolt Adapter brackets to I beam using 3/8" x 1.25" long hex bolts, flat washers and Nylock nuts. Washers should always be against painted surface. Lower bracket is about 37.5" up from ground, upper bracket is about 57" up.

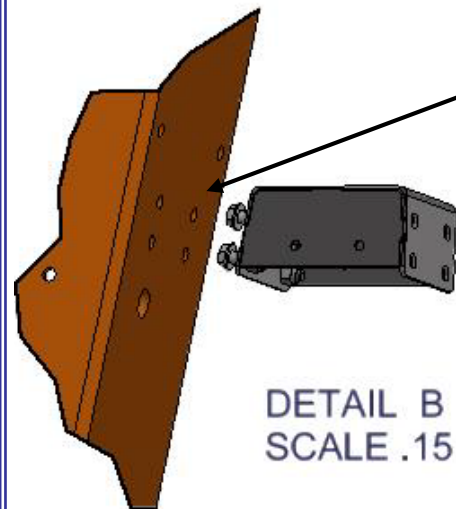

Bolt vacuum or pre-collector to adapter brackets using 3/8" x .75" long security bolts and nylock nuts that come with vacuum or pre-collector

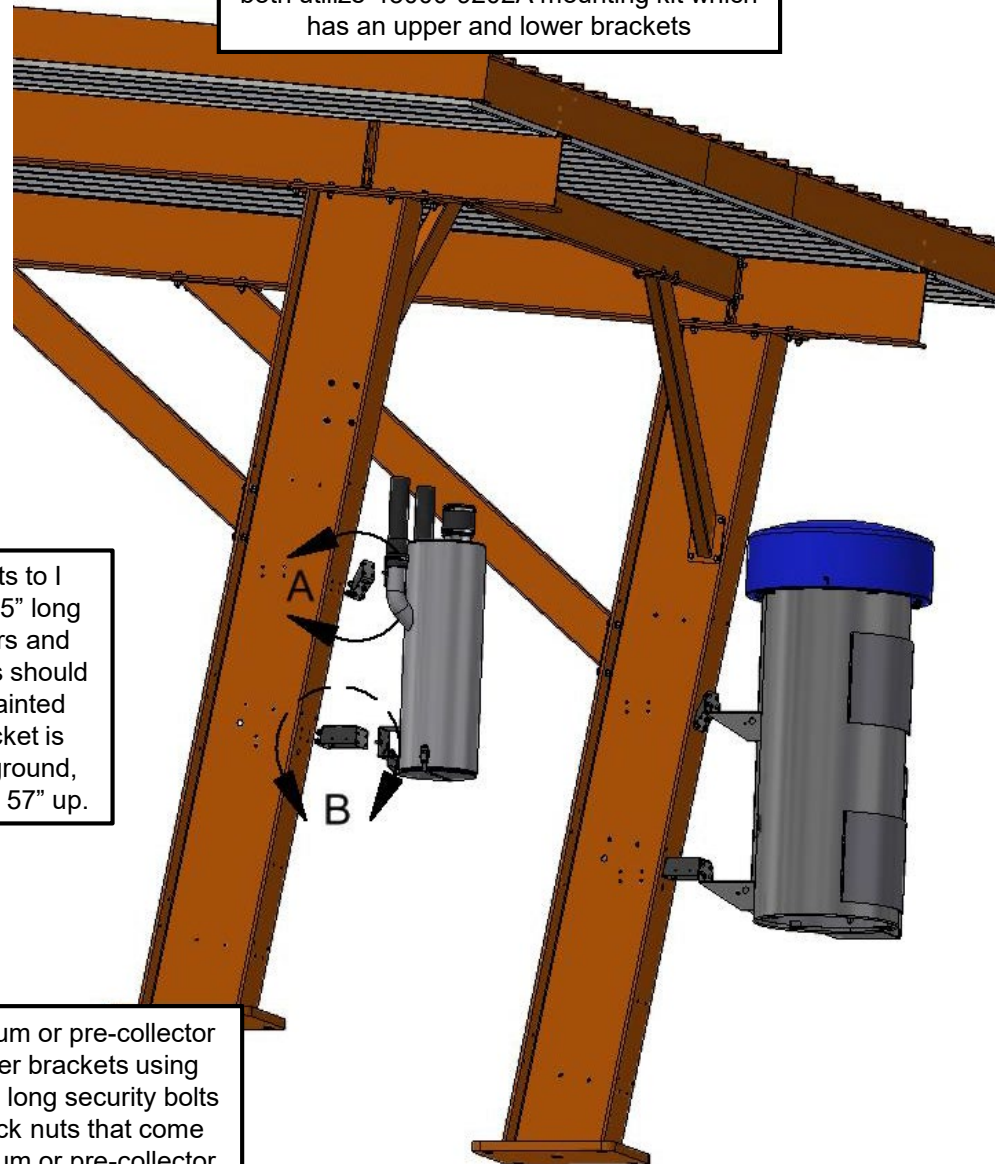

Power Routing Options

See 43000 Manual for details on electrical in foundation suggestions

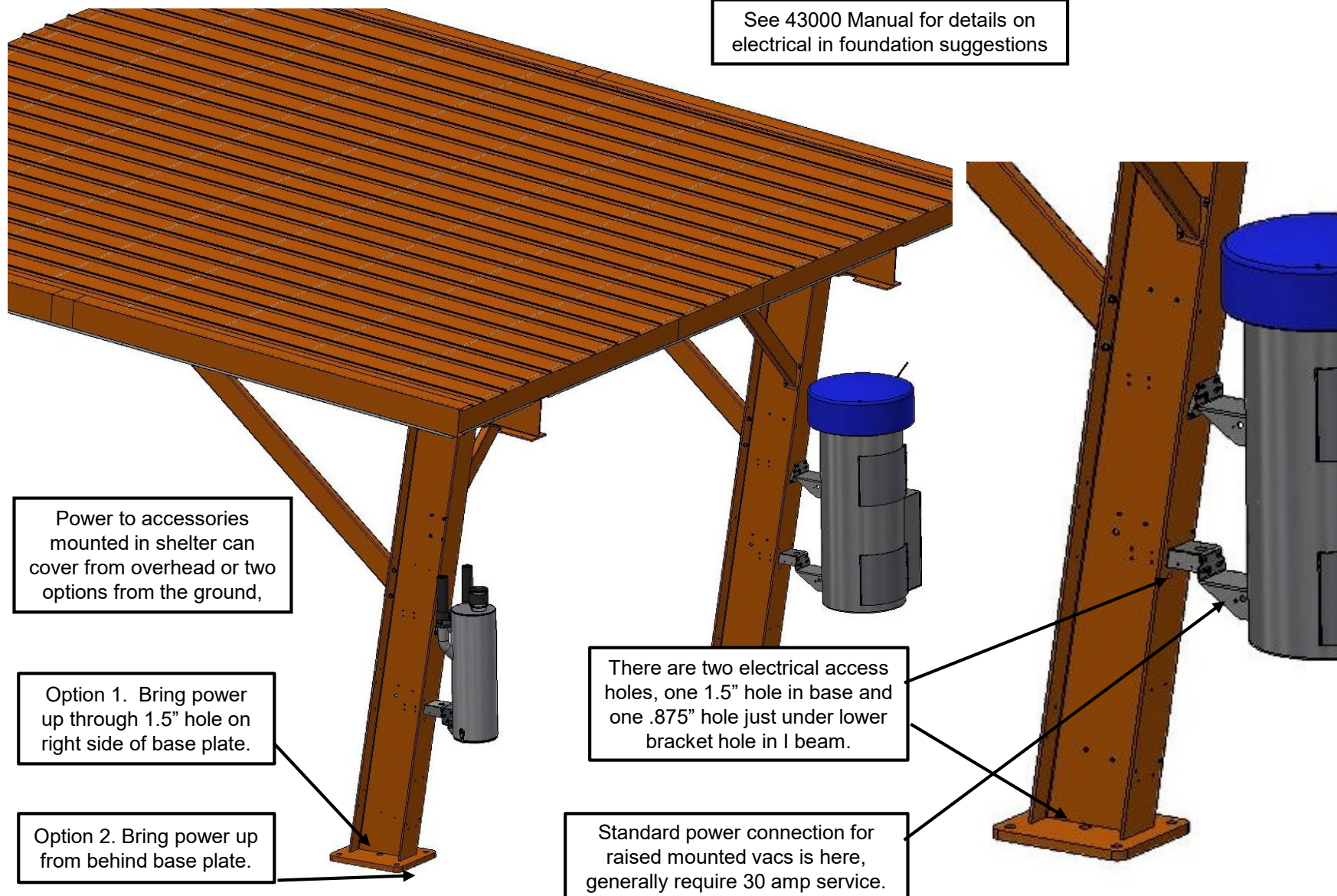

Trash Can Option 43000-140BDA

43000-140BDA standard swing
with hinge on right. Note
orientation of the brackets. Swing
can be changed in the field.

Step 1; Bolt upper more narrow bracket to holes in I beam
approximately 20.5" up from ground using (2) 3/8" x 1.25" hex
bolts washer and nylon nuts. Angled side should go towards I
beam. Flat washer always against painted surface

DETAIL C
SCALE .187

Step 3: Using 3/8" x .75 security bolts
and nylock nuts attach trash can
stainless frame to upper holes of
previously installed brackets.

Step 2: Bolt wider lower bracket to holes in I beam
approximately 8.5" up from ground using (2) 3/8" x 1.25" hex
bolts washer and nylon nuts. Angled side should go towards I
beam. Flat washer always against painted surface

Mat Rack Option, 42000-40A

Claw & Crevice Tool Only Option 42000-40-4A

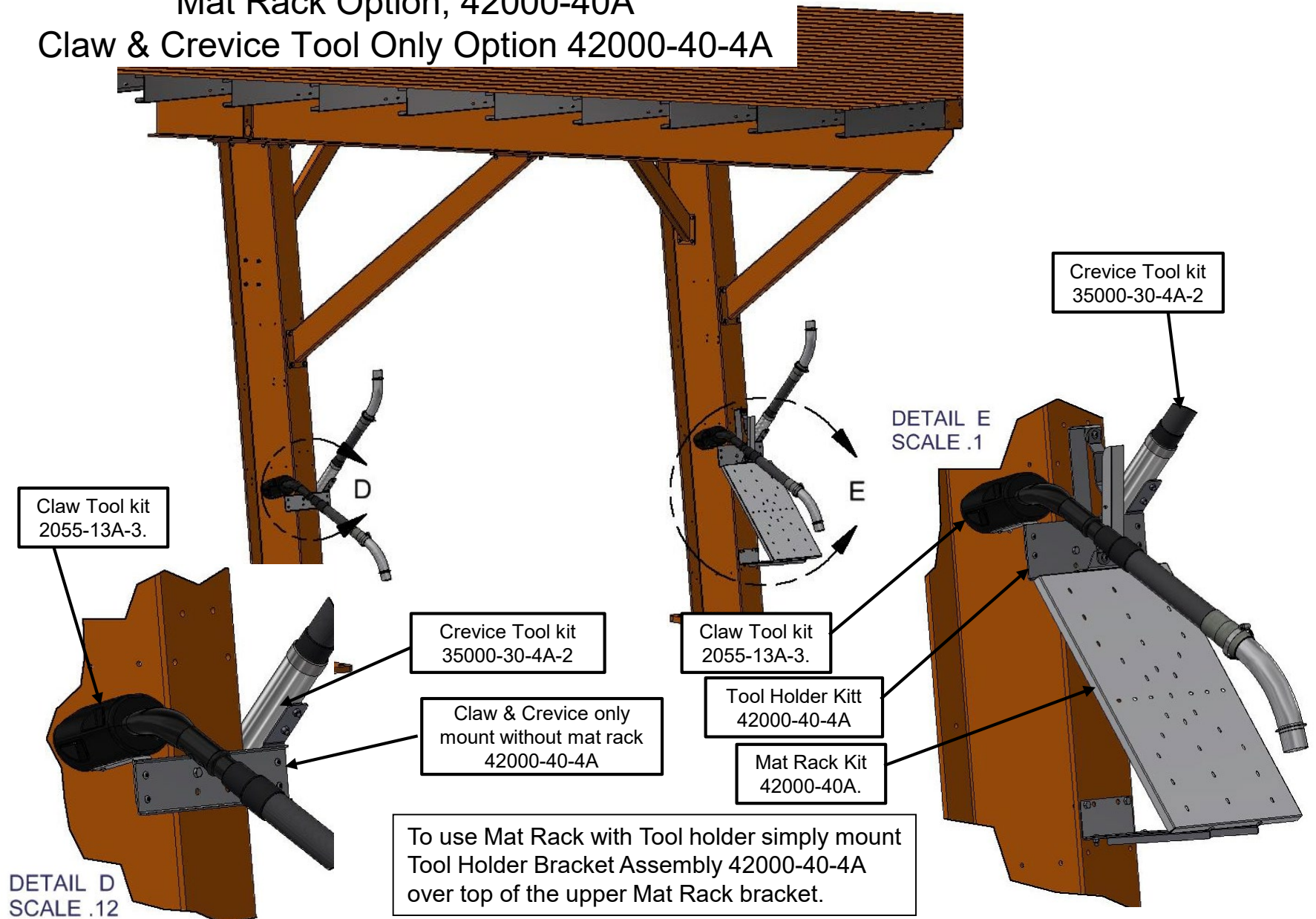

Mat Rack- 42000-40A

Claw & Crevice Tool mount- 42000-40-4A

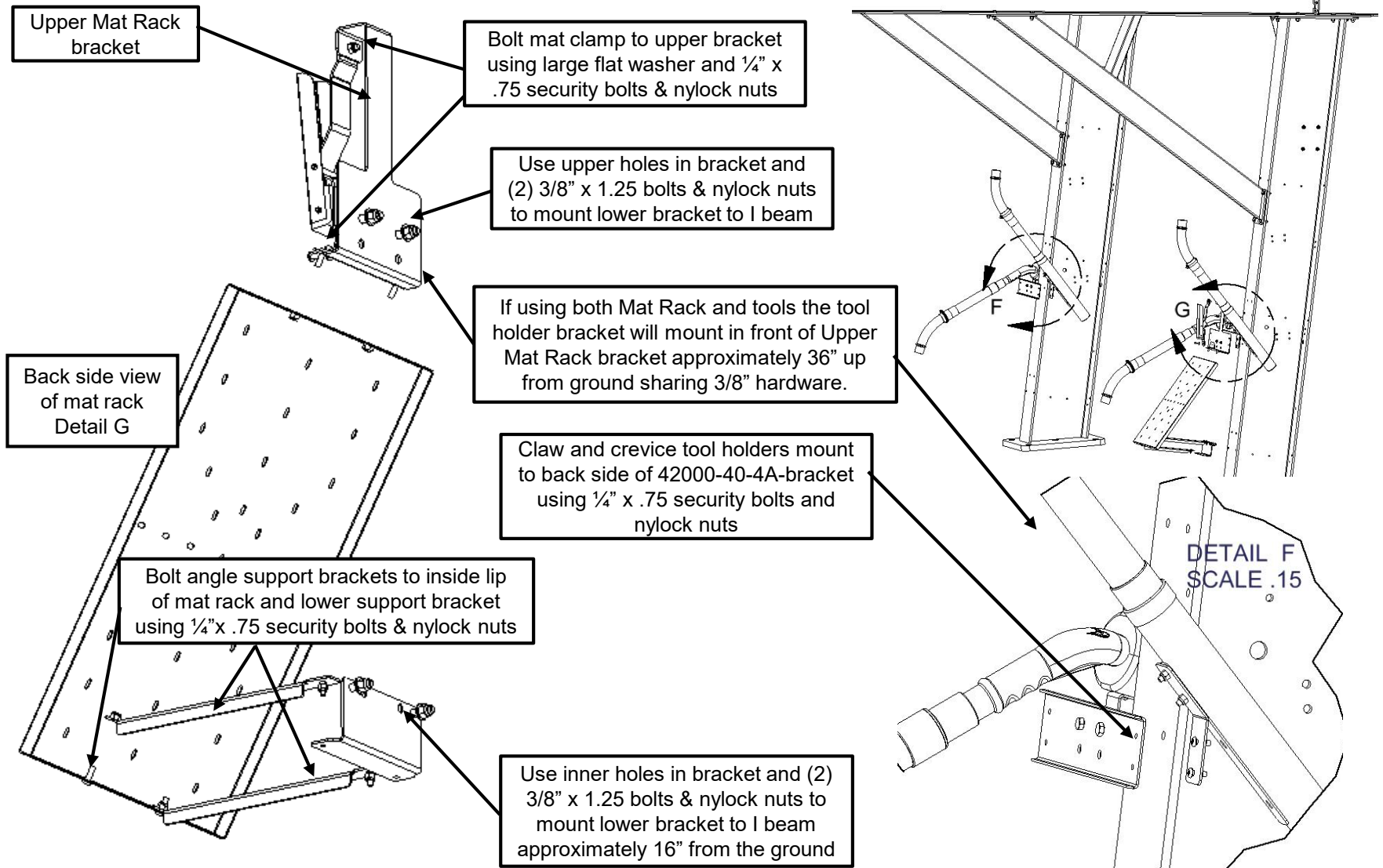

Vacuum Sign, (back lighted) 43000-17VAC-A

Step 1. Bolt (3) light brackets to I beam using $\frac{1}{4}$ " x .75 hex bolts & nylock nuts. If putting sign on each side of I beam this hardware will be shared with brackets on opposite side

ELECTRICAL PASS THROUGH HOLE FOR VACUUM POWER OPTION

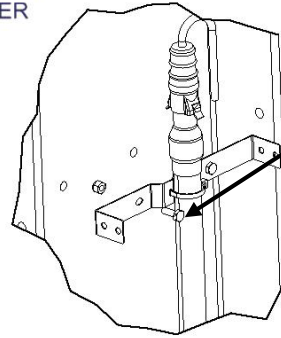

DETAIL A
SCALE 0.16 : 1

ELECTRICAL PASS THROUGH HOLE FOR 2ND LIGHT

Step 3. Wire knockouts located at each end of cover. Two at the bottom and one at the top, These are for power to pass into the sign for power or pass through the sign to power beam mounted vacuum or overhead lights.

Step 4. Bolt Vacuum sign cover to inside of I beam using (6) $\frac{1}{4}$ x 1" security bolts and flat washers

Step 2. Zip tie light to center of bracket with wire end up. Note 1.5" spacing from end of light to bottom bracket

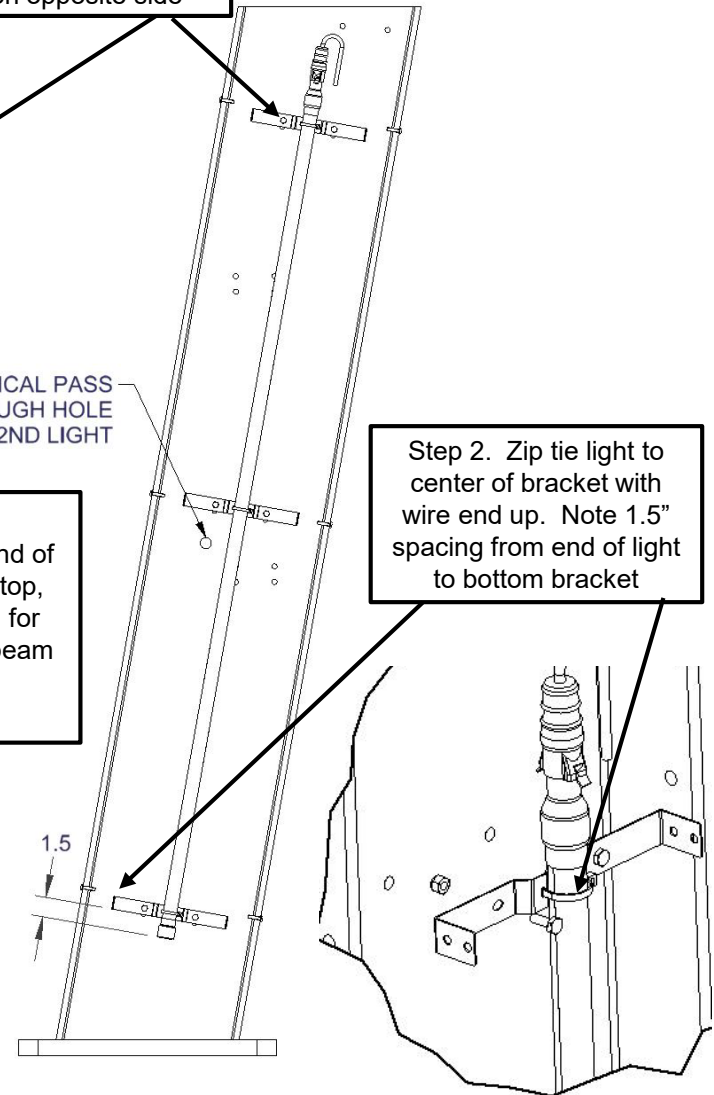

Base Covers 43000-11CAP

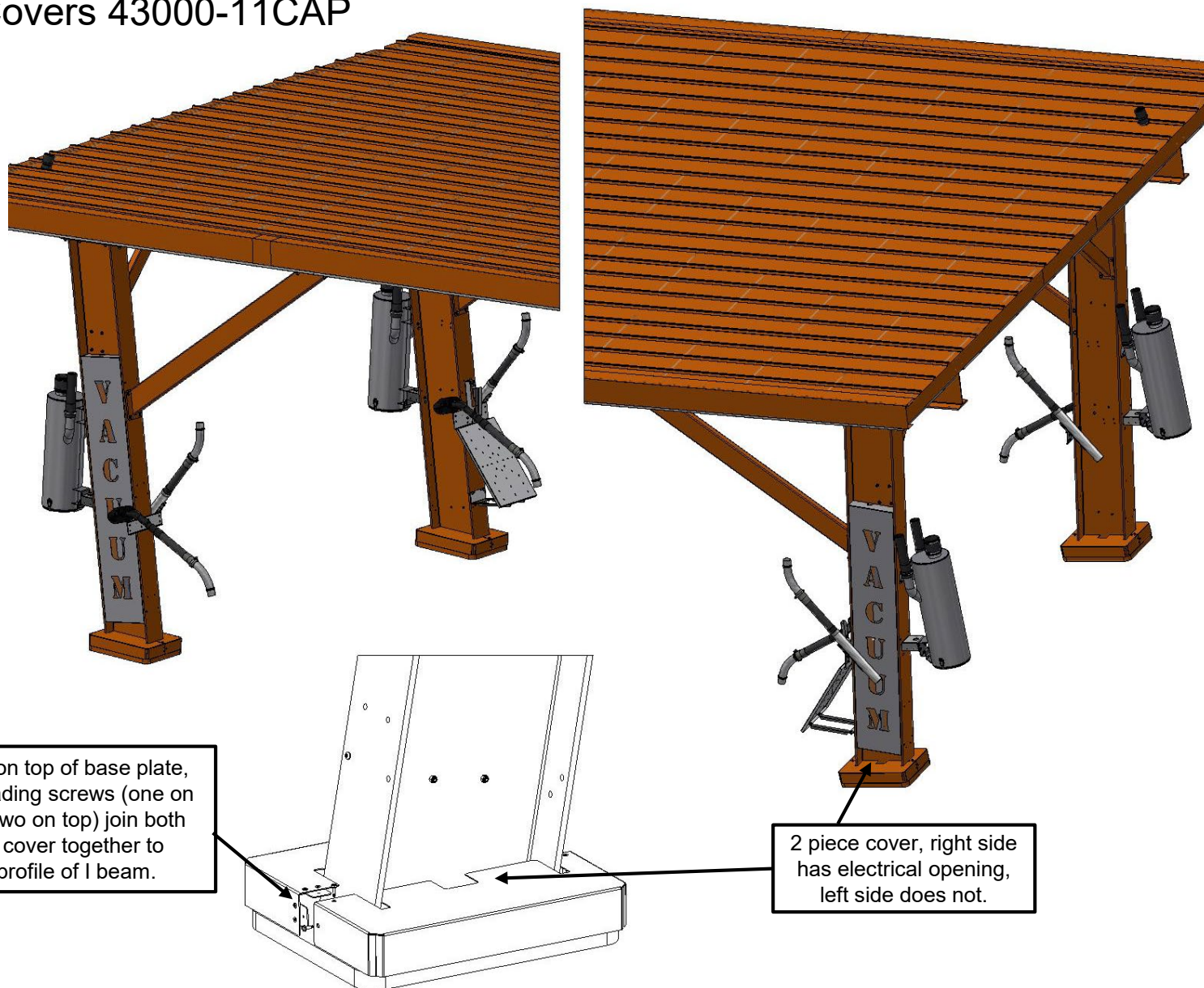

43000-58HV LED Light Kits

43000-58HV-6, 6ft

43000-58HV-8, 8ft

Route power cable to source along roof structure, or if soffit installed go through soffit panel.

Mount black wire tie bracket to underside of shelter using the self drilling screws used to install roof panels or soffit panels. Remove washer from screw first.

5600D20
Self-drilling screw

8082
Wire tie mount

Lights can be mounted where desired using self-drilling screws from roof or soffit install (washer removed) and wire tie bracket. Best practice to hold light in desired location and mark center. Then mark each end of lens area of light. If mounting to shelter with soffit then just screw through soffit panel. If mounting to shelter without soffit then wire tie brackets need to align with purlin structure

DETAIL H
SCALE .5

3 to 4 mounting points depending and light length. Not all are needed, suggest at least 2 mounting points on 6ft lights and 3 on 8 ft lights

43000-VACT Overhead Vacuum Tube kit Aluminum, Stainless Steel or Zinc Plated Steel

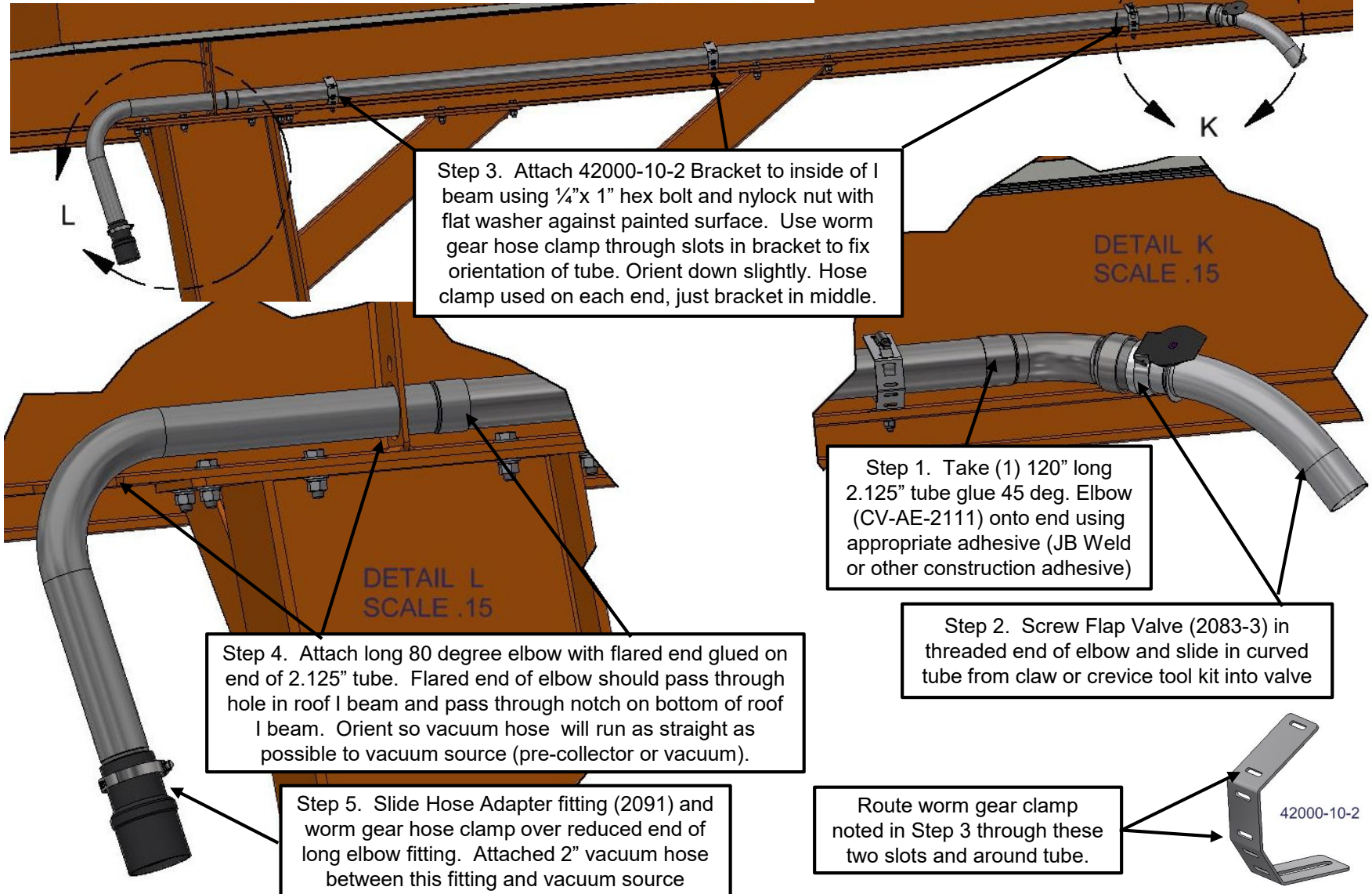

43000-VACP Overhead Vacuum PVC Pipe kit

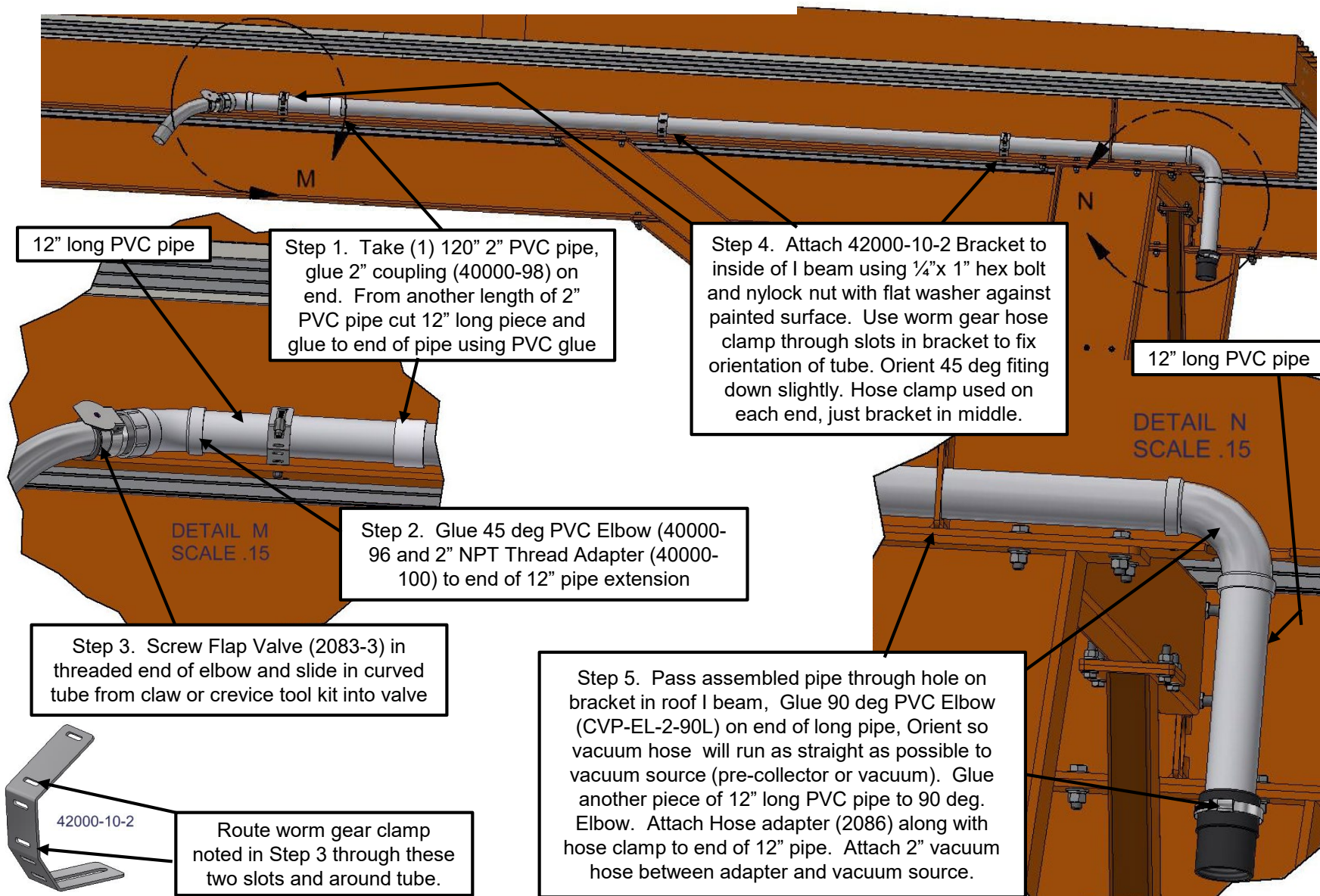

Maintenance:

- Nuts and bolts on structure should be checked once a month or as needed.
- Powder coated parts will eventually wear over time. JE Adams offers touch up paint to keep parts looking great.
- Stainless steel parts should be wiped/ cleaned as needed.
- Vacuum hoses that are forced to make tight corners will eventually crack. Check hoses periodically.

NOTES:

1. PACKAGE ITEMS 2, 10, 13 & 14 IN BAG AND PLACE INSIDE UNIT.
2. IF USING THIS ASSEMBLY FOR CENTRAL VAC PAY SYSTEM STANDARD 2 ARCH REMOVE THE FOLLOWING PARTS: ITEMS 1, 2, 14
3. IF USING THIS ASSEMBLY FOR CENTRAL VAC PAY SYSTEM "V" FORMATION REMOVE FOLLOWING PART: ITEM 4.

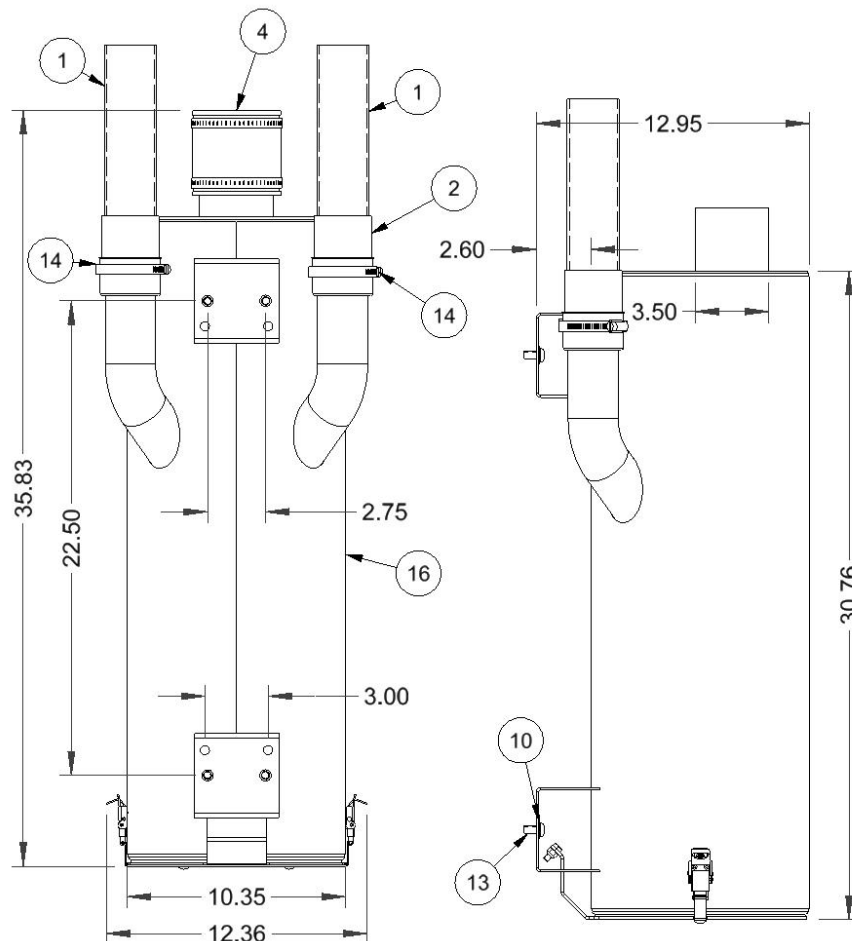

BILL OF MATERIALS			
ITEM	PART NUMBER	DESCRIPTION	QTY
1	2036-10	HOSE, VACUUM, 2" X 10"	2
2	2086	COUPLER, 2" PIPE - 2" HOSE	2
3	35000-113	LOCK BRACKET	1
4	35000-114	FLEXIBLE CONNECTOR/COUPLER 3 X 3	1
5	35000-63	DOOR, PRE FILTER BOTTOM	1
6	35000-63-4	GASKET RETAINER PLATE	1
7	35000-65	DOOR GASKET, PRE FILTER	1
8	5601D4	1/4-20 x 3/4 HHCS-SS	2
9	5603D2	NUT, NYLOCK, 1/4-20, SS	4
10	5606D31	WASHER, FLAT 3/8" SAE, SS	4
11	5635D4	BOLT, 1/4-20 X .75, CH, SS	4
12	5647D2	RIVET, 1/8 SS POP RIVET 1/16	2
13	5702D6	3/8-16 X .75 TORX SEC. T-45	4
14	8061-720-8	3" HOSE CLAMP, STAINLESS STEEL	2
15	8153-1	LATCH, CLEANOUT DOOR	2
16	9202-64W	PRE-COLLECTOR, WLDMNT, STD ARCH, CV PAY	1
17	9202PCBOX	BOX, 14x14x36	1

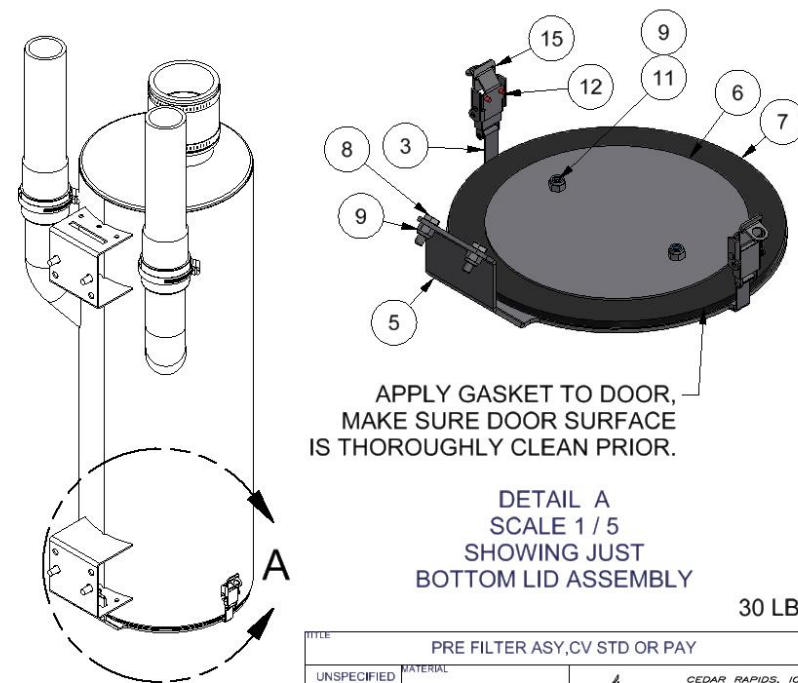

APPLY GASKET TO DOOR,
MAKE SURE DOOR SURFACE
IS THOROUGHLY CLEAN PRIOR.

DETAIL A
SCALE 1 / 5
SHOWING JUST
BOTTOM LID ASSEMBLY

30 LBS

A	8821	ADDED ITEM 17	1/25/22	BJL
-	8566	RELEASED	4/20/20	MWS
REV	NO.	DESCRIPTION	DATE	BY

THIS DOCUMENT SHALL NOT BE REPRODUCED NOR SHALL THE INFORMATION THEREIN BE USED BY OR DISCLOSED TO OTHERS EXCEPT AS AUTHORIZED BY J.E. ADAMS INDUSTRIES

TITLE			
PRE FILTER ASY, CV STD OR PAY			
UNSPECIFIED TOLERANCES	MATERIAL	DRAWN BY	DATE
1 PL ± .030		MWS	2/28/2020
2 PL ± .020			
3 PL ± .003			
ANGLE ± 1°	SCALE	SHEET	PART NO
		1 / 1	9202-64A
			REV.
			-



NOTES:
1. BAG ALL HARDWARE



SECTION A-A
SCALE .375

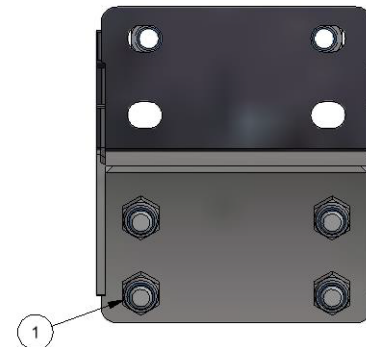
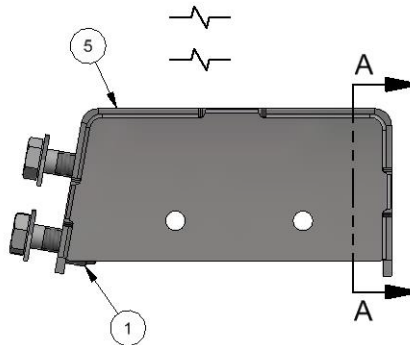
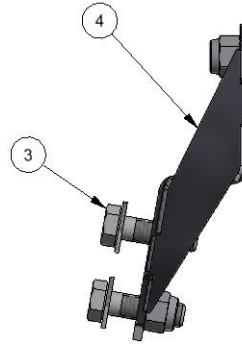
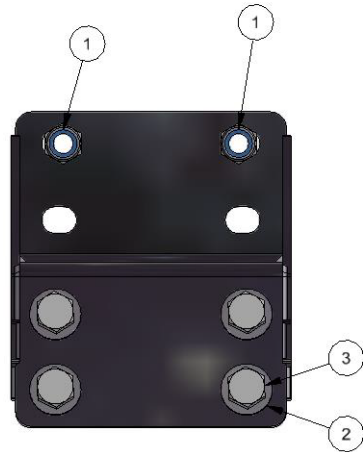

BILL OF MATERIALS			
ITEM	PART NUMBER	DESCRIPTION	QTY
1	5603D3	NUT, 3/8-16 Nylock, SS	12
2	5606D31	WASHER, FLAT 3/8" SAE, SS	8
3	5622D7	3/8-16 UNC x 1.25 CAP SCREW, SS	8
4	43001-42W	WLDMNT OASIS UPPER VAC MNT	1
5	43001-43W	WLDMNT, LOWER VAC & TC MNT, I BEAM	1

-	9198	RELEASED	7/2/24	MWS
REV	NO.	DESCRIPTION	DATE	BY

THIS DOCUMENT SHALL NOT BE REPRODUCED NOR SHALL THE INFORMATION THEREIN BE USED BY OR DISCLOSED TO OTHERS EXCEPT AS AUTHORIZED BY J.E. ADAMS INDUSTRIES

TITLE			
OASIS SHELTER VAC, PRE COL MNT KIT			
UNSPECIFIED TOLERANCES		MATERIAL	
1 PL ±.030	BY	MWS	
2 PL ±.020	DATE	3/21/2024	
3 PL ±.003	SCALE	SHEET	REV.
ANGLE ± 1°	.375	1 / 1	
PART NO 43000-9202A			



PART NO
43000-140BDA

- NOTES:
1. ASSEMBLY CAN BE STACKED ON 52" X 52" PALLET, 4 PER LEVEL AND UP TO 3 HIGH FOR TOTAL OF 12.
 2. ASSEMBLE AS LEFT HAND SWING UNLESS DIRECTED OTHERWISE.
 3. DO NOT ASSEMBLE ITEMS 5 AND 6, PACKAGE BOTH BRACKETS AND HARDWARE AND PLACE INSIDE TRASH CAN.

BILL OF MATERIALS			
ITEM	PART NUMBER	DESCRIPTION	QTY
1	5603D3	NUT, 3/8-16 Nylock, SS	8
2	5606D31	WASHER, FLAT 3/8" SAE, SS	4
3	5622D7	3/8-16 UNC x 1.25 CAP SCREW, SS	4
4	35000-140BDA	TRASH CAN ASY, BI-DIRECTIONAL	1
5	43001-43W	WLDMNT, LOWER VAC & TC MNT, I BEAM	1
6	43001-44W	WLDMNT, UPPER TC MOUNT, I BEAM	1

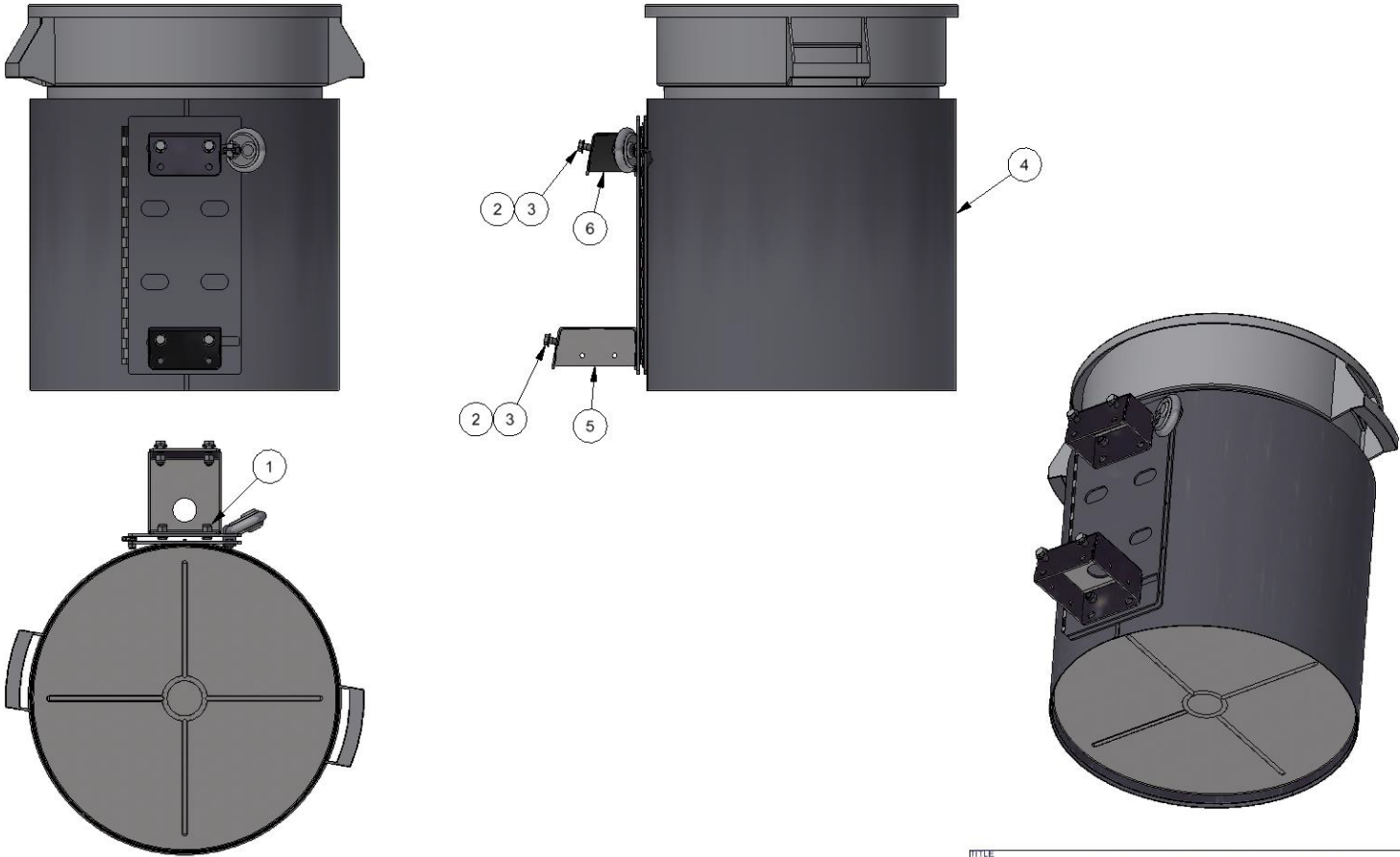

-	9198	RELEASED	7/2/24	MWS
REV	NO.	DESCRIPTION	DATE	BY

THIS DOCUMENT SHALL NOT BE REPRODUCED NOR SHALL THE INFORMATION THEREIN BE USED BY OR DISCLOSED TO OTHERS EXCEPT AS AUTHORIZED BY J.E. ADAMS INDUSTRIES

TITLE OASIS SHELTER TRASH CAN ASY.			
UNSPECIFIED TOLERANCES	MATERIAL	CEDAR RAPIDS, IOWA	
1 PL ±.030	BY	mws	
2 PL ±.020	DATE	3/21/2024	
3 PL ±.003	SCALE	SHEET	REV.
ANGLE ± 1°	1 / 10	1 / 1	43000-140BDA



- NOTES:
1. PACKAGE HARDWARE AND BRACKETS SEPARATELY.
2. COPY THIS DRAWING WITH ASSEMBLY

BILL OF MATERIALS			
ITEM	PART NUMBER	DESCRIPTION	QTY
1	5603D2	1/4-20 NYLOCK NUT, SS	8
2	5603D3	NUT, 3/8-16 Nylock, SS	4
3	5606D31	WASHER, FLAT 3/8" SAE, SS	4
4	5622D7	3/8-16 UNC x 1.25 CAP SCREW, SS	4
5	5702D5	1/4-20 X .75 TORX SEC. T-27	8
6	8597	5/16 WASHER	2
7	32000-12	CLAMP, MAT, ASSEMBLY	1
8	35000-40-6	MAT FRAME, LOWER BRKT	2
9	35000-40-8W	MAT RACK 1 PC WELDMENT	1
10	42000-40-3	BRKT, SHELTER, MAT RACK CLAMP	1
11	42000-40-5	BRKT, SHELTER, MAT RACK LOWER	1
12	42000-40A	COPY THIS DRAWING WITH PACKAGING	1

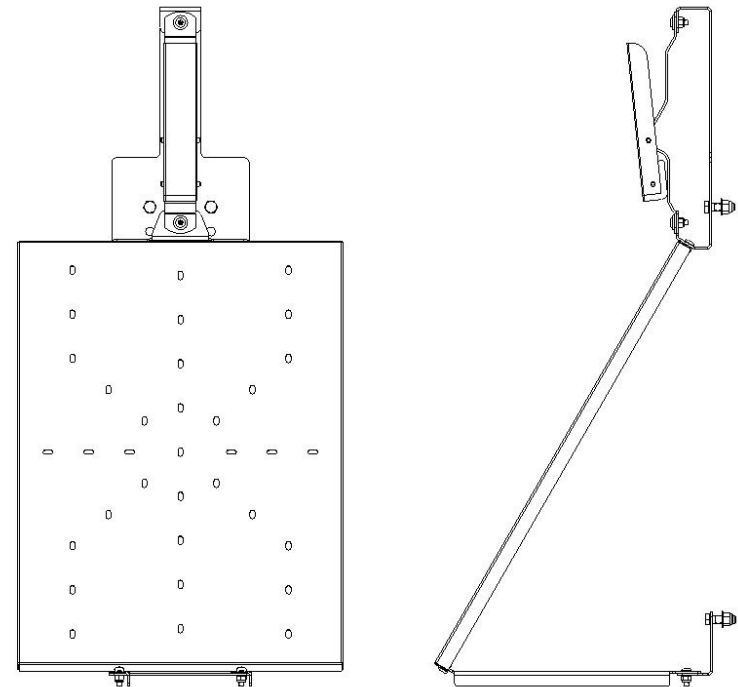
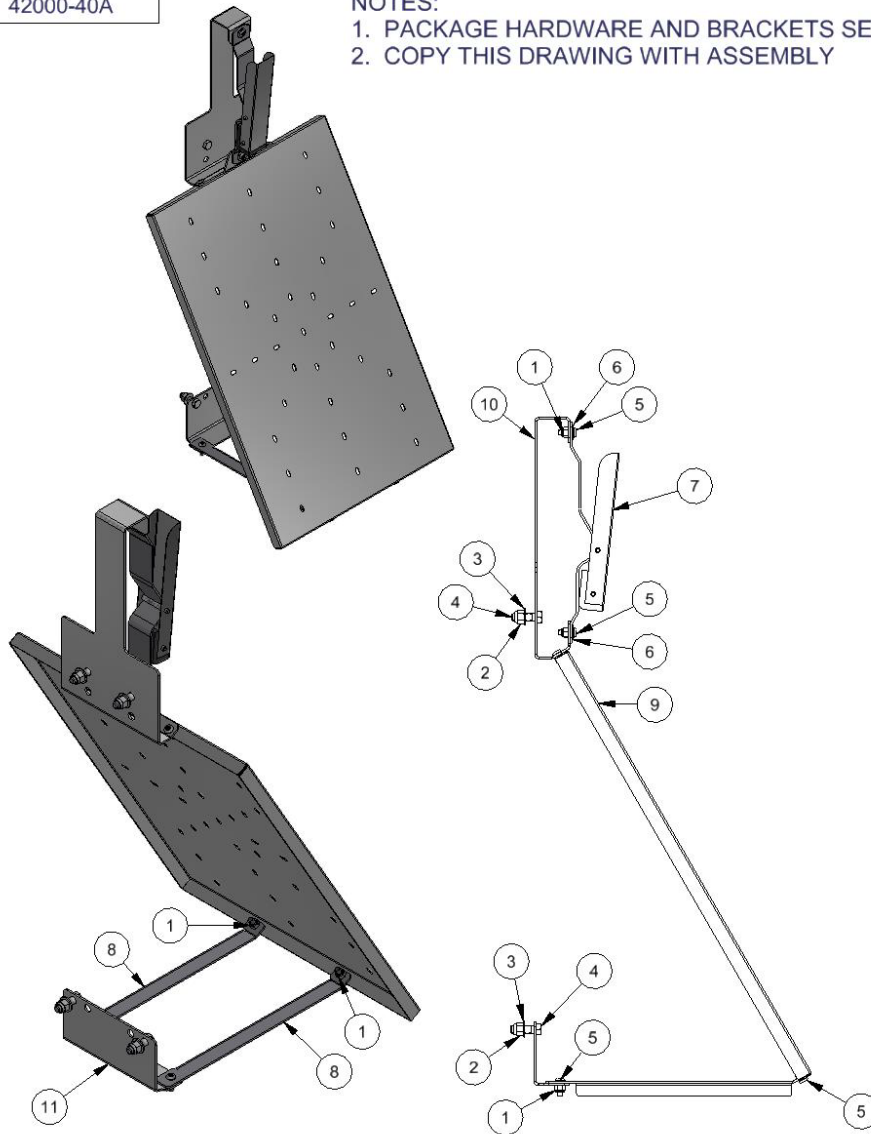

-	9044	RELEASED	7/12/23	MWS
REV	NO.	DESCRIPTION	DATE	BY

THIS DOCUMENT SHALL NOT BE REPRODUCED NOR SHALL THE INFORMATION THEREIN BE USED BY OR DISCLOSED TO OTHERS EXCEPT AS AUTHORIZED BY J.E. ADAMS INDUSTRIES

TITLE MAT RACK ASY, SHELTER			
UNSPECIFIED TOLERANCES	MATERIAL	DATE	BY
1 PL ±.030	DATE	3/2/2023	MWS
2 PL ±.020	SCALE	.12	SHEET
3 PL ±.003	ANGLE ±1°	1 / 2	1 / 2
PART NO 42000-40A			REV. -



BILL OF MATERIALS			
ITEM	PART NUMBER	DESCRIPTION	QTY
1	5603D3	NUT, 3/8-16 Nylock, SS	2
2	5606D31	WASHER, FLAT 3/8" SAE, SS	2
3	5622D7	3/8-16 UNC x 1.25 CAP SCREW, SS	2
4	42000-40-4	BRKT, SHELTER, CLAW/CREVICE HOLDER	1

NOTES:
1. BAG HARDWARE AND ATTACH TO BRACKET.

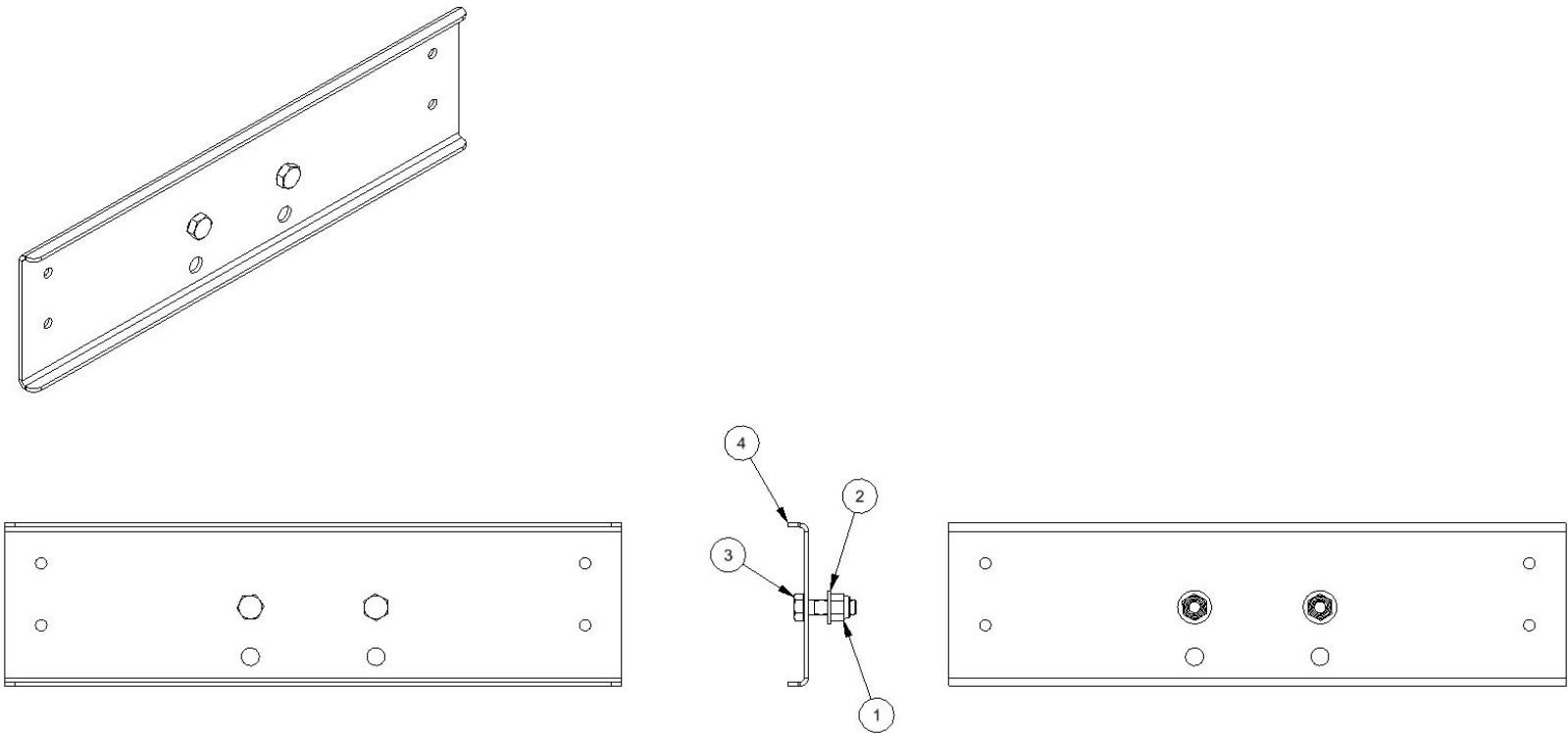

-	9249	RELEASED	11/22/24	MWS
REV	NO.	DESCRIPTION	DATE	BY
THIS DOCUMENT SHALL NOT BE REPRODUCED NOR SHALL THE INFORMATION THEREIN BE USED BY OR DISCLOSED TO OTHERS EXCEPT AS AUTHORIZED BY J.E. ADAMS INDUSTRIES				

TITLE SHELTER CLAW/CREVICE TOOL HOLDER ASY			
UNSPECIFIED TOLERANCES	MATERIAL	CEDAR RAPIDS, IOWA	
1 PL ±.030	DRAWN BY	J.E. ADAMS INDUSTRIES, LTD	
2 PL ±.020	DATE	7/9/2024	
3 PL ±.003	SCALE	SHEET	PART NO.
ANGLE ± 1°	1 / 4	1 / 1	42000-40-4A
			REV.
			-

BILL OF MATERIALS

ITEM	PART NUMBER	DESCRIPTION	QTY
1	2032BLACK	HOSE, 1-1/2" X 15" BLACK VACUUM HOSE	1
2	2047	CREVICE TOOL, BLACK 16" X 1-1/2"	1
3	2058-9-4	BRKT, CREVICE HOLDER, SHELTER	1
4	2084	HOSE COUPLER/ENLARGER 1-1/2 HOSE	1
5	2090	SWIVEL COUPLING 1-1/2"	1
6	5603D2	1/4-20 NYLOCK NUT, SS	4
7	5702D5	1/4-20 X .75 TORX SEC. T-27	2
8	8546-1	CLAMP, HOSE, SS, 1 3/4"-2 3/4"	1
9	35000-30-4W	WELDMENT, CREVICE TOOL HOUSING	1
10	2083-4W	SINGLE INLET 2" REDUCED WELDMENT	1

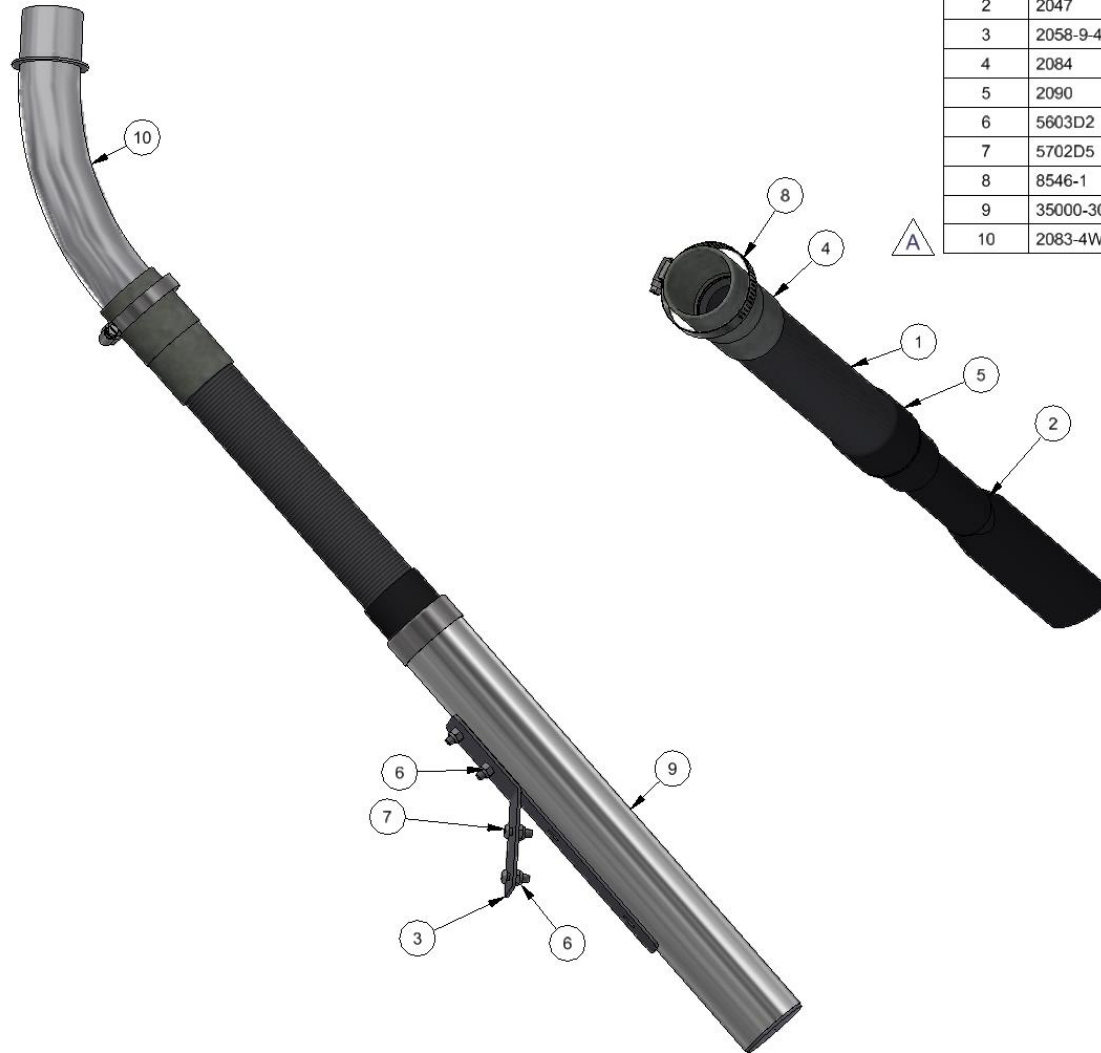

TITLE			
CREVICE TOOL ASSEMBLY, SHELTER			
UNSPECIFIED TOLERANCES		MATERIAL	
1 PL ±.030	DRAWN BY	MWS	
2 PL ±.020	DATE	3/2/2023	
3 PL ±.003	SCALE	SHEET	1 / 1
ANGLE ±1°			
		PART NO.	35000-30-4A-2
		REV.	A



THIS DOCUMENT SHALL NOT BE REPRODUCED NOR SHALL THE INFORMATION THEREIN BE USED BY OR DISCLOSED TO OTHERS EXCEPT AS AUTHORIZED BY J.E. ADAMS INDUSTRIES

NOTES:

1. REPLACES 2058-13A-1
2. PACKAGE IN BOX THAT ITEM 1 COMES IN OR IN 75000BOX. UP TO TWO HOSES CAN FIT IN BOX.
3. ALL PARTS BESIDES HOSE, HOLDER, AND CLAW TO BE PLACED IN BAG.
4. **USE CAUTION WHEN INSTALLING 5616D10. OVER TIGHTENING WILL CAUSE DAMAGE TO HOLDER.**
5. 2055-2PLUG TO BE INSTALLED BY PUSHING PLUG INTO OPENING ON END OF HOLDER. USE AN ALLEN WRENCH TO PUSH PLUG AS NEEDED.
6. ONLY INSTALL PLUG WHEN USED IN A CENTRAL VACUUM APPLICATION. DO NOT INSTALL IF USING WITH A MOUNTED VACUUM.
7. PROVIDE COPY OF DRAWING WITH EACH PACKAGE.

BILL OF MATERIALS

ITEM	PART NUMBER	DESCRIPTION	QTY
1	2032BLACK	HOSE, 1-1/2" X 15" BLACK VACUUM HOSE	1
2	2055-2	COBRA CLAW TOOL	1
3	2055-2B-2	BRKT, COBRA CLAW HOLDER MNT, 100 DEG	1
4	2055-2HA	COBRA CLAW HOLDER ASSEMBLY	1
5	2055-2PLUG	BLACK RUBBER PLUG, .375 IN ID, .736 IN L,	1
6	2083-4W	SINGLE INLET 2" REDUCED WELDMENT	1
7	2084	HOSE COUPLER/ENLARGER 1-1/2 HOSE	1
8	2090	SWIVEL COUPLING 1-1/2"	1
9	5603D2	1/4-20 NYLOCK NUT, SS	2
10	5616D10	SCREW, #12X .75, PH, PH, HI/LO THREAD	2
11	5702D5	1/4-20 X .75 TORX SEC. T-27	2
12	8546-1	CLAMP, HOSE, SS, 1 3/4"-2 3/4"	1

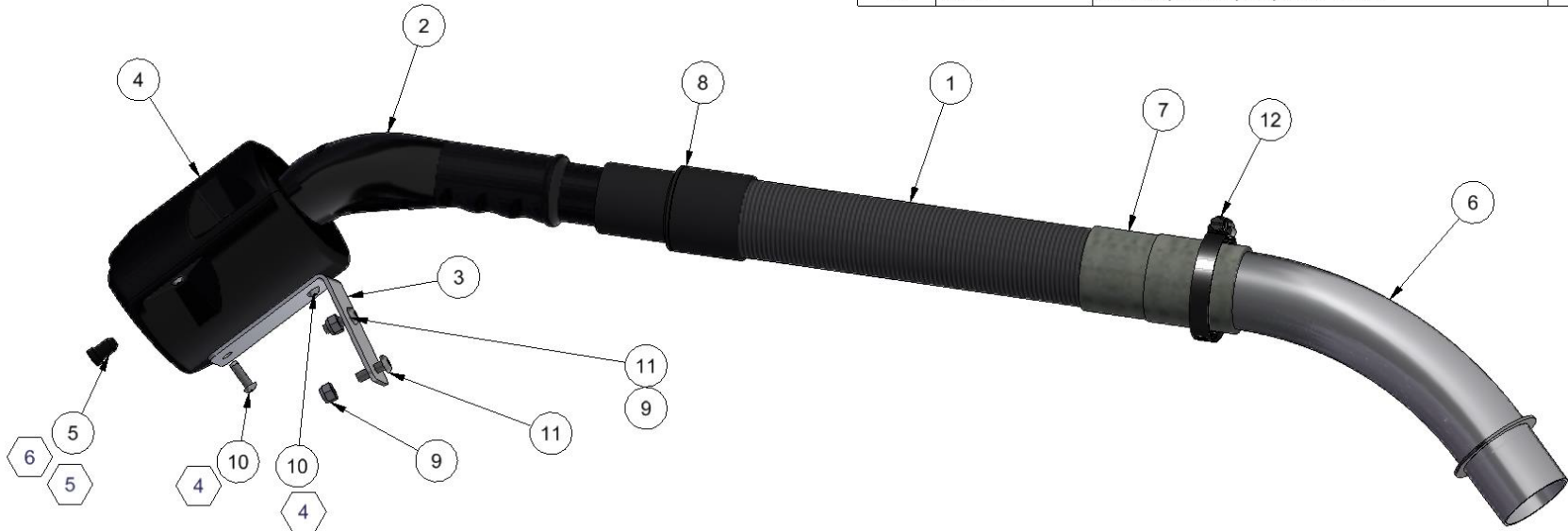

TITLE CLAW HANGER ASSEMBLY, 30 DEG, WIND ARCH			
UNSPECIFIED TOLERANCES	MATERIAL	CEDAR RAPIDS, IOWA	
1 PL ±.030	DESIGNED BY	BJL	
2 PL ±.020	DATE	7/11/2024	
3 PL ±.003	SCALE	SHEET	PART NO.
ANGLE ±1°		1 / 1	2055-13A-3

-	9205	RELEASED	7/11/24	BJL
REV	NO.	DESCRIPTION	DATE	BY

THIS DOCUMENT SHALL NOT BE REPRODUCED NOR SHALL THE INFORMATION THEREIN BE USED BY OR DISCLOSED TO OTHERS EXCEPT AS AUTHORIZED BY J.E. ADAMS INDUSTRIES

NOTES:

1. ONLY ASSEMBLY DONE ON THIS IS THE ATTACHMENT OF THE LENS (43001-17L) TO THE "VACUUM" SHEET METAL BOX USING 5603D1 NYLOCK NUTS.
2. BAG THE BRACKETS, ZIP TIES AND REMAINING HARDWARE.
3. STRETCH WRAP ITEM 9 TO PROTECT LENS MATERIAL.

BILL OF MATERIALS

ITEM	PART NUMBER	DESCRIPTION	QTY
1	5601D4	1/4-20 x 3/4 HHCS-SS	6
2	5603D1	NUT #10-24, NYLOCK, SS	12
3	5603D2	1/4-20 NYLOCK NUT, SS	6
4	8085	CABLE TIE, 15" - 120LB	3
5	35000-57-6HV	LED LIGHT TUBE, 120V, 6'	1
6	35000-57HV-2	LED TUBE LIGHT WIRE HARNESS, 15'	1
7	43001-17-1	BRKT, LIGHT MOUNT I BEAM BACK LIGHT	3
8	43001-17L	LENS, SHELTER I BEAM LIGHT COVER	1
9	43001-17VACW	WLDMNT, I BEAM VACUUM LIGHT	1
10	5702D7	1/4-20 X 1" TORX SEC, T-27	6
11	5606D6	1/4" FLAT WASHER	6

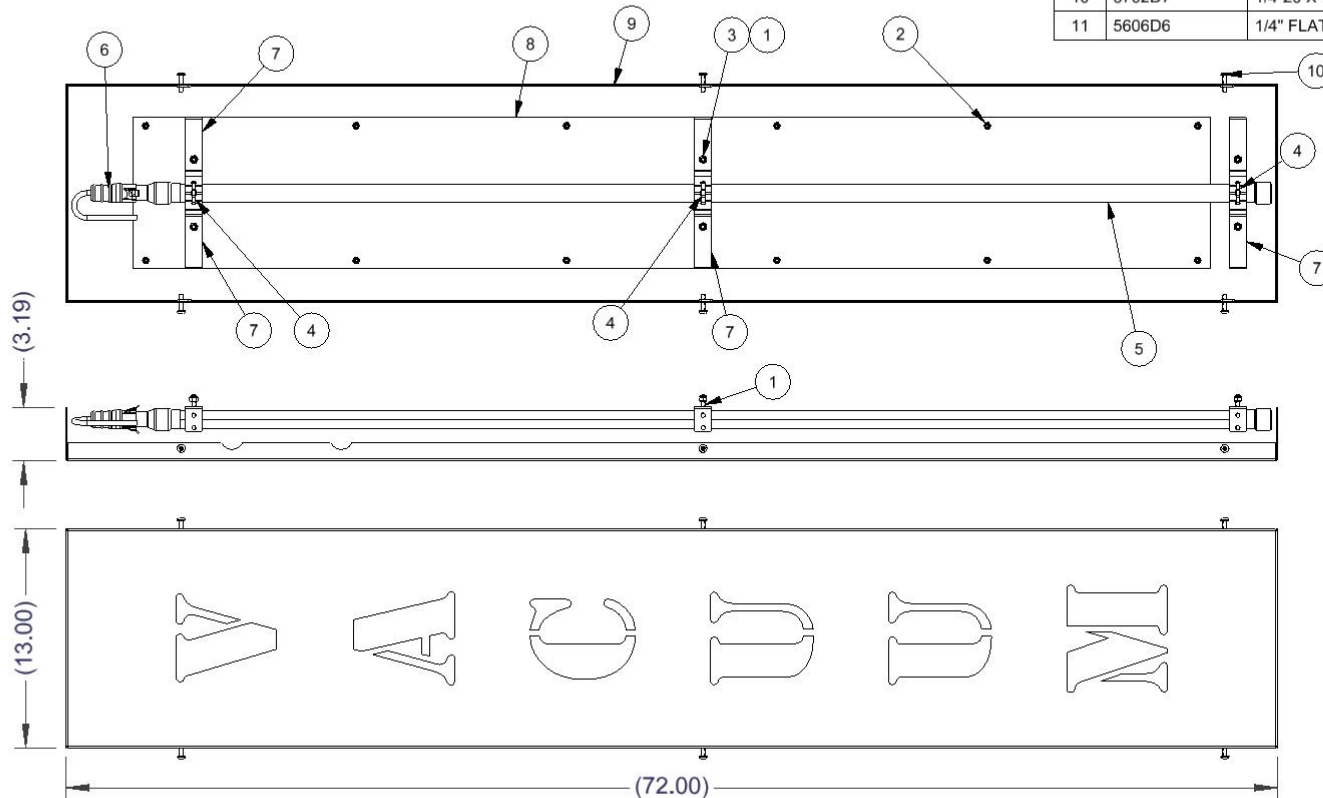

TITLE			
OASIS VACUUM BACKLIGHT ASY			
UNSPECIFIED TOLERANCES		MATERIAL	
1 PL ±.030	BY	DRAWN mws	
2 PL ±.020	DATE	4/16/2024	
3 PL ±.003	SCALE	SHEET	PART NO.
ANGLE ±1°	.1	1 / 2	43000-17VAC-A
REV.			-



-	9198	RELEASED	7/2/24	MWS
REV	NO.	DESCRIPTION	DATE	BY

THIS DOCUMENT SHALL NOT BE REPRODUCED NOR SHALL THE INFORMATION THEREIN BE USED BY OR DISCLOSED TO OTHERS EXCEPT AS AUTHORIZED BY J.E. ADAMS INDUSTRIES

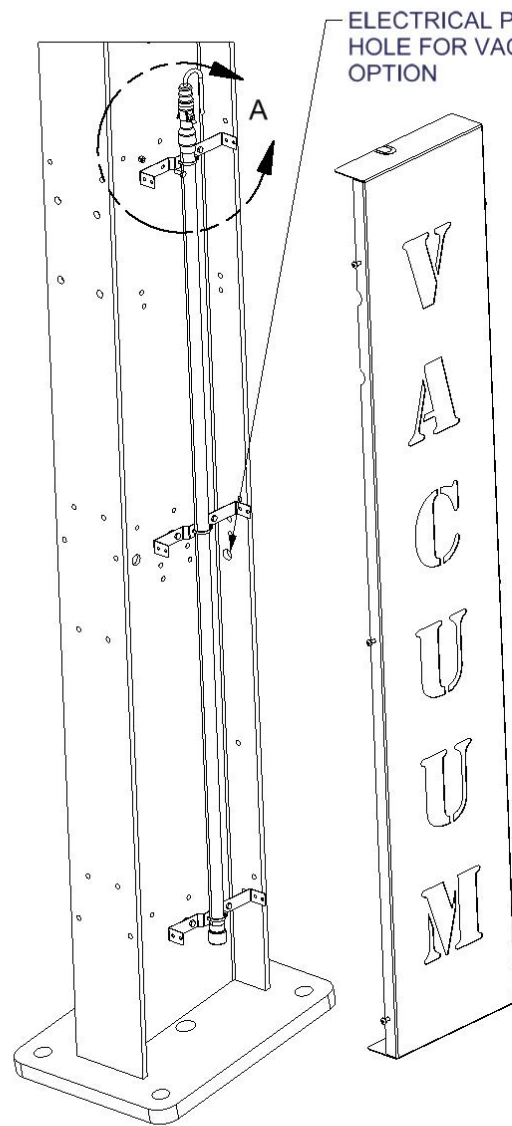

ELECTRICAL PASS THROUGH
HOLE FOR VACUUM POWER
OPTION

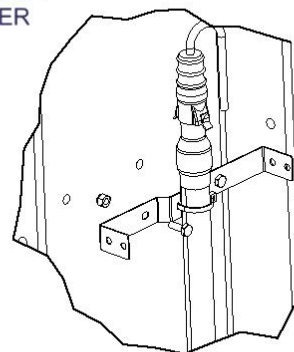

DETAIL A
SCALE 0.16 : 1

ASSEMBLY:

1. Bolt item 7 bracket to I beam in 3 places using 1/4-20 hex bolts and nuts. If lights are on both sides of I beam capture opposite side bracket as well.
2. Lace zip ties through center of each item 7 bracket and attach light with cord end up and bottom end of light 1.5" below bracket.
3. Sign cover is bolted inside I beam using security 1/4-20 bolts through flange of I beam.

ELECTRICAL PASS
THROUGH HOLE
FOR 2ND LIGHT

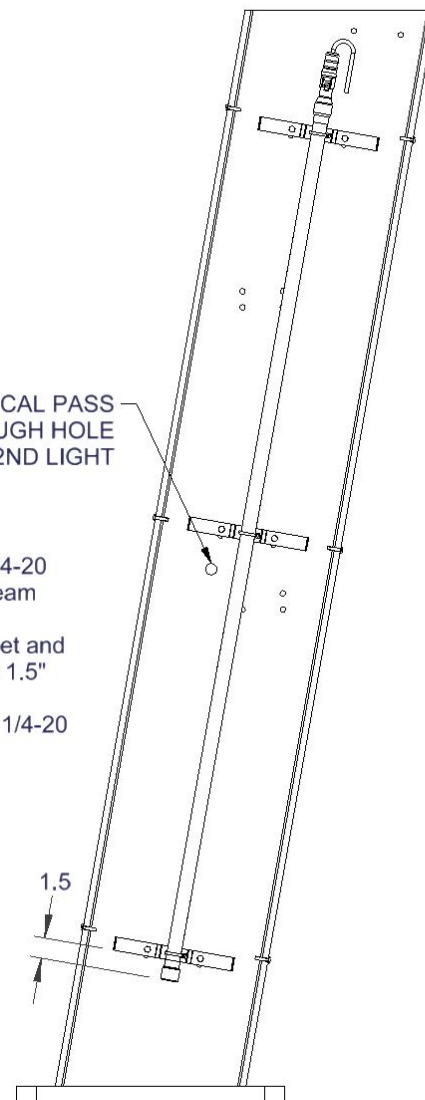

1.5

REV	NO.	DESCRIPTION	DATE	BY
THIS DOCUMENT SHALL NOT BE REPRODUCED NOR SHALL THE INFORMATION THEREIN BE USED BY OR DISCLOSED TO OTHERS EXCEPT AS AUTHORIZED BY J.E. ADAMS INDUSTRIES				

TITLE OASIS VACUUM BACKLIGHT ASY				
UNSPECIFIED TOLERANCES	MATERIAL	DATE	BY	STATE
1 PL ± .030	BY mws	4/16/2024		
2 PL ± .020	DATE			
3 PL ± .003	SCALE	SHEET	PART NO	REV.
ANGLE ± 1°	.1	2 / 2	43000-17VAC-A	-



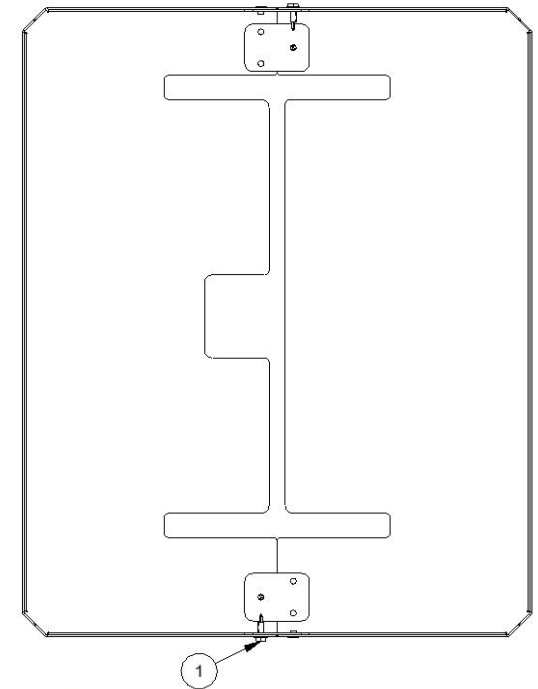
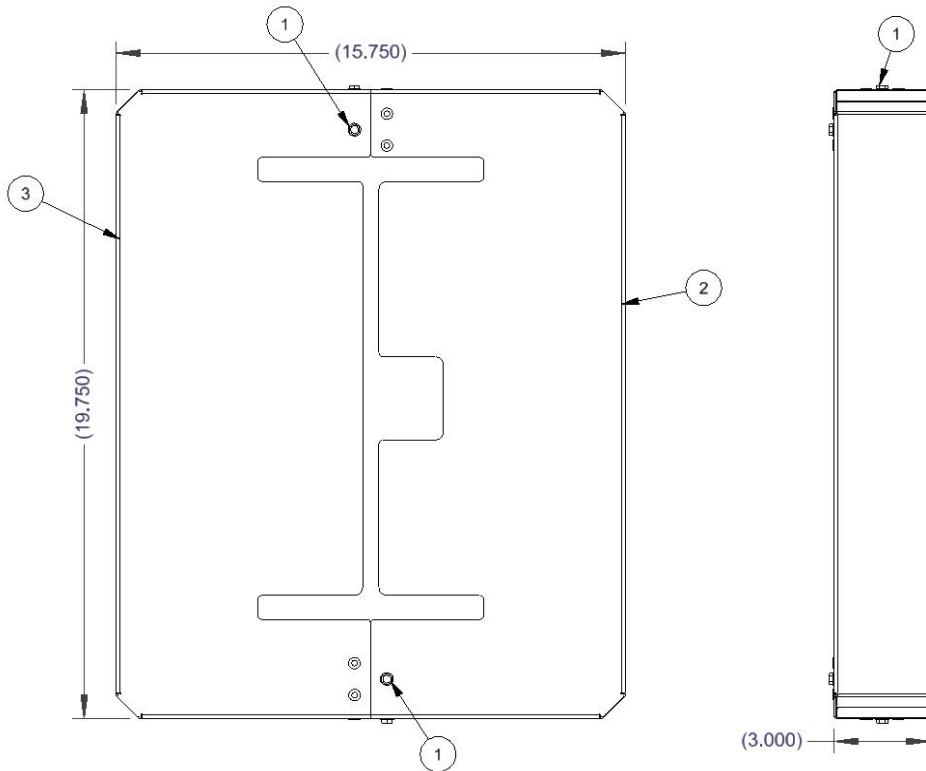
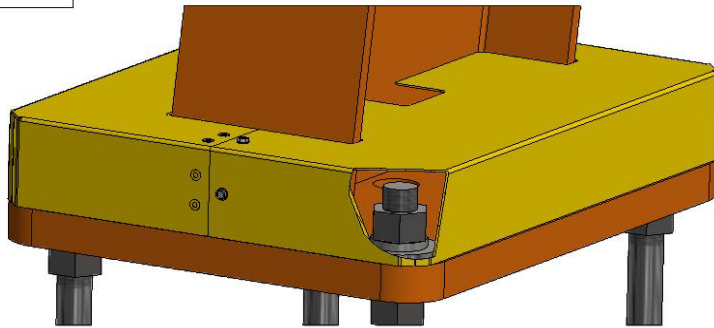

BILL OF MATERIALS

ITEM	PART NUMBER	DESCRIPTION	QTY
1	5642D3	SCREW, #10X.50, HWH, SELF DRILL, SS	4
2	43001-11C1WP	BASE COVER, OASIS, RIGHT, PAINTED	1
3	43001-11C2WP	BASE COVER, OASIS, LEFT, PAINTED	1
4	43001-22184	BOX, SHIPPING, 22X18X4 TALL	1
5	43001-11CAP	OASIS COVER ASSEMBLY DRAWING	1

NOTES:

1. INCLUDE COPY OF THIS DRAWING IN SHIPMENT.
2. BAG ALL LOOSE HARDWARE IN BAG
3. USED ON 43000 OASIS SHELTER ASSEMBLY ONLY.

-	9198	RELEASED	7/2/24	MWS
REV	NO.	DESCRIPTION	DATE	BY

THIS DOCUMENT SHALL NOT BE REPRODUCED NOR SHALL THE INFORMATION THEREIN BE USED BY OR DISCLOSED TO OTHERS EXCEPT AS AUTHORIZED BY J.E. ADAMS INDUSTRIES

TITLE		BASE COVER ASY, OASIS	
UNSPECIFIED TOLERANCES		MATERIAL	
1 PL ±.030	DRAWN BY	mws	
2 PL ±.020	DATE	6/18/2024	
3 PL ±.003	SCALE	1 / 1	
ANGLE ± 1°	SHEET	1 / 1	PART NO. 43000-11CAP
			REV. -

- NOTES:
- 1. BAG ALL COMPONENTS BUT THE LIGHT ITSELF.
 - 2. (4) EXTRA 8082 AND 8085 PARTS ARE FOR SECURING CORD UNDER SHELTER ROOF.

BILL OF MATERIALS			
ITEM	PART NUMBER	DESCRIPTION	QTY
1	8082	WIRE TIE SCREW MOUNT 1/4"	8
2	8085	WIRE TIE, 120LB, 15" WHITE	8
3	35000-57-8HV	LED LIGHT TUBE, 120V, 8'	1
4	35000-57HV-2	LED TUBE LIGHT WIRE HARNESS, 15'	1
5	35000-99 RND	CABLE TIE, SS, 14"	4

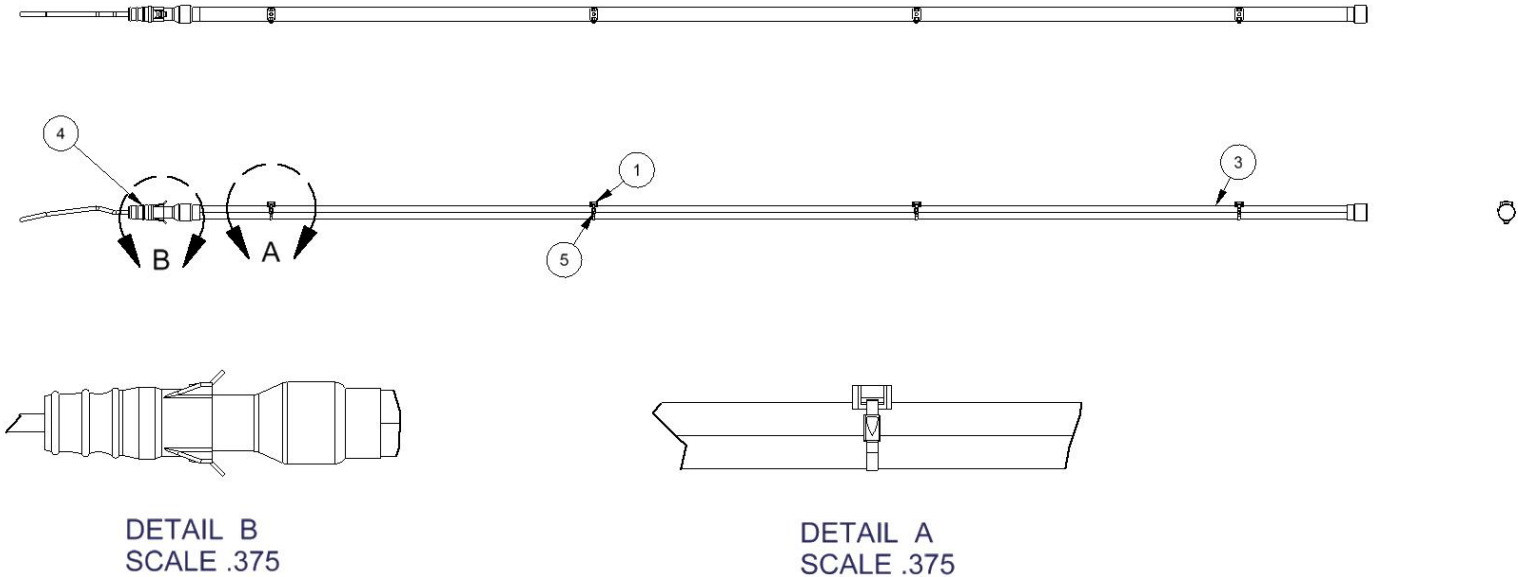

-	9212	RELEASED	7/29/24	MWS
REV	NO.	DESCRIPTION	DATE	BY

THIS DOCUMENT SHALL NOT BE REPRODUCED NOR SHALL THE INFORMATION THEREIN BE USED BY OR DISCLOSED TO OTHERS EXCEPT AS AUTHORIZED BY J.E. ADAMS INDUSTRIES

TITLE				
LED LIGHT TUBE, 120VAC, 6' ASY				
UNSPECIFIED TOLERANCES	MATERIAL		CEDAR RAPIDS, IOWA	
	DRAWN BY			
	DATE			
	SCALE			
	SHEET			
1 PL ±.030	mws			
2 PL ±.020	7/12/2024			
3 PL ±.003				
ANGLE ± 1°	.08	1 / 1	PART NO.	REV.
			43000-58HV-8	-

BOM Table

JEA ASY #	DESCRIPTION	ITEM 9	ITEM 10	ITEM 11
43000-VACT-Z	SHELTER VAC TUBE ASY, ZP	CVP-16WT212Z	CVP-AE-2111-Z	CVP-EL-212-10Z
43000-VACT-A	SHELTER VAC TUBE ASY, ALUM	CVP-16ST212A	CVP-AE-2111-A	CVP-EL-212-10A
43000-VACT-S	SHELTER VAC TUBE ASY, SS	CVP-16WT212S	CVP-AE-2111-S	CVP-EL-212-10S

NOTES:

1. USE APPROPRIATE ADHESIVE TO GLUE JOINTS TOGETHER FOR VARIOUS METALS.

BILL OF MATERIALS

ITEM	PART NUMBER	DESCRIPTION	QTY
1	2083-3	2" INLET VALVE W/COVER	1
2	2091	2" SWIVEL CUFF BLACK	1
3	5601D7	1/4-20 x 1 HHCS-SS	3
4	5603D2	1/4-20 NYLOCK NUT, SS	3
5	5606D6	1/4" FLAT WASHER	3
6	8085	CABLE TIE, 15", 120LLB	6
7	8546-1	CLAMP, HOSE, SS, 1 3/4"-2 3/4"	3
8	42000-10-2	BRKT, SHELTER, ROOF VAC PIPE SUPRT	3
9	CVP-16_T212__	TUBE, __, 16 GA, 2.12 DIA, 10 FT	1
10	CVP-AE-2111__	ELBOW, 45 D, 2 IN FNPT X 2.125 ID, __	1
11	CVP-EL-212-10__	ELBOW, 2.12" OD X 16 GA WALL	1

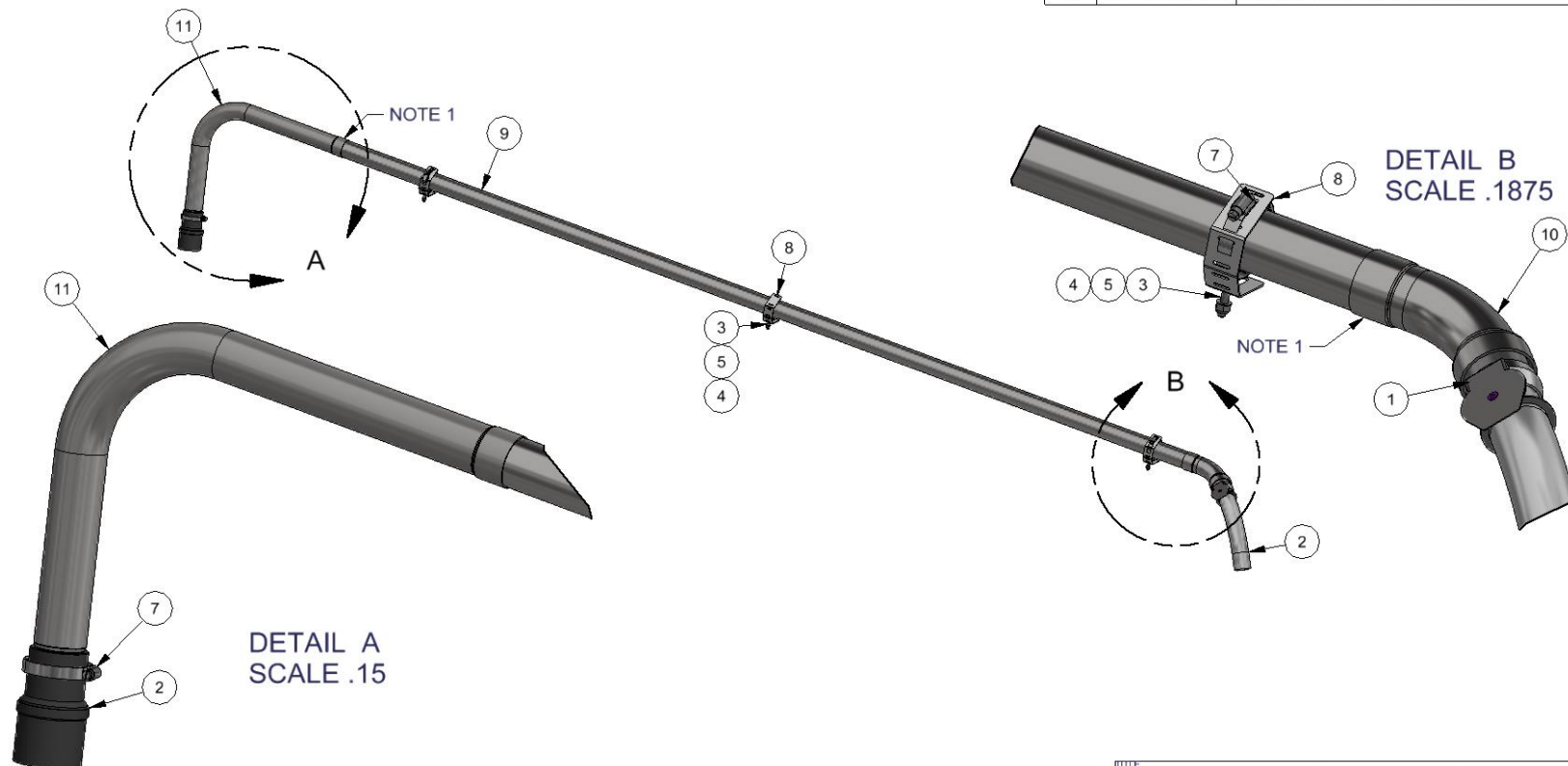

-	9212	RELEASED	7/29/24	MWS
REV	NO.	DESCRIPTION	DATE	BY

THIS DOCUMENT SHALL NOT BE REPRODUCED NOR SHALL THE INFORMATION THEREIN BE USED BY OR DISCLOSED TO OTHERS EXCEPT AS AUTHORIZED BY J.E. ADAMS INDUSTRIES

TITLE SHELTER VAC TUBE ASY, _			
UNSPECIFIED TOLERANCES 1 PL ±.030 2 PL ±.020 3 PL ±.003 ANGLE ±1°	MATERIAL		 CEDAR RAPIDS, IOWA
	DRAWN BY MTWS		
	DATE 7/21/2023		
	SCALE .05	SHEET 1 / 1	
		PART NO 43000-VACT-	REV. -

NOTES:

1. ITEM 9,10, 11 & 15 PVC FITTINGS MUST BE GLUED ONTO PVC PIPE USING SUITABLE ADHESIVE FOR PVC JOINT.

BILL OF MATERIALS

ITEM	PART NUMBER	DESCRIPTION	QTY
1	2083-3	2" INLET VALVE W/COVER	1
2	2083-4W	SINGLE INLET 2" REDUCED WELDMENT	1
3	2086	COUPLER, 2" PIPE - 2" HOSE	1
4	5601D4	1/4-20 x 3/4 HHCS-SS	3
5	5603D2	1/4-20 NYLOCK NUT, SS	3
6	5606D6	1/4" FLAT WASHER	3
7	8061-720-8	3" HOSE CLAMP, STAINLESS STEEL	1
8	8546-1	CLAMP, HOSE, SS, 1 3/4"-2 3/4"	2
9	40000-96	PVC, 2" 45 deg elbow	1
10	40000-98	COUPLER, PVC 2"	1
11	40000-100	FITTING, 2" FNPT X 2" M PIPE, PVC	1
12	42000-10-2	BRKT, SHELTER, ROOF VAC PIPE SUPRT	3
13	8799-990	2" PVC CUT 12.315"	2
14	CVP-2P40L120	PIPE,PVC,SCH 40,2 IN,120 IN L	1
15	CVP-EL-2-90L	ELBOW, PVC, 2" X 90 DEG. LONG	1

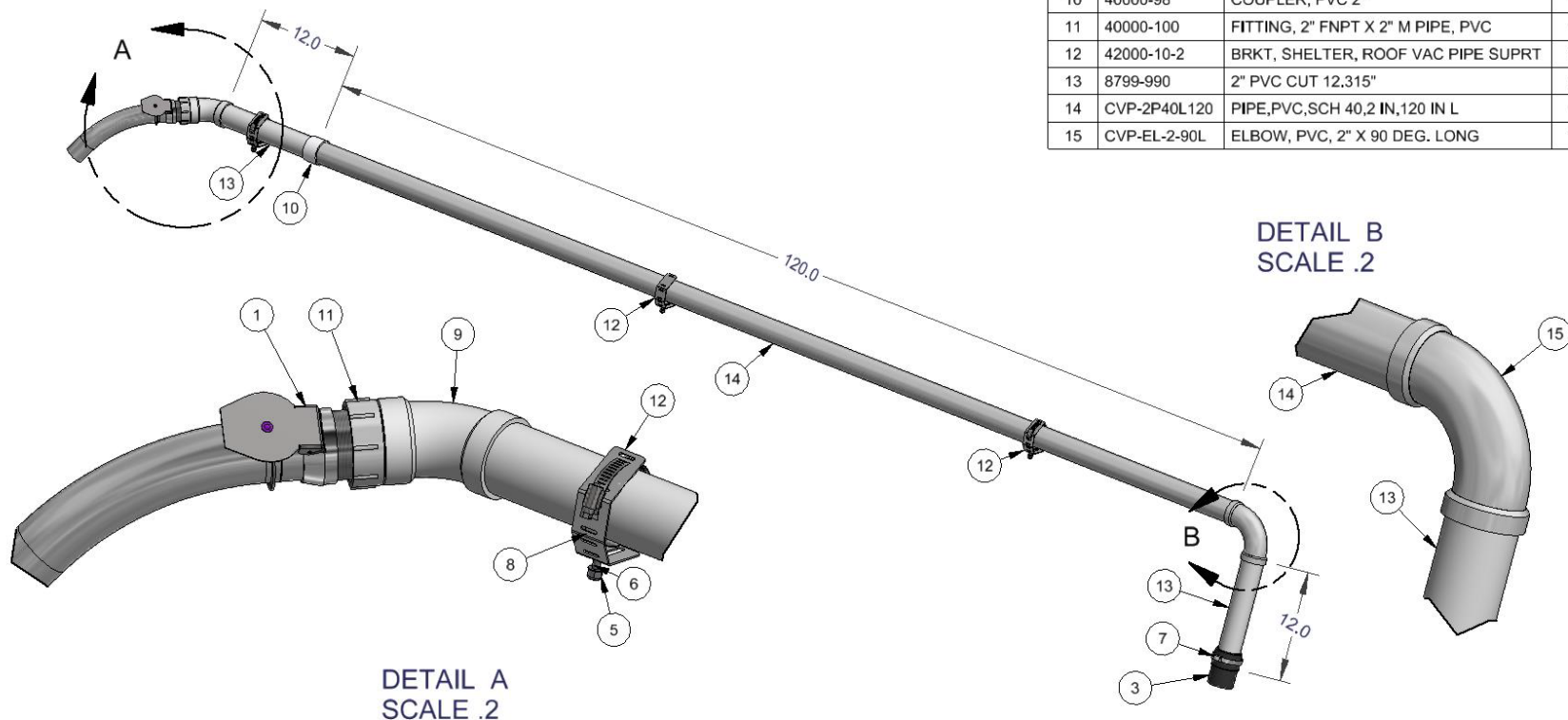

DETAIL A
SCALE .2

DETAIL B
SCALE .2

-	9212	RELEASED	7/29/24	MWS
REV	NO.	DESCRIPTION	DATE	BY

THIS DOCUMENT SHALL NOT BE REPRODUCED NOR SHALL THE INFORMATION THEREIN BE USED BY OR DISCLOSED TO OTHERS EXCEPT AS AUTHORIZED BY J.E. ADAMS INDUSTRIES

TITLE		SHELTER VAC PIPE ASY, PVC	
UNSPECIFIED TOLERANCES	MATERIAL	DATE	7/21/2023
1 PL ±.030	BY	MWS	
2 PL ±.020	DATE	7/21/2023	
3 PL ±.003	SCALE	1 / 1	
ANGLE ± 1°	SHEET	1 / 1	
PART NO.		43000-VACP-A	
REV.		-	

