



## Model – Aqua Breeze Wall Mount Installation

Product Info	Page 2
Important Safety Info	Page 3
Product Dimensions	Page 4
Technical Specifications:	Page 5
Additional Information:	Page 5
Installation:	Page 6-9
Maintenance	Page 10
Troubleshooting	Page 11



# **PRODUCT INFORMATION**

Please take a moment to fill out the information below in order to aid us with any future sales or service inquiries. Model number and serial number information can be found on the serial tag located inside the control box and/or on the lower exterior of the can. Key number can be found on the tag that comes attached to the keys. There may be more than one key number depending on unit.

**Please keep this information with your records.**

**MODEL#:**\_\_\_\_\_

**SERIAL#:**\_\_\_\_\_

**KEY NUMBER(S):**\_\_\_\_\_

**DATE PURCHASED:**\_\_\_\_\_

**DISTRIBUTOR:**\_\_\_\_\_

**J.E. Adams Industries  
1025 63rd Ave. S.W.  
Cedar Rapids, IA 52404  
1-800-553-8861  
[www.jeadams.com](http://www.jeadams.com)**

# IMPORTANT SAFETY INSTRUCTIONS

When using an electrical appliance, basic precautions should always be followed, including the following:

## READ ALL INSTRUCTIONS BEFORE USING (THIS APPLIANCE)

### **WARNING – To reduce the risk of fire, electric shock, or injury:**

- Use only as described in manual. Use only manufactures recommended attachments.
- Do not allow to be used as a toy. Close attention is necessary when used by or near children.
- Do not put any object into openings. Do not use with any opening blocked; keep free of dirt and anything that may reduce flow.
- Keep hair, loose clothing, fingers, and all parts of body away from openings and moving parts.
- Do not use near flammable or combustible liquids, such as gasoline, or use in areas where they may be present.
- Do not use near anything that is burning or smoking, such as cigarettes, matches, or hot ashes.

## SAVE THESE INSTRUCTIONS



- **Installation Instructions:**
- Determine location to mount unit (“**DANGER**” “**THIS EQUIPMENT INCORPORATES PARTS SUCH AS SWITCHES, MOTORS, OR THE LIKE THAT TEND TO PRODUCE ARCS OR SPARKS THAT CAN CAUSE AN EXPLOSION. WHEN LOCATED IN GASOLINE-DISPENSING AND SERVICE STATIONS INSTALL AND USE AT LEAST 20 FEET (6 M) HORIZONTALLY FROM THE EXTERIOR ENCLOSURE OF ANY DISPENSING PUMP AND AT LEAST 18 INCHES (450 MM) ABOVE A DRIVEWAY OR GROUND LEVEL.**”
- **Grounding Instructions:** This appliance must be connected to a grounded metal, permanent wiring system; or an equipment-grounding conductor must be run with the circuit conductors and connected to the equipment-grounding terminal or lead on the appliance.
- All local and national electric codes must be followed for installation and use.

# PRODUCT DIMENSIONS

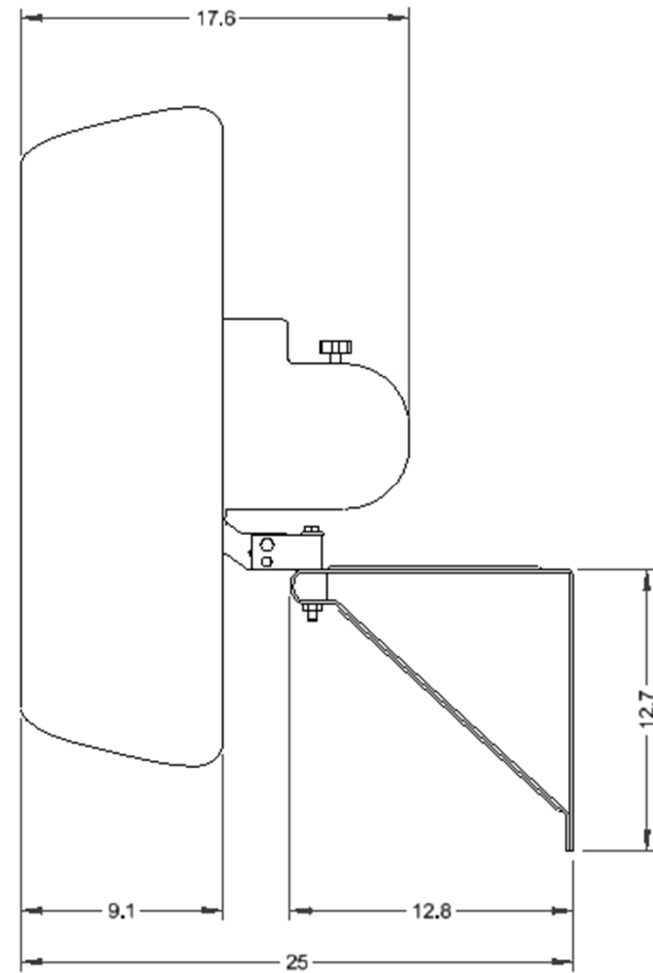
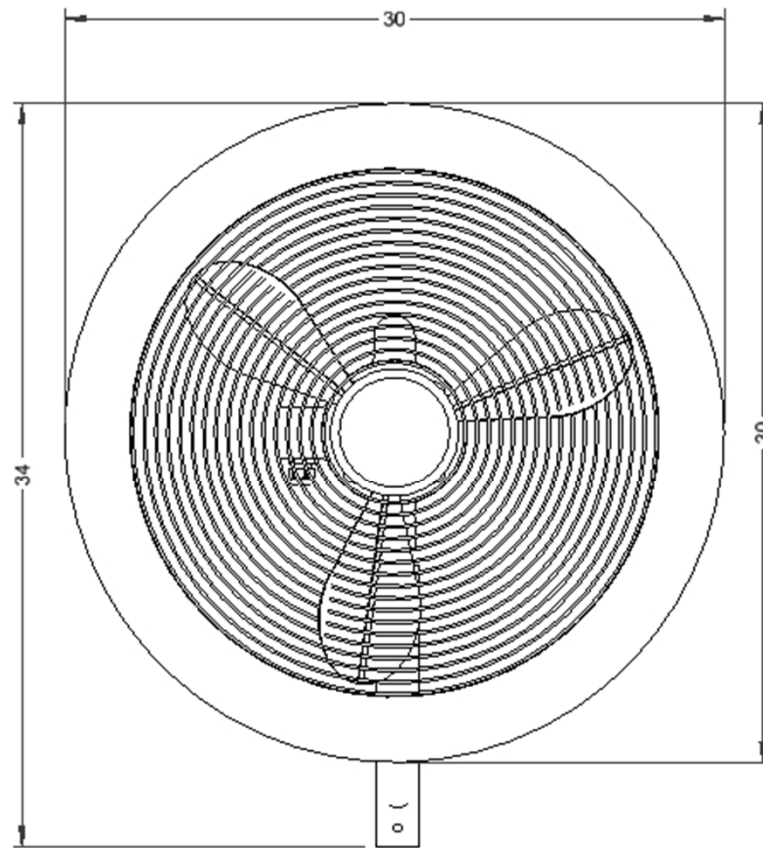

## TECHINCAL SPECIFICATIONS:

### MOTOR

VOLTAGE: 120VAC @ 60HZ

HP: ¼ @ 60HZ

FULL LOAD AMPS: 3.5 @ 115VAC

RPM: 1075 @ 60HZ

PHASE: SINGLE

INSULATION: CLASS B

TURN KNOB CLOCKWISE  
AND TIGHTEN TO  
ENGAGE OSCILATION. IF  
NOT ENGAGED  
OSCILATION WILL NOT  
OCCUR.

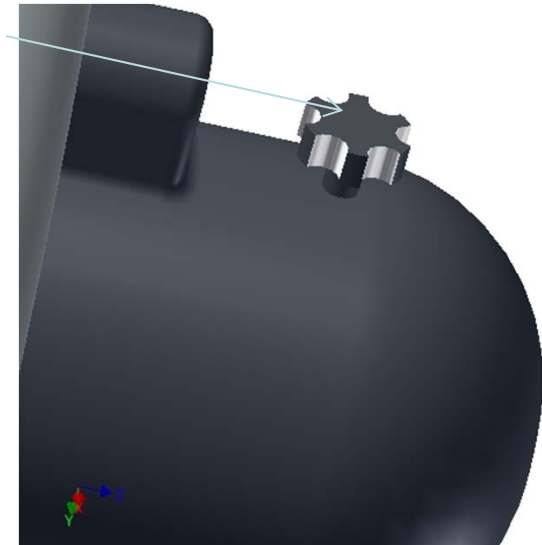

## ADDITIONAL INFO:

OSCILLATION ADJUSTMENT: 0 DEG, 45 DEG, 90 DEG

**NOTE: THE MAIN OSCILATOR SCREW IS LEFT HAND THREAD FOR 90 AND 45 DEG OPERATION. 0 DEG OPERATION IS A RIGHT HAND SCREW. SEE BELOW PICTURES FOR 0, 45 AND 90 DEG SET UP.**

0 DEG OPERATION SCREW.  
MOVE ARM UP TO TOP AND  
PLACE SCREW HERE FOR  
THE OPERATION.

PICTURE SHOWN IS OF 90  
DEG OPERATION



FOR 45 DEG OPERATION REMOVE MAIN SCREW AND  
POSITION BRACKET TO CENTER HOLE. ATTACH  
HARDWARE AS REMOVED.

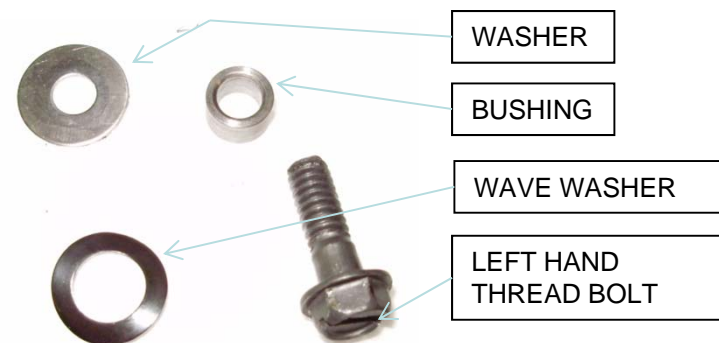

# WALL MOUNT INSTRUCTIONS

## STEP 1:

- LOCATE STUD IN WALL. STUD FINDER IS THE BEST WAY TO DO THIS.
- DETERMINE WHERE THE CENTER OF THE STUD IS AND MARK LOCATION. MOUNT HOLES ARE APPROXIMATELY 5.5" CENTER TO CENTER.
- TOP OF BRACKET HAS TO BE AT LEAST 23" MIN FROM CEILING IN ORDER FOR FAN TO CLEAR.
- ATTACH BRACKET TO WALL USING LAG BOLTS. USE A 5/16" LAG BOLT X 2" LENGTH. **LAG BOLTS NOT SUPPLIED**
- WHEN ATTACHING USE A LEVEL TO MAKE SURE SIDE TO SIDE IS LEVEL. THIS WILL ENSURE THE FAN OSCILATES CORRECTLY.



## WALL MOUNT INSTRUCTIONS

### STEP 2:

- PLACE FAN MOUNT ARM ONTO INSTALLED BRACKET.
- SLIDE THE WASHER ONTO THE 7/16-14UNC HEX HEAD BOLT PROVIDED.
- INSERT THE BOLT INTO TOP OF ARM AND ATTACH USING THE 7/16-14 HEX NUT.
- ONCE ATTACHED USE A SOCKET OR WRENCH AND TIGHTEN.

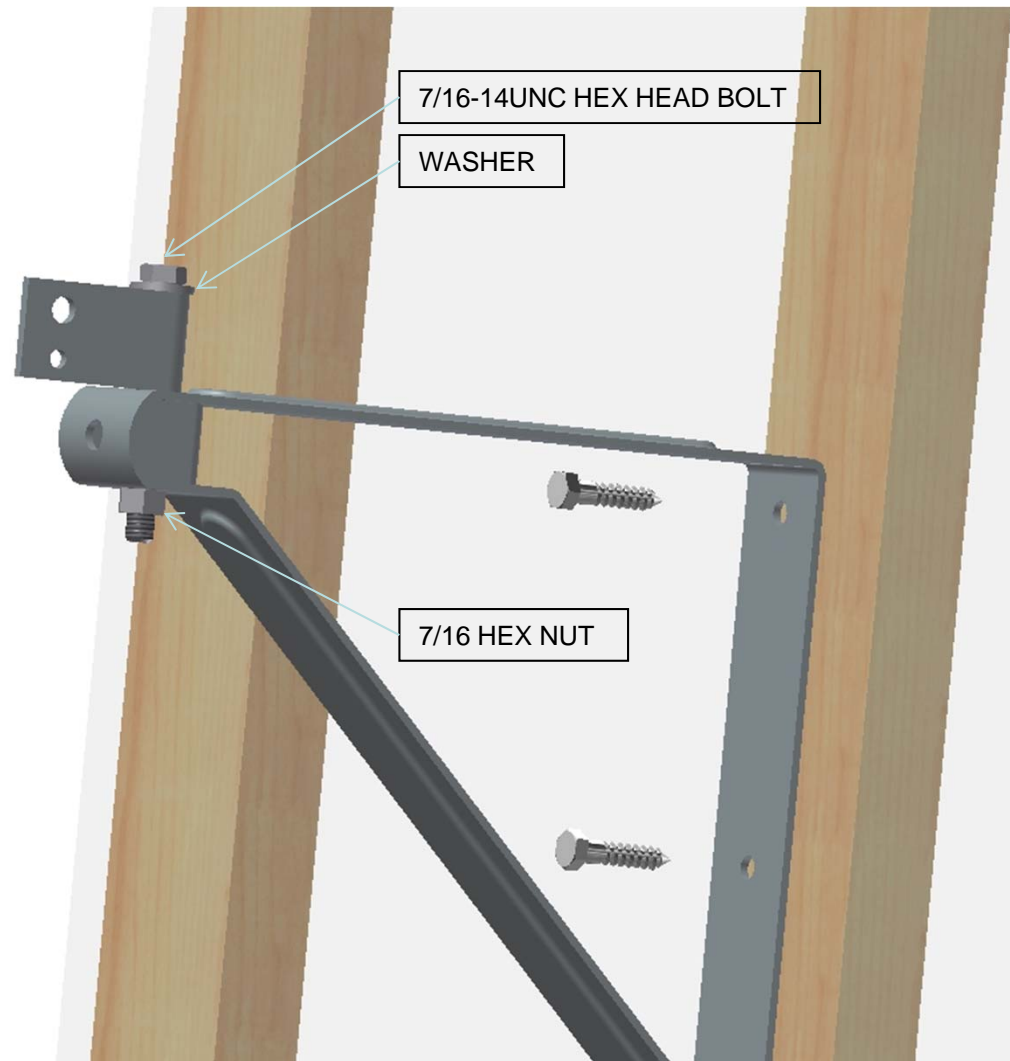

## WALL MOUNT INSTRUCTIONS

### STEP 3:

- USING TWO PEOPLE LIFT FAN ASSEMBLY IN PLACE.
- LINE UP HOLE ON BRACKET WITH HOLE ON BRACKET ARM.
- IN TOP HOLE INSERT 3/8-16 X 1.5" HEX HEAD. ATTACH NUT TO OTHER SIDE AND TIGHTEN.

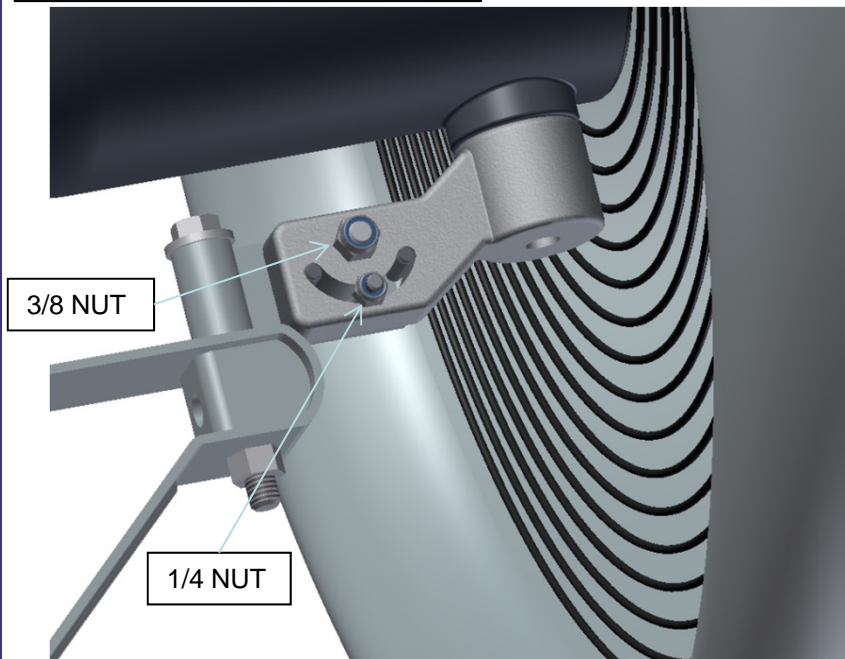

- INSERT 1/4-20 X 1.5" HEX HEAD IN TO BOTTOM HOLE OF BRACKET ARM. ATTACH NUT TO OTHER SIDE.
- BEFORE TIGHTENING COMPLETELY DETERMINE WHAT ANGLE THE FAN IS TO BE PLACED AT. THE FAN BRACKET HAS A HALF MOON SHAPED CUTOUT TO ALLOW THE FAN TO BE TILTED DOWN AT AN ANGLE.
- RE-CHECK AND TIGHTEN ALL BOLTS IF NEEDED.



## WALL MOUNT INSTRUCTIONS

### STEP 4: (OPTIONAL)

- 2 U BOLTS AND A 10FT CABLE ARE SUPPLIED WITH BRACKET ASSEMBLY. THEY CAN BE USED TO SECURE FAN ASSEMBLY TO WALL INCASE BRACKET WOULD FAIL.
- RUN CABLE THRU THE TOP PART OF GRILL ON FAN. LOOP BACK AROUND THRU U BOLT. TIGHTEN IN PLACE.
- RUN CABLE UP TO THE SECOND U BOLT. BE SURE THAT THE CABLE IS NOT TOO LONG THAT IT WILL INTERFERE WITH FAN MOVEMENT AND GET TANGLED BUT NOT SHORT ENOUGH THAT FAN CANNOT OSCILLATE PROPERLY. CUT CABLE TO SIZE.
- ATTACH A LAG EYE BOLT TO WALL THRU STUD. **EYE BOLT NOT SUPPLIED.**
- LOOP WIRE AROUND EYE BOLT AND BACK THRU U BOLT AND TIGHTEN NUTS ON U BOLT.

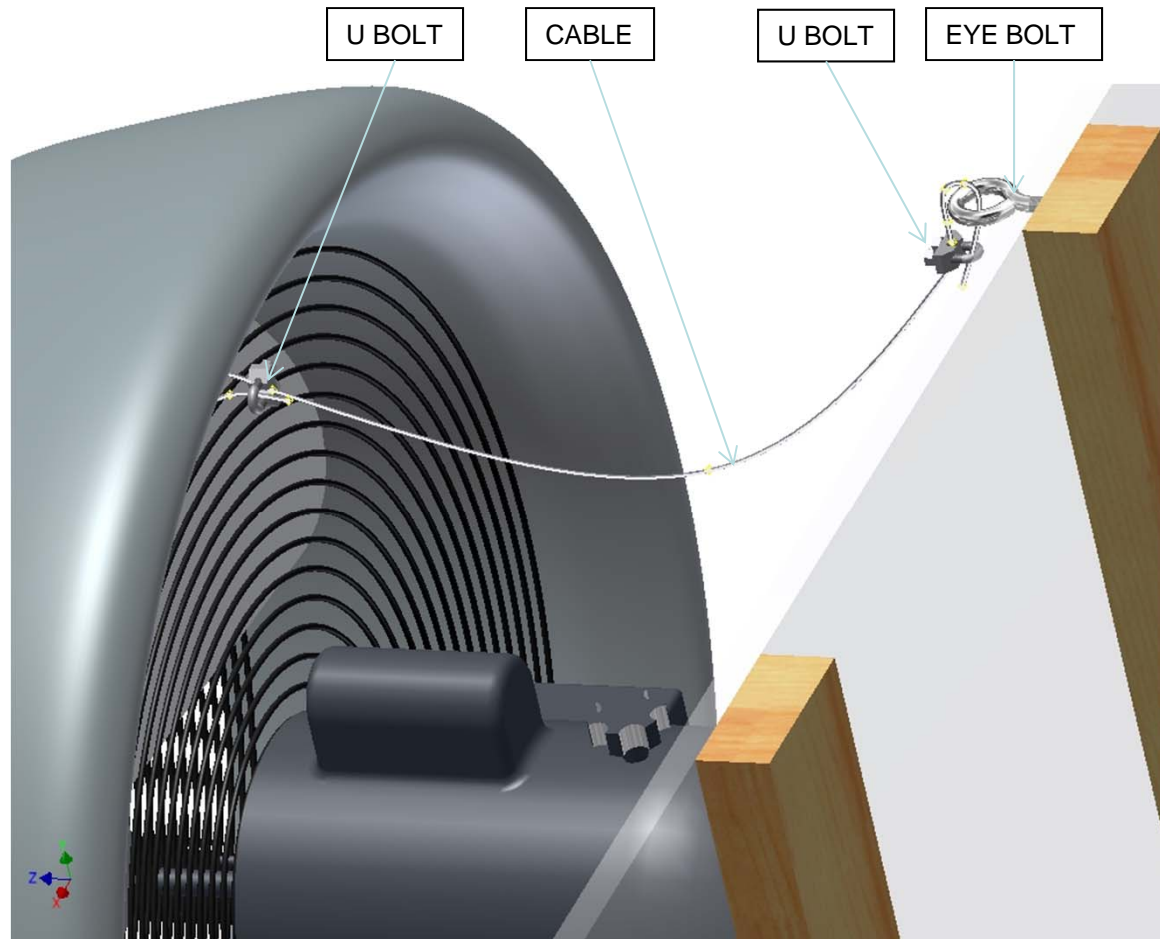

## MAINTENANCE

- Periodically, the fan unit shroud and guards should be cleaned with a mild detergent and wiped completely dry.
- Periodically, check the misting nozzles performance.
  - If the misting cone is deformed or absent, clean the nozzles, using 1 cup of "hot" water, 1 cup of 5% vinegar.
  - Soak nozzles for 10 minutes.
  - Install on unit and run pump immediately to flush out.
  - Compressed air may also work as an alternative.
  - Replace the nozzles if necessary.
- Periodically, check the electrical power cord for abrasions, cracking or other wear. Replace as necessary.
- Periodically, check the high pressure water line for leaks, or other signs of wear. Replace as necessary.

## TROUBLESHOOTING



ALWAYS DISCONNECT POWER BEFORE SERVICING



PROBLEM	POSSIBLE CAUSE	SOLUTION
WATER COMING OUT JUST A FEW NOZZLES	NOZZLES ARE CLOGGED	REMOVE NOZZLES AND SEE MAINTENANCE SECTION. IF THAT DOES NOT SOLVE ISSUE REPLACE
FAN NOT RUNNING BUT PLUGGED IN	NO POWER	CHECK POWER SOURCE AND VERIFY THERE IS VOLTAGE.
	MOTOR IS BAD	IF POWER IS PRESENT AND MOTOR DOES NOT RESPOND, REPLACE MOTOR
FAN WILL NOT OSCILATE	KNOB MAY NOT BE LOCKED IN TO POSTION	VERIFY KNOB IS TURNED ALL THE WAY COUNTER CLOCKWISE
FAN WILL NOT OSCILATE AND HEAR A CLICKING SOUND	KNOB MAY NOT BE LOCKED IN TO POSTION	VERIFY KNOB IS TURNED ALL THE WAY COUNTER CLOCKWISE
	BAD GEAR BOX	IF TURNING KNOB DOES NOT WORK GEAR BOX IS BAD, REPLACE.
FAN IS RUNNING BUT MAKING ABNORMAL NOISES	FAN BLADE BENT?	CHECK FAN BLADE